

**CONDUIT SYSTEMS
FOR ELECTRICAL WIRES
AND CABLES**



**TO
CONNECT
AND
PROTECT**

 **ANAMET CANADA INC.**



CANADIAN MADE
FROM 100% NORTH AMERICAN
RAW MATERIALS

ANAMET is a global company with manufacturing plants in Canada, the United States and Europe. ANAMET has manufactured product for the Canadian electrical industry for the past 35 years.

Located in Eastern Ontario, ANAMET Canada Inc. proudly manufactures over 80% of the product sold in Canada within our own plant.

ANAMET Canada is a high quality manufacturer, meeting the requirements of our customers, while exceeding industry standards.

TABLE OF CONTENTS

NON-JACKETED FLEX SERIES	5
ALUMINUM FLEX CSA	6
ALUMINUM FLEX RWA	7
STEEL FLEX RWS	8
STEEL FLEX DSL	9
STEEL FLEX DE-710 / DE-183	10
STAINLESS STEEL ULTRA-FLEX	11

METALLIC SEALTITE® SERIES	12
SEALTITE® CSA	13
SEALTITE® CW-BLUE	14
SEALTITE® EFST	15
SEALTITE® UA	16
SEALTITE® OR	17
SEALTITE® MTC	18
SEALTITE® HTC	19
SEALTITE® HTUA	20
SEALTITE® HCX	21
SEALTITE® HCSS	22
SEALTITE® XTHF	23
SEALTITE® EFL	24
SEALTITE® ZHUA	25
SEALTITE® HFSS	26
SEALTITE® HFX-VO	27
SEALTITE® SHIELDTITE	28
SEALTITE® NWC	29
SEALTITE® FG	30
SEALTITE® AS	31

SEALTITE® FITTINGS	32
SEALTITE® COMPACT FITTINGS	33
NICKEL PLATED BRASS PREMIUM NPT FITTINGS	33
NICKEL PLATED BRASS PREMIUM METRIC FITTINGS	34
STAINLESS STEEL AISI-304 PREMIUM NPT/METRIC FITTINGS	35
STAINLESS STEEL AISI-304 PREMIUM NPT FITTINGS	36
STAINLESS STEEL AISI-316 PREMIUM NPT FITTINGS	37
STAINLESS STEEL AISI-316 PREMIUM METRIC FITTINGS	38
ZINC-PLATED STEEL FITTINGS (STRAIGHT).....	39
ZINC-PLATED STEEL FITTINGS (ANGLED).....	40

TABLE OF CONTENTS

SEALTITE® LT FITTINGS ZINC DIECAST NPT	41
SS ULTRA FLEX FITTINGS FOR USE WITH SL/UL-CAP	42
CABLE GLANDS	43
SEALTITE® NICKEL PLATED BRASS	43
SEALTITE® STAINLESS STEEL AISI-316	44
SPECIALTY SEALTITE® ATEX FITTINGS	45
NICKEL PLATED BRASS NPT/METRIC FITTINGS	47
STAINLESS STEEL AISI-316 NPT/METRIC FITTINGS	48
NICKEL PLATED BRASS NPT/METRIC SWIVEL ADAPTORS	49
STAINLESS STEEL AISI-316 NPT/METRIC SWIVEL ADAPTORS	50

NON-METALLIC SEALTITE® SERIES 51

SEALTITE® CNP (TYPE A) NON-METALLIC ROBOTIC FLEXIBLE CONDUIT	52
STNM FITTINGS FOR CNP TYPE A CONDUIT (ONLY)	53
SEALTITE® NMUA (TYPE B) NON-METALLIC FLEXIBLE CONDUIT	54
SEALTITE® NMEF (TYPE B) NON-METALLIC FLEXIBLE TUBING	55
NON-METALLIC FITTINGS FOR NMUA/NMEF TYPE B ONLY	56

FIRETECH SERIES 57

FIRETECH SLEEVE	59
FIRETECH BLANKET	60
FIRETECH WRAP	61
FIRETECH TAPE	62
FIRETECH FITTINGS	63
BASALTJACKET.....	64

ANA-QUICK® NYLON SERIES 65

ABOUT ANA-QUICK® PA6 AND PA12 CONDUIT	66
ANA-QUICK® CONDUIT SYSTEM FEATURES	68
ANA-QUICK® CONDUIT SPECIFICATIONS	69
CONDUIT SYSTEM AND ACCESSORIES PART NUMBER SCHEME	70
PA6 CONDUIT - EXTRA FLEXIBLE	71
AC6L - LIGHT WALL	71
AC6S - STANDARD WALL	72
AC6R - MEDIUM WALL	73
PA 12 CONDUITS - EXTRA FLEXIBLE	74
CONDUIT: AC12S - STANDARD	74

TABLE OF CONTENTS

ANA-QUICK® FITTINGS SPECIFICATIONS	75
ANA-QUICK® FITTINGS PART NUMBER SCHEME	76
FITTINGS WITH NPT THREADS	77
FITTINGS WITH METRIC THREADS	78
FITTINGS WITH METRIC METALLIC THREADS	79
FLANGE 90° FITTING	80
SUPPORT WITH LID	81
“T” AND “Y” DISTRIBUTOR	82
LOCK NUTS	83
O-RINGS	84
HOW TO ACHIEVE AN IP68/IP69 RATING	85
APPENDIX	86
CONDUIT CUTTING INSTRUCTIONS	86
CHEMICAL RESISTANCE	87

MANY OF OUR CONDUITS CAN BE SPECIAL ORDERED IN
CUSTOM COLOURS. CONSULT FACTORY FOR DETAILS.



NON-JACKETED FLEX SERIES

ANAMET non-jacketed products are formed from metal strip of aluminum, galvanized steel or stainless steel. They are formed to meet the needs of the industry and, where applicable, meet the required approvals.

These conduits are for applications where protection against the elements is not required, such as inside an enclosure, or for indoor applications. These products are often used in OEM applications on equipment to protect wiring from damage.

ALUM-FLEX SERIES

ALUMINUM FLEX CSA NON-JACKETED FLEXIBLE CONDUIT

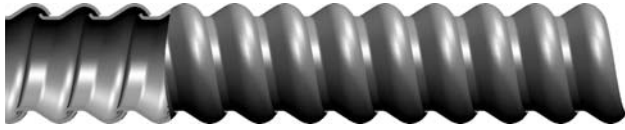

SPECIFICATIONS

- Aluminum strip-wound core
- Temperature: +500°C (+932°F) max.
- CSA Approved #017419

APPLICATIONS

- Commercial and industrial applications where liquid-tight protection is not required

DESCRIPTION

- Non-jacketed aluminum flexible conduit
- Designed for commercial and industrial applications in Canadian market
- Uses standard 'L-16' series connectors
- Available in custom cut lengths



Modified S Profile 5/16" - 4"



Trade Size	Item ID	Std. Pkg. metres	Inside Diameter Min	Outside Diameter Max	Bend Radius	Weight kg/m (lbs/cft)
5/16" (10)	30030	75	7.92 (0.312)	12.59 (0.510)	45 (1.8)	0.088 (6)
	30032	300				
3/8" (12)	30040	75	9.53 (0.375)	15.49 (0.610)	51 (2.0)	0.099 (7)
	30042	300				
7/16" (14)	30050	75	11.10 (0.437)	17.15 (0.675)	57 (2.2)	0.105 (7)
	30052	300				
1/2" (16)	30060	30	15.88 (0.625)	23.37 (0.920)	76 (3.0)	0.245 (16)
	30066	300				
3/4" (21)	30070	30	20.62 (0.812)	28.97 (1.105)	102 (4.0)	0.313 (21)
	30072	150				
	30073	300				
1" (27)	30080	30	25.40 (1.000)	35.05 (1.380)	127 (5.0)	0.481 (32)
	30081	150				
1-1/4" (35)	30090	15	31.75 (1.250)	41.40 (1.630)	159 (6.3)	0.578 (39)
	30092	75				
1-1/2" (41)	30100	15	38.10 (1.500)	49.53 (1.950)	191 (7.5)	0.660 (44)
	30102	45				
2" (53)	30110	15	50.80 (2.000)	62.23 (2.450)	254 (10.0)	0.876 (59)
	30111	30				
2-1/2" (63)	30120	15	63.50 (2.500)	77.72 (3.060)	318 (12.5)	1.180 (79)
3" (78)	30130	15	76.20 (3.000)	90.42 (3.560)	381 (15.0)	1.265 (85)
3-1/2" (91)	30140	15	88.90 (3.500)	103.12 (4.060)	445 (17.5)	1.465 (98)
4" (103)	30150	15	101.60 (4.000)	115.82 (4.560)	508 (20.0)	1.693 (114)

All dimensions in mm (inches) unless stated

ALUM-FLEX SERIES

ALUMINUM FLEX RWA NON-JACKETED FLEXIBLE CONDUIT



SPECIFICATIONS:

- Aluminum strip-wound core, non-jacketed
- Temperature: 500°C (+932°F) max.
- UL Approved #E98045
- 3/8" only is CSA and UL approved

APPLICATIONS

- Commercial and industrial applications where liquid-tight protection is not required and UL approval is needed

DESCRIPTION

- Non-jacketed aluminum flexible conduit
- Designed for commercial and industrial applications in US market
- Uses standard 'L-16' series connectors
- Available in custom cut lengths

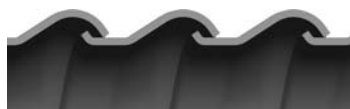

Modified S Profile 3/8" - 4"



Trade Size	Item ID	Std. Pkg. ft	Inside Diameter		Outside Diameter		Bend Radius	Weight kg/m (lbs/cft)
			Min	Max	Min	Max		
3/8" (12)	441503	100	9.52 (0.375)	9.96 (0.393)	14.22 (0.560)	15.49 (0.610)	51 (2.0)	3.0 (7)
	441504	1000						
1/2" (16)	441513	100	15.88 (0.625)	16.38 (0.645)	21.84 (0.860)	23.37 (0.920)	76 (3.0)	4.9 (11)
	441517	1000						
3/4" (21)	441523	100	20.62 (0.812)	21.21 (0.835)	26.54 (1.045)	28.97 (1.105)	102 (4.0)	6.4 (14)
	441526	500						
	441527	1000						
1" (27)	441532	50	25.40 (1.000)	26.42 (1.040)	33.02 (1.300)	35.05 (1.380)	127 (5.0)	10.0 (22)
	441533	300						
	441534	500						
1-1/4" (35)	441542	50	31.75 (1.250)	33.02 (1.300)	39.37 (1.550)	41.40 (1.630)	159 (6.3)	19.0 (42)
1-1/2" (41)	441551	25	38.10 (1.500)	40.01 (1.575)	46.99 (1.850)	49.53 (1.950)	191 (7.5)	21.0 (46)
2" (53)	441561	25	50.80 (2.000)	52.83 (2.080)	59.69 (2.350)	62.23 (2.450)	254 (10.0)	28.0 (62)
2-1/2" (63)	441571	25	63.50 (2.500)	-	72.64 (2.860)	77.72 (3.060)	320 (12.6)	36.0 (80)
3" (78)	441581	25	76.20 (3.000)	-	85.34 (3.360)	90.42 (3.560)	380 (15.0)	42.0 (93)
3-1/2" (91)	441601	25	88.90 (3.500)	-	98.04 (3.860)	103.12 (4.060)	445 (17.5)	52.0 (115)
4" (103)	441591	25	101.60 (4.000)	-	110.74 (4.360)	115.82 (4.560)	510 (20.1)	61.0 (135)

All dimensions in mm (inches) unless stated

STEEL-FLEX SERIES

STEEL FLEX RWS NON-JACKETED FLEXIBLE CONDUIT

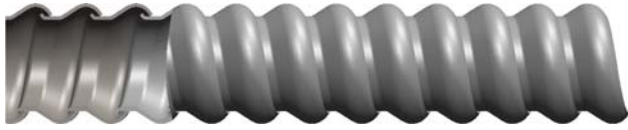

SPECIFICATIONS

- Zinc-coated strip-wound core, non-jacketed
- Temperature: +450°C (+842°F) max.
- UL Approved #E98045

APPLICATIONS

- Commercial and industrial applications where liquid-tight protection is not required and UL approval is needed

DESCRIPTION

- Non-jacketed galvanized steel flexible conduit
- Designed for commercial and industrial applications in US market
- Uses standard 'L-16' series connectors
- Available in custom cut lengths



Modified S Profile 3/8" - 2"



Trade Size	Item ID	Std. Pkg. ft	Inside Diameter		Outside Diameter		Bend Radius	Weight kg/m (lbs/cft)
			Min	Max	Min	Max		
3/8" (12)	455503	100	9.52 (0.375)	9.96 (0.393)	14.22 (0.560)	15.49 (0.610)	51 (2.0)	8.2 (18)
	455506	500						
	455507	1000						
1/2" (16)	455513	100	15.88 (0.625)	16.38 (0.645)	21.84 (0.860)	23.37 (0.920)	76 (3.0)	14.5 (32)
	455526	500						
	455517	1000						
3/4" (21)	455523	100	20.62 (0.812)	21.21 (0.835)	26.54 (1.045)	28.97 (1.105)	105.1 (4.0)	18.5 (41)
	455526	500						
	455527	1000						
1" (27)	455532	50	25.40 (1.000)	26.42 (1.040)	33.02 (1.300)	35.05 (1.380)	127 (5.0)	35.4 (78)
1-1/4" (35)	455542	50	31.75 (1.250)	33.02 (1.300)	39.37 (1.550)	41.40 (1.630)	159 (6.3)	40.8 (90)
1-1/2" (41)	455551	25	38.10 (1.500)	40.01 (1.575)	46.99 (1.850)	49.53 (1.950)	191 (7.5)	52.6 (116)
2" (53)	455561	25	50.80 (2.000)	52.83 (2.080)	59.69 (2.350)	62.23 (2.450)	254 (10.0)	67.1 (148)

All dimensions in mm (inches) unless stated

ULTRA-FLEX SERIES

STEEL FLEX DSL NON-JACKETED EXTRA FLEXIBLE STEEL CONDUIT



SPECIFICATIONS

- Galvanized steel square-lock non-jacketed conduit
- Zinc coated steel provides superior corrosion resistance
- Temperature: +232°C (+450°F) max.
- Exceptional flexibility for tight "U" bend radius

APPLICATIONS

- OEM applications where tight bend radius is required, but no approvals are required

DESCRIPTION

- Ultra flexible galvanized steel conduit
- Designed for OEM applications where high flexibility but no approvals are required
- Installs easily using standard armoured or flexible conduit connectors
- Available in custom cut lengths



Square-Locked Design



Actual ID Size	Description ID	Item ID	Std. Pkg. m (ft)	Inside Diameter Min	Outside Diameter Max	Bend Radius	Weight kg/m (lbs/cft)
3/16"	DSL-3	460012	76 (250)	4.78 (0.188)	6.98 (0.275)	25.5 (1)	0.067 (5)
1/4"	DSL-4	460022	76 (250)	6.35 (0.250)	8.89 (0.350)	25.5 (1)	0.092 (6)
5/16"	DSL-5	460032	76 (250)	7.95 (0.313)	10.97 (0.432)	32 (1.2)	0.105 (7)
	DSL-5	460032-3	914 (3000)				
3/8"	DSL-6	460042	61 (200)	9.53 (0.375)	12.65 (0.498)	38 (1.5)	0.148 (10)
	DSL-6	460042-2	610 (2000)				
7/16"	DSL-7	460052	61 (200)	11.13 (0.438)	14.35 (0.565)	38 (1.5)	0.164 (11)
1/2"	DSL-8	460057	61 (200)	12.70 (0.500)	16.08 (0.633)	38 (1.5)	0.18 (12)
9/16"	DSL-9	460067	61 (200)	14.30 (0.563)	17.78 (0.700)	38 (1.5)	0.213 (14)
5/8"	DSL-10	460072	45 (150)	15.87 (0.625)	19.38 (0.763)	51 (2.0)	0.289 (19)
3/4"	DSL-12	460077	45 (150)	19.05 (0.750)	22.73 (0.895)	51 (2.0)	0.356 (24)

All dimensions in mm (inches) unless stated

ULTRA-FLEX SERIES

STEEL FLEX DE-710 STANDARD FLEXIBLE CONDUIT



DESCRIPTION

- Ultra flexible galvanized steel conduit
- Designed for OEM applications in the office furniture and medical industries
- UL Recognized to DXUZ2.
- Also available in an OVAL version (consult factory)
- Available in custom cut lengths

SPECIFICATIONS

- Galvanized steel square-lock non-jacketed conduit
- Zinc coated steel provides superior corrosion resistance
- Temperature: +450°C (+842°F) max.
- Exceptional flexibility for tight "U" bend radius
- UL Recognized: #E-39679, DXUZ2
- CSA Acceptable. CSA Report No. LO 4000-4158

APPLICATIONS

- OEM applications in office furniture and medical markets



Square-Locked Design

DE-710:



Actual ID Size	Item ID	Std. Pkg. metres	Inside Diameter Min	Outside Diameter		Bend Radius	Weight kg/m (lbs/cft)
				Min	Max		
5/16"	452100	Available in Random Lengths	7.95 (0.313)	11.58 (0.456)	12.22 (0.481)	32 (1.3)	0.164 (11)
3/8"	452105		9.53 (0.375)	13.18 (0.519)	13.82 (0.544)	32 (1.3)	0.18 (12)
7/16"	452110		11.13 (0.438)	14.76 (0.581)	15.39 (0.606)	38 (1.5)	0.198 (13)
1/2"	452115		12.70 (0.500)	16.36 (0.644)	16.99 (0.669)	38 (1.5)	0.225 (15)
* 9/16"	452120		14.30 (0.563)	17.98 (0.708)	18.57 (0.731)	38 (1.5)	0.286 (19)
5/8"	452125		15.87 (0.625)	18.75 (0.738)	19.38 (0.763)	45 (1.8)	0.255 (17)
3/4"	452130		19.05 (0.750)	21.34 (0.840)	22.10 (0.870)	51 (2.0)	0.295 (20)

All dimensions in mm (inches) unless stated

* Old Profile

SS ULTRA-FLEX SERIES

STAINLESS STEEL ULTRA-FLEX SL / UI CAP ULTRA FLEXIBLE STAINLESS STEEL CONDUIT

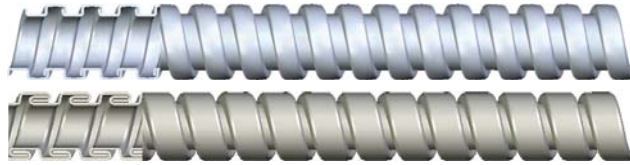

DESCRIPTION

- Flexible Stainless Steel conduit
- Designed for OEM applications where corrosion is an issue and no approvals are required
- SL: Square-locked profile
- UI-Cap: Fully-Interlocked Design
- Available in custom cut lengths

SPECIFICATIONS

- Type 302 stainless steel square-lock (SL) or fully-interlocked (UI-Cap)
- SL Temperature: +232°C (+450°F) max.
- UI Cap Temperature +982°C (+1800°F)

APPLICATIONS

- Applications where corrosion is an issue and where no approvals are required
- Sensor cable protection
- OEM probe cables
- Fibre optics
- Instrumentation
- Temperature measuring devices

SL:



Square-Locked Design



Actual ID Size	Item ID	Std. Pkg. ft	Inside Diameter Min	Outside Diameter		Bend Radius	Weight kg/m (lbs/cft)
				Min	Max		
5/32"	460613	Available in Random Lengths	3.86 (0.152)	5.89 (0.232)	6.20 (0.244)	25.5 (1)	1.59 (107)
3/16"	460616		4.65 (0.183)	6.68 (0.263)	6.98 (0.275)	25.5 (1)	1.82 (122)
7/32"	460619		5.23 (0.206)	7.39 (0.291)	7.77 (0.306)	25.5 (1)	2.10 (141)
1/4"	460622		6.22 (0.245)	8.38 (0.330)	8.76 (0.345)	32 (1.3)	2.50 (168)
9/32"	460626		7.27 (0.286)	9.17 (0.361)	9.55 (0.376)	32 (1.3)	2.72 (183)
5/16"	460628		7.67 (0.302)	10.46 (0.412)	10.85 (0.427)	32 (1.3)	2.95 (198)
3/8"	460634		9.22 (0.363)	12.01 (0.473)	12.52 (0.493)	38 (1.5)	3.41 (229)
1/2"	460643		12.27 (0.483)	15.32 (0.603)	15.82 (0.623)	38 (1.5)	4.54 (305)

All dimensions in mm (inches) unless stated

UI CAP:



Interlocked Design



Actual ID Size	Item ID	Std. Pkg. ft	Inside Diameter Min	Outside Diameter		Bend Radius	Weight kg/m (lbs/cft)
				Min	Max		
5/32"	451550	Available in Random Lengths	4.06 (0.160)	6.48 (0.255)	6.86 (0.270)	32 (1.3)	3.00 (202)
3/16"	451554		4.57 (0.180)	6.98 (0.275)	7.37 (0.290)	32 (1.3)	3.63 (244)
1/4"	451564		6.22 (0.245)	8.64 (0.340)	9.02 (0.355)	32 (1.3)	4.54 (305)
5/16"	451568		7.87 (0.310)	10.29 (0.405)	10.21 (0.420)	32 (1.3)	5.68 (382)
3/8"	451572		9.40 (0.370)	12.32 (0.485)	12.83 (0.505)	32 (1.3)	6.58 (442)
7/16"	451574		10.97 (0.432)	13.89 (0.547)	14.40 (0.567)	63 (2.5)	7.72 (519)
1/2"	451576		12.57 (0.495)	15.49 (0.610)	16.00 (0.630)	63 (2.5)	7.26 (488)

All dimensions in mm (inches) unless stated



METALLIC SEALTITE® SERIES

SEALTITE® flexible conduits are available in a wide variety of materials, diameters, and constructions, with a number of different jackets to meet the needs of your industrial application.

ANAMET has SEALTITE® brand fittings to match the conduits in various materials, depending on what is best for your application. Fittings are available in different threads and in straight and 90°.

SEALTITE® SERIES

SEALTITE® CSA STANDARD FLEXIBLE CONDUIT



DESCRIPTION:

- Flexible metal core liquid-tight conduit
- Available by special order in other colours and custom cut lengths
- Sequentially meter marked for easy cutting and stock control
- Uses standard liquid-tight connectors for easy installation
- Available in custom cut lengths
- New - Approved for direct burial

SPECIFICATIONS:

- Galvanized steel core with liquid-tight PVC jacket
- Colour: black
- Temp. range: -20°C to +75°C (-4°F to + 167°F)
- UV (sunlight) resistant
- Corrosion resistant
- Direct Burial rated
- FT-4 rated
- Sequentially meter marked
- CSA Approved #17419

APPLICATIONS:

- Standard industrial and commercial applications
- Motor hookup

METALLIC
SEALTITE®



Square-Locked Design 3/8" - 2"



Interlocked Design 2-1/2" - 4"



Trade Size	Item ID	Std. Pkg. metres	Inside Diameter		Outside Diameter		Bend Radius	Weight kg/m (lbs/cft)
			Min	Max	Min	Max		
3/8" (12)	10041	30	12.29 (0.484)	17.50 (0.690)	18.00 (0.710)	51 (2.0)	0.35 (24)	
	10044	300						
1/2" (16)	10061	30	15.80 (0.622)	20.80 (0.820)	21.30 (0.840)	76 (3.0)	0.42 (28)	
	10063	150						
	10064	300						
3/4" (21)	10071	30	20.83 (0.820)	26.16 (1.030)	26.67 (1.050)	102 (4.0)	0.55 (37)	
	10073	150						
	10074	300						
1" (27)	10081	30	26.44 (1.041)	32.80 (1.290)	33.40 (1.315)	127 (5.0)	0.80 (54)	
	10083	150						
1-1/4" (35)	10090	15	35.05 (1.380)	41.40 (1.630)	42.20 (1.660)	159 (6.3)	1.13 (76)	
	10091	75						
1-1/2" (41)	10100	15	40.01 (1.575)	47.40 (1.865)	48.30 (1.900)	191 (7.5)	1.45 (97)	
	10101	45						
2" (53)	10111	15	51.31 (2.020)	59.40 (2.340)	60.30 (2.375)	254 (10.0)	1.67 (112)	
	10113	30						
2-1/2" (63)	34075	8	62.99 (2.480)	72.10 (2.840)	73.00 (2.875)	318 (9.5)	2.88 (182)	
	34074	30						
3" (78)	34085	8	77.98 (3.070)	87.90 (3.460)	88.90 (3.500)	381 (15.0)	4.00 (255)	
	34084	30						
4" (103)	34095	8	101.60 (4.000)	113.30 (4.460)	114.30 (4.500)	508 (17.0)	6.00 (362)	
	34094	30						

All dimensions in mm (inches) unless stated

FITTINGS FINDER



PAGE 33-38



PAGE 36



PAGE 41

Made in Canada from 100% North American materials

SEALTITE® SERIES

SEALTITE® CW-BLUE COMPUTER FLEXIBLE CONDUIT

METALLIC
SEALTITE®



DESCRIPTION:

- Flexible metal core liquid-tight conduit
- Metal core wound with integral copper wire for EMI shielding
- Designed for computer applications in the Canadian market
- Also available by special order in other colours
- Sequentially meter marked for easier cutting and stock control
- Uses standard liquid-tight connectors for easy installation
- Available in custom cut lengths

SPECIFICATIONS:

- Galvanized steel core with liquid-tight PVC jacket
- Colour: blue
- Integral copper wire for electromagnetic interference suppression
- Temp. range: -20°C to +75°C (-4°F to + 167°F)
- UV (sunlight) resistant
- Corrosion resistant
- Direct Burial rated
- 1/2" and 3/4" are FT-4 rated
- Sequentially meter marked
- CSA Approved # 17419

APPLICATIONS:

- Computer room wiring to designate computer wiring
- Other applications where additional EMI shielding is required



Square-Locked Design with integral bonding wire 1/2" - 1-1/4"

Interlocked Design 1-1/2" - 2" with no bonding wire



Trade Size	Item ID	Std. Pkg. m (ft)	Inside Diameter Min	Outside Diameter		Bend Radius	Weight kg/m (lbs/cft)
				Min	Max		
1/2" (16)	16061	30 (100)	15.80 (0.622)	20.80 (0.820)	21.30 (0.840)	76 (3.0)	0.42 (28)
	16064	300 (1000)					
3/4" (21)	16071	30 (100)	20.83 (0.820)	26.17 (1.030)	26.67 (1.050)	102 (4.0)	0.55 (37)
	16073	150 (500)					
1" (27)	16074	300 (1000)	26.44 (1.041)	32.80 (1.290)	33.40 (1.315)	163 (6.4)	0.80 (54)
	16081	30 (100)					
1-1/4" (35)	16083	150 (500)	35.05 (1.380)	41.40 (1.630)	42.20 (1.660)	178 (7.0)	1.13 (76)
	16090	15 (50)					
1-1/2" (41)	16092	75 (250)	40.01 (1.575)	47.40 (1.865)	48.30 (1.900)	140 (5.5)	1.45 (97)
	16100	15 (50)					
2" (53)	16104	45 (150)	51.31 (2.020)	59.40 (2.340)	60.30 (2.375)	178 (7.0)	1.67 (112)
	16110	15 (50)					
	16111	30 (100)					

All dimensions in mm (inches) unless stated

FITTINGS FINDER



PAGE 33-38



PAGE 36



PAGE 41

SEALTITE® SERIES

SEALTITE® EFST EXTRA FLEXIBLE CONDUIT



SPECIFICATIONS:

- Galvanized steel core with liquid-tight PVC jacket
- Colour: 1/4" to 5/16" black, 3/8" to 6" grey
- Temp. range: -20°C to +60°C (-4°F to + 140°F)
- UV (sunlight) resistant
- Corrosion resistant

APPLICATIONS:

- Applications where very small ID liquid-tight is required (ie: 1/4")
- Applications where no approvals are required

DESCRIPTION:

- Flexible metal core liquid-tight conduit
- Designed for applications where no approvals are required
- Also available in black by special order
- Uses standard liquid-tight connectors for easy installation
- Available in custom cut lengths



Square-Locked Design with cord packing 5/16" - 1-1/4"

Interlocked Design 1/4" and 1-1/2" - 4"



Trade Size	Item ID	Std. Pkg. m (ft)	Inside Diameter		Outside Diameter		Bend Radius	Weight kg/m (lbs/cft)
			Min	Max	Min	Max		
1/4"	35983	30 (100)	6.22 (0.245)	11.30 (0.445)	11.68 (0.460)	45 (1.8)	0.21 (14)	
	35981	152 (500)						
5/16" (10)	35993	30 (100)	9.91 (0.390)	14.22 (0.560)	14.61 (0.575)	51 (2.0)	0.22 (15)	
	35991	152 (500)						
3/8" (12)	36202	30 (100)	12.32 (0.485)	17.53 (0.690)	18.03 (0.710)	51 (2.0)	0.31 (21)	
1/2" (16)	36212	30 (100)	15.75 (0.620)	20.83 (0.820)	21.34 (0.840)	64 (2.5)	0.37 (25)	
3/4" (21)	36222	30 (100)	20.70 (0.815)	26.16 (1.030)	26.67 (1.050)	76 (3.0)	0.58 (39)	
1" (27)	36231	30 (100)	26.16 (1.030)	32.77 (1.290)	33.40 (1.315)	102 (4.0)	0.76 (51)	
1-1/4" (35)	36241	15 (50)	34.80 (1.370)	41.53 (1.635)	42.16 (1.660)	115 (4.5)	0.98 (66)	
1-1/2" (41)	36251	15 (50)	40.01 (1.575)	47.37 (1.865)	48.26 (1.900)	140 (5.5)	1.55 (104)	
2" (53)	36261	15 (50)	51.31 (2.020)	59.44 (2.340)	60.33 (2.375)	178 (7.0)	2.02 (136)	
2-1/2"	34281	7.6 (25)	62.99 (2.480)	72.14 (2.840)	73.03 (2.875)	241 (9.5)	2.71 (182)	
3"	34201	7.6 (25)	77.98 (3.070)	87.88 (3.460)	88.90 (3.500)	381 (15.0)	3.79 (255)	
3-1/2"	34291	7.6 (25)	88.90 (3.500)	100.58 (3.960)	101.60 (4.000)	407 (16.0)	4.67 (314)	
4"	36351	7.6 (25)	101.60 (4.000)	113.28 (4.460)	114.30 (4.500)	432 (17.0)	5.40 (363)	
5"	36351	7.6 (25)	126.37 (4.975)	139.83 (5.505)	141.35 (5.565)	559 (22.0)	7.94 (534)	
6"	36361	7.6 (25)	152.78 (6.015)	166.75 (6.565)	168.28 (6.625)	762 (30.0)	9.91 (666)	

All dimensions in mm (inches) unless stated

FITTINGS FINDER



PAGE 33-38



PAGE 36



PAGE 41

METALLIC
SEALTITE®

SEALTITE® SERIES

SEALTITE® UA UL & CSA APPROVED FLEXIBLE CONDUIT

METALLIC
SEALTITE®



DESCRIPTION

- Flexible metal core liquid-tight conduit
- Designed for applications at OEMs where UL & CSA approval is required or desirable
- Approved for direct burial applications
- Also available in black by special order
- Uses standard liquid-tight connectors for easy installation
- CSA heavy duty rating pending

SPECIFICATIONS:

- Galvanized steel core with liquid-tight PVC jacket
- Colour: 3/8" to 2" grey, 2-1/2" to 4" black
- Temp. range: -20°C to +60°C (-4°F to + 140°F)
- UV (sunlight) resistant
- Corrosion resistant
- CSA Approved #LL15275
- UL Approved #E18917

APPLICATIONS:

- Applications where CSA and UL approvals are required



Square-Locked Design with integral bonding wire 3/8" - 1-1/4"

Interlocked Design 1-1/2" - 4" with no bonding wire



Trade Size	Item ID	Std. Pkg. m (ft)	Inside Diameter	Outside Diameter		Bend Radius	Weight Kg/M (lbs/cft)
			Min	Min	Max		
3/8" (12)	34202	30 (100)	12.29 (0.484)	17.53 (0.690)	18.00 (0.710)	76 (3.0)	0.37 (25)
1/2" (16)	34212	30 (100)	15.80 (0.622)	20.88 (0.822)	21.30 (0.840)	89 (3.5)	0.43 (29)
1/2" (16)	34213	305 (1000)					
3/4" (21)	34222	30 (100)	20.83 (0.820)	26.16 (1.030)	26.67 (1.050)	127 (5.0)	0.65 (44)
	34228	152 (500)					
1" (27)	34231	30 (100)	26.44 (1.041)	32.77 (1.290)	33.40 (1.315)	159 (6.3)	1.09 (73)
	34238	122 (400)					
1-1/4" (35)	34241	15 (50)	35.05 (1.380)	41.40 (1.630)	42.20 (1.660)	178 (7.0)	1.49 (100)
	34248	76 (250)					
1-1/2" (41)	34251	15 (100)	40.01 (1.575)	47.37 (1.865)	48.30 (1.900)	140 (5.5)	1.71 (112)
	34254	45 (150)					
2" (53)	34261	15 (50)	51.31 (2.020)	59.44 (2.340)	60.30 (2.375)	178 (7.0)	2.20 (148)
	34268	30 (100)					
2-1/2" (63)	34075	8 (27)	62.99 (2.480)	72.14 (2.840)	73.00 (2.875)	318 (9.5)	2.70 (182)
3" (78)	34085	8 (27)	77.98 (3.070)	87.88 (3.460)	88.90 (3.500)	381 (15.0)	3.79 (255)
4" (103)	34095	8 (27)	101.60 (4.000)	113.28 (4.460)	114.30 (4.500)	508 (17.0)	5.39 (362)

All dimensions in mm (inches) unless stated

FITTINGS FINDER



PAGE 33-38



PAGE 36



PAGE 41

SEALTITE® SERIES

SEALTITE® OR OIL-RESISTANT FLEXIBLE CONDUIT



DESCRIPTION:

- Flexible metal core liquid-tight conduit
- Designed for applications that need superior resistance to petroleum, synthetic oils and chemical degradation
- Uses standard liquid-tight connectors for easy installation

SPECIFICATIONS

- Galvanized steel core with liquid-tight PVC jacket
- Colour: black
- Temp. range: -23°C to +105°C (-9°F to + 221°F)
- UV (sunlight) resistant
- Corrosion resistant
- Extra oil resistant

APPLICATIONS

- Extreme resistance to oil
- Petrochemical and steel industries
- Applications where no approvals are required

METALLIC
SEALTITE®



Square-Locked Design with cord packing 3/8" - 1-1/4"

Interlocked Design 1-1/2" - 2"



Trade Size	Item ID	Std. Pkg. m (ft)	Inside Diameter Min	Outside Diameter		Bend Radius	Weight kg/m (lbs/cft)
				Min	Max		
3/8" (12)	36602	30 (100)	12.32 (0.485)	17.53 (0.690)	18.03 (0.710)	51 (2.0)	0.31 (21)
1/2" (16)	36612	30 (100)	15.75 (0.620)	20.83 (0.820)	21.34 (0.840)	64 (2.5)	0.37 (25)
3/4" (21)	36622	30 (100)	20.70 (0.815)	26.16 (1.030)	26.67 (1.050)	76 (3.0)	0.58 (39)
1" (27)	36631	30 (100)	26.16 (1.030)	32.77 (1.290)	33.40 (1.315)	102 (4.0)	0.76 (51)
1-1/4" (35)	36641	15 (50)	34.80 (1.370)	41.53 (1.635)	42.16 (1.660)	115 (4.5)	0.98 (66)
1-1/2" (41)	36651	15 (50)	40.01 (1.575)	47.37 (1.865)	48.26 (1.900)	140 (5.5)	1.55 (104)
2" (53)	36661	15 (50)	51.31 (2.020)	59.44 (2.340)	60.33 (2.375)	178 (7.0)	2.02 (136)

All dimensions in mm (inches) unless stated

FITTINGS FINDER



PAGE 33-38



PAGE 36



PAGE 41

SEALTITE® SERIES

SEALTITE® MTC MACHINE TOOL EXTRA FLEXIBLE CONDUIT

METALLIC
SEALTITE®



SPECIFICATIONS

- Galvanized steel core with liquid-tight PVC jacket
- Colour: black
- Temp. range: -20°C to +60°C (-4°F to + 140°F)
- UV (sunlight) resistant
- Corrosion resistant
- Tight bend radius

APPLICATIONS

- High flexibility
- Machine tool industry

DESCRIPTION

- Flexible metal core liquid-tight conduit
- Designed for Machine Tool industry for high flexibility
- Very tight bend radius makes wiring machine tools easier
- Uses standard liquid-tight connectors for easy installation



Square-Locked Design
3/8" - 2"



Trade Size	Item ID	Std. Pkg. m (ft)	Inside Diameter Min	Outside Diameter		Bend Radius	Weight kg/m (lbs/cft)
				Min	Max		
3/8" (12)	38302	30 (100)	12.29 (0.484)	17.25 (0.679)	17.88 (0.704)	38 (1.5)	0.24 (16)
	38304	244 (800)					
1/2" (16)	38312	30 (100)	15.80 (0.622)	20.78 (0.818)	21.41 (0.843)	51 (2.0)	0.30 (20)
	38314	152 (500)					
3/4" (21)	38322	30 (100)	20.83 (0.820)	25.63 (1.009)	26.26 (1.034)	64 (2.5)	0.36 (24)
	38328	152 (500)					
1" (27)	38331	30 (100)	26.44 (1.041)	31.19 (1.228)	31.95 (1.258)	76 (3.0)	0.45 (30)
	38338	122 (400)					
1-1/4" (35)	38341	15 (50)	35.05 (1.380)	39.75 (1.565)	40.51 (1.595)	89 (3.5)	0.60 (40)
	38348	76 (250)					
1-1/2" (41)	38351	15 (50)	40.01 (1.575)	46.48 (1.830)	47.24 (1.860)	102 (4.0)	1.04 (70)
	38354	46 (150)					
2" (53)	38361	15 (50)	51.31 (2.020)	57.66 (2.270)	58.42 (2.300)	127 (5.0)	1.29 (87)
	38638	30 (100)					

All dimensions in mm (inches) unless stated

FITTINGS FINDER



PAGE 33-38



PAGE 36



PAGE 41

HIGH-TEMP SERIES

SEALTITE® HTC HIGH TEMPERATURE FLEXIBLE CONDUIT



DESCRIPTION

- Flexible metal core liquid-tight conduit
- Designed for applications where high temperature is required
- Also available by special order in other colours (consult factory)
- Sequentially meter marked for easy cutting and stock control
- Uses standard liquid-tight connectors for easy installation
- Available in custom cut lengths

SPECIFICATIONS

- Galvanized steel core with liquid-tight PVC jacket
- Colour: black
- Temp. range: -20°C to +105°C (-4°F to + 221°F)
- UV (sunlight) resistant
- Corrosion resistant
- Sequentially meter marked
- CSA Approved #17419

APPLICATIONS

- Applications for high temperature
- Steel and petrochemical industries



Square-Locked Design
3/8" - 2"



Trade Size	Item ID	Std. Pkg. metres	Inside Diameter Min	Outside Diameter		Bend Radius	Weight kg/m (lbs/cft)
				Min	Max		
3/8" (12)	14041	30	12.29 (0.484)	17.5 (0.690)	18.00 (0.710)	51 (2.0)	0.33 (22)
1/2" (16)	14061	30	15.80 (0.622)	20.80 (0.820)	21.30 (0.840)	76 (3.0)	0.40 (27)
	14062	150					
	14063	300					
3/4" (21)	14071	30	20.83 (0.820)	26.17 (1.030)	26.67 (1.050)	102 (4.0)	0.53 (36)
	14072	150					
	14072	300					
1" (27)	14081	30	26.44 (1.041)	32.80 (1.290)	33.40 (1.315)	127 (5.0)	0.73 (49)
	14083	150					
1-1/4" (35)	14090	15	35.05 (1.380)	41.40 (1.630)	42.20 (1.660)	159 (6.7)	1.07 (72)
1-1/2" (41)	14100	15	40.01 (1.575)	47.40 (1.865)	48.30 (1.900)	191 (7.5)	1.33 (89)
2" (53)	14112	15	51.31 (2.020)	59.40 (2.340)	60.30 (2.375)	254 (10.0)	1.67 (112)

All dimensions in mm (inches) unless stated

FITTINGS FINDER



PAGE 33-38



PAGE 36



PAGE 41

Made in Canada from 100% North American materials

HIGH-TEMP SERIES

SEALTITE® HTUA CSA/UL HIGH TEMPERATURE FLEXIBLE CONDUIT

METALLIC
SEALTITE®



DESCRIPTION

- Flexible metal core liquid-tight conduit
- Designed for applications where a higher temperature range with UL approval is required or desired
- Approved for direct burial applications up to 4"
- Also available in black by special order
- Uses standard liquid-tight connectors for easy installation

SPECIFICATIONS

- Galvanized steel core with liquid-tight PVC jacket
- Colour: grey
- Temp. range: -46°C to +105°C (-51°F to + 221°F)
CSA max +75°C (+167°F)
- UV (sunlight) resistant
- Corrosion resistant
- CSA Approved #LL15275
- UL Approved #E18917

APPLICATIONS

- Applications for high and low temperature where UL and CSA approvals are required
- Steel and petrochemicals industries

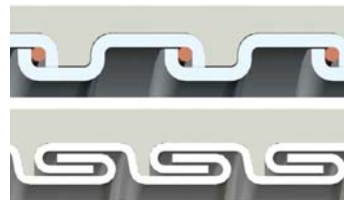

Square-Locked Design with
integral bonding wire 3/8"
- 1-1/4"

Interlocked Design 1-1/2" -
4" with no bonding wire



Trade Size	Item ID	Std. Pkg. m (ft)	Inside Diameter Min	Outside Diameter		Bend Radius	Weight kg/m (lbs/cft)
				Min	Max		
3/8" (12)	37402	30 (100)	12.29 (0.484)	17.50 (0.690)	18.00 (0.710)	76 (3.0)	0.36 (24)
	37404	244 (800)					
1/2" (16)	37412	30 (100)	15.80 (0.622)	20.80 (0.820)	21.30 (0.840)	89 (3.5)	0.43 (29)
	37414	152 (500)					
3/4" (21)	37422	30 (100)	20.83 (0.820)	26.17 (1.030)	26.67 (1.050)	127 (5.0)	0.64 (43)
	37428	152 (100)					
1" (27)	37431	30 (100)	26.44 (1.041)	32.80 (1.290)	33.40 (1.315)	153 (6.0)	1.09 (73)
	37438	122 (400)					
1-1/4" (35)	37441	15 (50)	35.05 (1.380)	41.40 (1.630)	42.20 (1.660)	178 (7.0)	1.49 (100)
	37448	76 (250)					
1-1/2" (41)	37451	15 (50)	40.01 (1.575)	47.40 (1.865)	48.30 (1.900)	140 (5.5)	1.67 (112)
	37454	46 (150)					
2" (53)	37461	15 (50)	51.31 (2.020)	59.40 (2.340)	60.30 (2.375)	178 (7.0)	2.20 (148)
	37468	30 (100)					
2-1/2" (63)	37471	15 (100)	62.99 (2.480)	72.10 (2.840)	73.00 (2.875)	242 (9.5)	2.69 (181)
3" (78)	37481	7.6 (25)	77.98 (3.070)	87.90 (3.460)	88.90 (3.500)	381 (15.0)	3.79 (255)
4" (103)	37491	7.6 (25)	101.60 (4.000)	113.30 (4.460)	114.30 (4.500)	432 (17.0)	5.37 (361)

All dimensions in mm (inches) unless stated

FITTINGS FINDER



PAGE 33-38



PAGE 36

HIGH-TEMP SERIES

SEALTITE® HCX EXTREME TEMPERATURE FLEXIBLE CONDUIT



DESCRIPTION

- Flexible metal core liquid-tight conduit
- Designed for extreme temperature applications where superior resistance to temperature ranges is required. (-60°C to +150°C)
- Available standard in black
- Uses standard liquid-tight connectors for easy installation

SPECIFICATIONS

- Galvanized steel core with liquid-tight TPE jacket
- Colour: black
- Temp. range: -60°C to +150°C (-60°F to +150°F)
- UV (sunlight) resistant
- Extra corrosion resistant
- Oil resistant

APPLICATIONS

- Extreme duty applications
- Extreme high or low temperature requirements
- Applications where no approvals are required

METALLIC
SEALTITE®

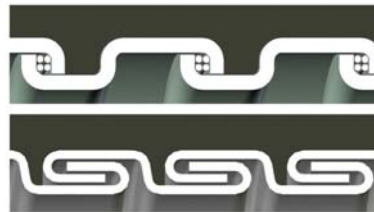

Square-Locked Design with
cord packing 3/8" - 1-1/4"

Interlocked Design 1-1/2"
- 2"



Trade Size	Item ID	Std. Pkg. m (ft)	Inside Diameter Min	Outside Diameter		Bend Radius	Weight kg/m (lbs/cft)
				Min	Max		
3/8" (12)	39102	30 (100)	12.32 (0.485)	17.53 (0.690)	18.03 (0.710)	51 (2.0)	0.31 (21)
1/2" (16)	39112	30 (100)	15.75 (0.620)	20.83 (0.820)	21.34 (0.840)	64 (2.5)	0.37 (25)
3/4" (21)	39122	30 (100)	20.70 (0.815)	26.16 (1.030)	26.67 (1.050)	76 (3.0)	0.58 (39)
1" (27)	39131	30 (100)	26.16 (1.030)	32.77 (1.290)	33.40 (1.315)	102 (4.0)	0.76 (51)
1-1/4" (35)	39141	15 (50)	34.80 (1.370)	41.53 (1.635)	42.16 (1.660)	115 (4.5)	0.98 (66)
1-1/2" (41)	39151	15 (50)	40.01 (1.575)	47.37 (1.865)	48.26 (1.900)	140 (5.5)	1.55 (104)
2" (53)	39161	15 (50)	51.31 (2.020)	59.44 (2.340)	60.33 (2.375)	176 (7.0)	2.02 (136)

All dimensions in mm (inches) unless stated

FITTINGS FINDER



PAGE 33-38



PAGE 36

HIGH-TEMP SERIES

SEALTITE® HCSS: HOT AND COLD TEMPERATURE 316 STAINLESS STEEL CONDUIT



DESCRIPTION

- Constructed of continuously interlocked 316 stainless steel core for exceptional crush and corrosion resistance.
- Durable, sunlight resistant thermoplastic PVC jacket that resists heat, oil and chemical breakdown. IP 66/67 Rated when installed with approved fittings.
- Also available in black by special order
- Uses standard liquid-tight connectors for easy installation

SPECIFICATIONS

- 316 stainless steel core with liquid-tight PVC jacket
- Colour: grey or black
- Temp. range: -51°F to +221°F (-46°C to +105°C)
- UV (sunlight) resistant
- Corrosion resistant

APPLICATIONS

- Applications of high and low temperature where a high level of corrosion resistance is required
- Superior wiring protection for petrochemical and offshore industries



Square-Locked Design with
cord packing 3/8" - 1-1/4"

Interlocked Design 1-1/2" - 2"



Trade Size	Item ID	Std. Pkg. m (ft)	Inside Diameter Min	Outside Diameter		Bend Radius	Weight kg/m (lbs/cft)
				Min	Max		
3/8" (12)	47202	30 (100)	12.29 (0.484)	17.50 (0.690)	18.00 (0.710)	26 (2.0)	0.36 (21)
	47208	152 (500)					
1/2" (16)	47212	30 (100)	15.80 (0.622)	20.80 (0.820)	21.30 (0.840)	32 (2.5)	0.43 (25)
	47214	152 (500)					
3/4" (21)	47222	30 (100)	20.83 (0.820)	26.17 (1.030)	26.67 (1.050)	38 (3.0)	0.64 (39)
	47228	152 (500)					
1" (27)	47231	30 (100)	26.44 (1.041)	32.80 (1.290)	33.40 (1.315)	51 (4.0)	1.09 (51)
	47238	122 (400)					
1-1/4" (35)	47241	15 (50)	35.05 (1.380)	41.40 (1.630)	42.20 (1.660)	57 (4.5)	1.49 (66)
	47248	76 (250)					
1-1/2" (41)	47251	15 (50)	40.01 (1.575)	47.40 (1.865)	48.30 (1.900)	70 (5.5)	1.67 (104)
	47254	46 (150)					
2" (53)	47261	15 (50)	51.31 (2.020)	59.40 (2.340)	60.30 (2.375)	89 (7.0)	2.20 (136)
	47268	30 (100)					

All dimensions in mm (inches) unless stated

FITTINGS FINDER



PAGE 33-38



PAGE 36

HIGH-TEMP SERIES

SEALTITE® XTHF LOW TEMPERATURE FLEXIBLE CONDUIT



DESCRIPTION

- Flexible metal core liquid-tight conduit
- Uses standard liquid-tight connectors for easy installation
- Rated for temperature range of -70°C to +200°C (-94°F to +392°F) and incursions up to 260°C (500°F) Can be used in applications that do not require approvals
- Exceptional crush and corrosion resistance
- Durable, sunlight resistant, flame retardant, low smoke and zero halogen silicone jacket that resists heat, oil and corrosive chemical breakdown.

SPECIFICATIONS

- Hot dipped zinc galvanized steel core with silicone jacket
- Colour: grey
- Temp. range: -70°C to +200°C (-94°F to +392°F)
- UV (sunlight) resistant. flame retardant, halogen free

APPLICATIONS

- Designed for the most extreme temperature applications
- Silicone jacket has superior resistance to chemical breakdown



Square-Locked Design with integral bonding wire 1/2" - 1"



Trade Size	Item ID	Std. Pkg. m (ft)	Inside Diameter Min	Outside Diameter		Bend Radius	Weight kg/m (lbs/cft)
				Min	Max		
1/2" (16)	34712	30 (100)	15.80 (0.622)	20.88 (0.822)	21.34 (0.840)	45 (3.5)	0.45 (30)
3/4" (21)	34722	30 (100)	20.83 (0.820)	26.16 (1.030)	26.67 (1.050)	64 (5.0)	0.65 (43)
1" (27)	34731	30 (100)	26.44 (1.041)	32.77 (1.290)	33.40 (1.315)	76 (6.0)	1.05 (71)

All dimensions in mm (inches) unless stated

FITTINGS FINDER



PAGE 33-38



PAGE 36

SEALTITE® SERIES

SEALTITE® EFL ALUMINUM CORE FLEXIBLE CONDUIT



DESCRIPTION

- Flexible aluminum core liquid-tight conduit
- Designed for applications where weight is a major concern, such as the transportation industry
- Lightweight
- Uses standard liquid-tight connectors for easy installation

SPECIFICATIONS

- Aluminum core with liquid-tight PVC jacket
- Colour: grey
- Temp. range: -20°C to +60°C (-4°F to + 140°F)
- UV (sunlight) resistant
- Corrosion resistant

APPLICATIONS

- Applications where weight is a concern
- Rail cars and locomotives
- Transport trucks/trailers
- Applications where no approvals are required

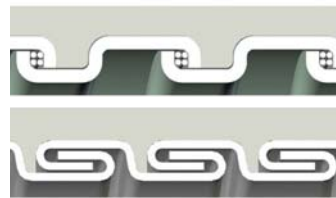

Square-Locked Design with cord packing 3/8" - 1-1/4"

Interlocked Design 1-1/2" - 4"



Trade Size	Item ID	Std. Pkg. m (ft)	Inside Diameter Min	Outside Diameter		Bend Radius	Weight kg/m (lbs/cft)
				Min	Max		
3/8" (12)	38002	30 (100)	12.32 (0.485)	17.53 (0.690)	18.03 (0.710)	51 (2.0)	0.21 (14)
1/2" (16)	38012	30 (100)	15.75 (0.620)	20.83 (0.820)	21.34 (0.840)	64 (2.5)	0.24 (16)
3/4" (21)	38022	30 (100)	20.70 (0.815)	26.16 (1.030)	26.67 (1.050)	76 (3.0)	0.28 (19)
1" (27)	38031	30 (100)	26.16 (1.030)	32.77 (1.290)	33.40 (1.315)	102 (4.0)	0.48 (32)
1-1/4" (35)	38041	15 (50)	34.80 (1.370)	41.53 (1.635)	42.16 (1.660)	115 (4.5)	0.63 (42)
1-1/2" (41)	38051	15 (50)	40.01 (1.575)	47.37 (1.865)	48.26 (1.900)	140 (5.5)	0.86 (58)
2" (53)	38061	15 (50)	51.31 (2.020)	59.44 (2.340)	60.33 (2.375)	178 (7.0)	1.16 (78)
2-1/2" (63)	38071	15 (50)	62.99 (2.480)	72.10 (2.840)	73.00 (2.875)	318 (9.5)	1.53 (103)
3" (78)	38081	7.6 (25)	77.98 (3.070)	87.90 (3.460)	88.90 (3.500)	381 (15.0)	1.83 (123)
4" (103)	38091	7.6 (25)	101.60 (4.000)	113.30 (4.460)	114.30 (4.500)	508 (17.0)	2.92 (196)

All dimensions in mm (inches) unless stated

FITTINGS FINDER



PAGE 33-38



PAGE 36

SEALTITE® SERIES

SEALTITE® ZHUA ZERO HALOGEN/LOW SMOKE FLEXIBLE CONDUIT



DESCRIPTION

- Flexible metal core liquid-tight conduit
- Special Polyurethane jacket providing maximum protection from toxic gases, smoke density, carbon monoxide levels and HCL levels. Halogen free, flame retardant and low smoke
- Resists heat, oil and chemical breakdown
- Designed for commercial applications where Zero Halogen and Low Smoke standards are required
- Uses standard liquid-tight connectors for easy installation

SPECIFICATIONS

- Galvanized steel core with liquid-tight TPU jacket
- Colour: black
- Temp. range: -40°C to +80°C (-40°F to + 176°F)
- UV (sunlight) resistant
- Corrosion resistant
- UL Approved to UL-94 V-0 and UL-360. # E18917
- Meets or exceeds: ASTM-E162 (Flame spread); ASTM-E662 (Smoke density); Bombardier SMP-800C (Toxic gas generation)
- CSA Certified for 60°C dry, 60°C oil

APPLICATIONS

- Commercial applications where Zero Halogen and Low Smoke conduit is specified
- Rail & aerospace transport
- Commercial buildings



Square-Locked Design with integral bonding wire 3/8" - 1-1/4"



Interlocked Design 1-1/2" - 4" with no bonding wire



Trade Size	Item ID	Std. Pkg. m (ft)	Inside Diameter Min	Outside Diameter		Bend Radius	Weight kg/m (lbs/cft)
				Min	Max		
3/8" (12)	39802	30 (100)	12.29 (0.484)	17.50 (0.690)	18.00 (0.710)	76 (3.0)	0.37 (25)
1/2" (16)	39812	30 (100)	15.80 (0.622)	20.80 (0.820)	21.30 (0.840)	89 (3.5)	0.43 (29)
3/4" (21)	39822	30 (100)	20.83 (0.820)	26.17 (1.030)	26.67 (1.050)	127 (5.0)	0.65 (44)
1" (27)	39831	30 (100)	26.44 (1.041)	32.80 (1.290)	33.40 (1.315)	153 (6.0)	1.09 (73)
1-1/4" (35)	39841	15 (50)	35.05 (1.380)	41.40 (1.630)	42.20 (1.660)	178 (7.0)	1.49 (100)
1-1/2" (41)	39851	15 (50)	40.01 (1.575)	47.40 (1.865)	48.30 (1.900)	140 (5.5)	1.67 (112)
2" (53)	39861	15 (50)	51.31 (2.020)	59.40 (2.340)	60.30 (2.375)	178 (7.0)	2.2 (148)
2-1/2" (63)	39872	7.6 (25)	62.99 (2.480)	72.10 (2.840)	73.00 (2.875)	242 (9.5)	2.71 (182)
3" (78)	39881	7.6 (25)	77.98 (3.070)	87.90 (3.460)	88.90 (3.500)	381 (15.0)	3.79 (255)
4" (103)	39891	7.6 (25)	101.60 (4.000)	113.30 (4.460)	114.30 (4.500)	432 (17.0)	5.39 (362)

All dimensions in mm (inches) unless stated

FITTINGS FINDER



PAGE 33-38



PAGE 36

SEALTITE® SERIES

SEALTITE® HFSS ZERO HALOGEN, LOW SMOKE, LOW FLAME 316 STAINLESS STEEL CONDUIT



DESCRIPTION

- Constructed of continuously interlocked 316 stainless steel core for exceptional crush and corrosion resistance
- Durable, sunlight resistant, flame retardant, LOW SMOKE and ZERO HALOGEN TPU jacket that resists heat, oil and chemical breakdown
- Designed for most extreme temperature applications

SPECIFICATIONS

- 316 stainless steel core with liquid-tight PVC jacket
- Colour: black
- Temp. range: -51°F to +221°F (-40°C to +105°C)
- UV (sunlight) resistant
- Corrosion resistant

APPLICATIONS

- Applications of high and low temperature where a high level of corrosion resistance is required
- Safety applications where low smoke and zero halogen required
- Rail and infrastructure applications

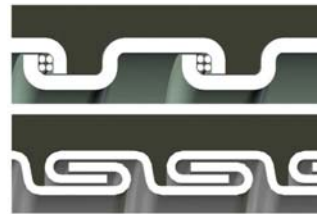

Square-Locked Design with cord packing 3/8" - 1-1/4"

Interlocked Design 1-1/2" - 2"



Trade Size	Item ID	Std. Pkg. m (ft)	Inside Diameter Min	Outside Diameter		Bend Radius	Weight kg/m (lbs/cft)
				Min	Max		
3/8" (12)	49802	30 (100)	12.29 (0.484)	17.53 (0.690)	18.03 (0.710)	26 (2.0)	0.33 (22)
1/2" (16)	49812	30 (100)	16.31 (0.622)	20.82 (0.820)	21.33 (0.840)	32 (2.5)	0.36 (24)
3/4" (21)	49822	30 (100)	20.83 (0.820)	26.17 (1.030)	26.67 (1.050)	38 (3.0)	0.54 (36)
1" (27)	49831	30 (100)	26.44 (1.041)	32.80 (1.290)	33.40 (1.315)	51 (4.0)	0.74 (50)
1-1/4" (35)	49841	30 (100)	35.05 (1.380)	41.40 (1.630)	42.20 (1.660)	57 (4.5)	0.98 (66)
1-1/2" (41)	49851	30 (100)	40.01 (1.575)	47.40 (1.865)	48.30 (1.900)	70 (5.5)	1.46 (98)
2" (53)	49861	30 (100)	51.31 (2.020)	59.40 (2.340)	60.30 (2.375)	89 (7.0)	1.93 (130)

All dimensions in mm (inches) unless stated

FITTINGS FINDER



PAGE 33-38



PAGE 36

SPECIALTY SERIES

SEALTITE® HFX-VO HALOGEN FREE FLEXIBLE CONDUIT



DESCRIPTION

- Robust conduit that retains flexibility at low temperatures and changing levels of humidity
- Suitable for outdoor applications
- Very flexible
- Constructed with a thermoplastic Polyurethane (TPU) jacket over a galvanized steel inner core
- TPU jacket is UL94 VO rated for superior flame protection, low smoke and zero halogen
- Specifically designed to protect cables that are constantly flexing and exposed to vibration and the elements when installed in under-car rail applications

SPECIFICATIONS

- Galvanized steel core with thick smooth TPU cover
- Colour: black
- Temp. range: -50°C to +105°C (-58°F to + 221°F), intermittent up to +125°C (+257°F)
- UV (sunlight) resistant, flame retardant
- EN 45545-2 (2013) R22 HL1, HL2 and R23 HL1, HL2
- Jacket meets NFPA-130 testing

APPLICATIONS

- Rail applications on vehicle for break sensors and jumper cables
- Where low smoke, zero halogen is required for very flexible applications

METALLIC
SEALTITE®



Square-Locked Design with cord packing from 5/16" - 1-1/4"



Interlocked Design 1-1/2" - 2"



Trade Size	Item ID	Std. Pkg. m (ft)	Inside Diameter Min	Outside Diameter Min	Bend Radius		Weight kg/m (lbs/cft)
					Static	Dynamic	
5/16" (10)	348.010.1	30 (100)	10.1 (0.397)	14.4 (0.567)	50 (2.0)	65 (2.6)	0.20 (13.4)
3/8" (12)	348.012.1	30 (100)	12.6 (0.496)	17.8 (0.701)	60 (2.4)	85 (3.3)	0.30 (20.1)
1/2" (16)	348.016.1	30 (100)	16.0 (0.630)	21.1 (0.831)	75 (3.0)	110 (4.3)	0.40 (26.8)
3/4" (21)	348.020.1	30 (100)	21.0 (0.827)	26.4 (1.039)	90 (3.5)	140 (5.5)	0.55 (36.9)
1" (27)	348.026.1	30 (100)	26.5 (1.043)	33.1 (1.303)	120 (4.7)	170 (6.7)	0.75 (50.3)
1-1/4" (35)	348.035.1	15 (50)	35.1 (1.381)	41.8 (1.646)	150 (5.9)	215 (8.5)	1.00 (67.1)
1-1/2" (41)	348.040.1	15 (50)	40.3 (1.589)	47.8 (1.882)	200 (7.9)	250 (9.8)	1.55 (104.0)
2" (53)	348.050.1	15 (50)	51.6 (2.031)	59.9 (2.358)	350 (13.8)	300 (11.8)	2.15 (144.3)

All dimensions in mm (inches) unless stated

FITTINGS FINDER



PAGE 33-38



PAGE 36

SPECIALTY SERIES

SEALTITE® SHIELDTITE EMI/EMP RESISTANT FLEXIBLE CONDUIT



DESCRIPTION

- Flexible bronze core liquid-tight conduit
- Designed for applications needing superior EMI and EMP shielding
- Uses standard liquid-tight connectors for easy installation

SPECIFICATIONS

- Bronze core with liquid-tight PVC jacket
- Colour: grey
- Temp. range: -46°C to +105°C (-51°F to + 221°F)
- UV (sunlight) resistant
- Corrosion resistant
- Special bronze core provides high-level shielding protection
- Meets MIL-STD-1310H
- Provides shielding effectiveness of 81-119 Db at 1 Mhz to 1 Ghz

APPLICATIONS

- Applications where high shielding is required
- Military, power generation, and communications



Interlocked Design 3/8"
- 4"



Trade Size	Item ID	Std. Pkg. m (ft)	Inside Diameter Min	Outside Diameter		Bend Radius	Weight kg/m (lbs/cft)
				Min	Max		
3/8" [12]	450200	Available in Random Lengths	12.29 [0.484]	17.50 [0.690]	18.00 [0.710]	76 [3.0]	0.36 [24]
1/2" [16]	450202		15.80 [0.622]	20.80 [0.820]	21.30 [0.840]	89 [3.0]	0.42 [28]
3/4" [21]	450204		20.83 [0.820]	26.17 [1.030]	26.67 [1.050]	127 [4.0]	0.63 [42]
1" [27]	450206		26.44 [1.041]	32.80 [1.290]	33.40 [1.315]	153 [4.0]	0.83 [56]
1-1/4" [35]	450208		35.05 [1.380]	41.40 [1.630]	42.20 [1.660]	178 [4.5]	1.12 [75]
1-1/2" [41]	450210		40.01 [1.575]	47.40 [1.865]	48.30 [1.900]	140 [7.0]	1.43 [96]
2" [53]	450212		51.31 [2.020]	59.40 [2.340]	60.30 [2.375]	178 [9.5]	1.86 [125]
2-1/2" [63]	450214		62.99 [2.480]	72.10 [2.840]	73.00 [2.875]	242 [12.0]	2.46 [165]
3" [78]	450216		77.98 [3.070]	87.90 [3.460]	88.90 [3.500]	381 [13.5]	3.14 [211]
4" [103]	450220		101.60 [4.000]	113.30 [4.460]	114.30 [4.500]	432 [17.0]	4.43 [298]

All dimensions in mm (inches) unless stated



PAGE 33-38



PAGE 36

SPECIALTY SERIES

SEALTITE® NWC RADIATION RESISTANT FLEXIBLE CONDUIT



DESCRIPTION

- Flexible metal core liquid-tight conduit
- Special polyethylene jacket that provides resistance to radiation
- Suitable for use in nuclear containment areas
- Uses standard liquid-tight connectors for easy installation

SPECIFICATIONS

- Galvanized steel core with liquid-tight polyethylene jacket
- Colour: black
- Temp. range: -40°C to +89°C (-40°F to + 192°F)
- Radiation resistant
- Corrosion resistant
- Meets IEEE 323-1974 and IEEE 383-1974 guidelines
- Acceptable for use in nuclear containment areas

APPLICATIONS

- Applications requiring radiation resistance
- Power generation, military, and medical

METALLIC
SEALTITE®



Square-Locked Design with integral bonding wire 3/8" - 1-1/4"

Interlocked Design 1-1/2" - 4" with no bonding wire



Trade Size	Item ID	Std. Pkg. m (ft)	Inside Diameter Min	Outside Diameter		Bend Radius	Weight kg/m (lbs/cft)
				Min	Max		
3/8" (12)	433999	30 (100)	12.29 (0.484)	17.50 (0.690)	18.00 (0.710)	253 (8)	0.37 (25)
1/2" (16)	434009	30 (100)	15.80 (0.622)	20.80 (0.820)	21.30 (0.840)	229 (9)	0.43 (29)
3/4" (21)	434019	30 (100)	20.83 (0.820)	26.17 (1.030)	26.67 (1.050)	330 (13)	0.65 (44)
1" (27)	434029	30 (100)	26.44 (1.041)	32.80 (1.290)	33.40 (1.315)	381 (15)	1.09 (73)
1-1/4" (35)	434039	15 (50)	35.05 (1.380)	41.40 (1.630)	42.20 (1.660)	457 (18)	1.49 (100)
1-1/2" (41)	434049	15 (50)	40.01 (1.575)	47.40 (1.865)	48.30 (1.900)	508 (20)	1.67 (112)
2" (53)	434059	15 (50)	51.31 (2.020)	59.40 (2.340)	60.30 (2.375)	559 (22)	2.2 (148)
2-1/2" (63)	434069	7.6 (25)	62.99 (2.480)	72.10 (2.840)	73.00 (2.875)	610 (24)	2.71 (182)
3" (78)	434079	7.6 (25)	77.98 (3.070)	87.90 (3.460)	88.90 (3.500)	762 (30)	3.79 (255)
4" (103)	434089	7.6 (25)	101.60 (4.000)	113.30 (4.460)	114.30 (4.500)	915 (36)	5.39 (362)

All dimensions in mm (inches) unless stated

FITTINGS FINDER



PAGE 33-38



PAGE 36

SPECIALTY SERIES

SEALTITE® FG FOOD GRADE FLEXIBLE CONDUIT



DESCRIPTION

- Constructed with thermoplastic PVC jacket over galvanized steel inner core
- PVC jacket specially formulated for food and beverage applications per FDA CFR 21 and NSF 51 requirements
- Jacket is easily cleaned and does not promote bacteria growth

SPECIFICATIONS

- Galvanized steel core with thick smooth PVC cover
- Colour: white
- Temp. range: -20°C to +60°C (-4°F to +140°F)
- NSF Certified to NSF / ANSI 169 for special purpose food equipment or devices

APPLICATIONS

- Suitable for food equipment or devices
- Food equipment manufacturers
- Meat packing or poultry facilities
- Pharmaceutical facilities



Square-Locked Design with cord packing from 3/18" - 1-1/4"



Interlocked Design 1-1/2" - 4"



Trade Size	Item ID	Std. Pkg. m (ft)	Inside Diameter Min	Outside Diameter		Bend Radius	Weight kg/m (lbs/cft)
				Min	Max		
3/8" (12)	35502	30 (100)	12.29 (0.484)	17.50 (0.690)	18.00 (0.710)	51 (2.0)	0.31 (21)
1/2" (16)	35512	30 (100)	15.80 (0.622)	20.80 (0.820)	21.30 (0.840)	64 (2.5)	0.37 (25)
3/4" (21)	35522	30 (100)	20.83 (0.820)	26.17 (1.030)	26.67 (1.050)	76 (3.0)	0.58 (39)
1" (27)	35531	30 (100)	26.44 (1.041)	32.80 (1.290)	33.40 (1.315)	102 (4.0)	0.76 (51)
1-1/4" (35)	35541	15 (50)	35.05 (1.380)	41.40 (1.630)	42.20 (1.660)	115 (4.5)	0.98 (66)
1-1/2" (41)	35551	15 (50)	40.01 (1.575)	47.40 (1.865)	48.30 (1.900)	140 (5.5)	1.55 (104)
2" (53)	35561	15 (50)	51.31 (2.020)	59.40 (2.340)	60.30 (2.375)	176 (7.0)	2.02 (136)

All dimensions in mm (inches) unless stated

FITTINGS FINDER



PAGE 33-38



PAGE 36

SPECIALTY SERIES

SEALTITE® AS ANTI-STATIC FLEXIBLE CONDUIT



DESCRIPTION

- Robust conduit for use in hazardous areas where a risk of explosion exists
- Conduit cover provides surface resistance of $<10^9$ Ohm, thus preventing electrostatic charge from accumulating on the surface of the conduit cover as well as sparks in the case of discharge by contact
- Suitable for outdoor and burial installations

SPECIFICATIONS

- Galvanized steel core with thick smooth anti-static PVC cover
- Colour: black
- Temp. range: -25°C to $+70^{\circ}\text{C}$ (-13°F to $+158^{\circ}\text{F}$), intermittent up to $+90^{\circ}\text{C}$ ($+194^{\circ}\text{F}$)
- UV (sunlight) resistant, lead free

APPLICATIONS

- Suitable for outside installation
- Hazardous locations in conjunction with ATEX fittings in order to avoid sparks

METALLIC
SEALTITE®



Square-Locked Design from 3/8" - 1-1/4"



Interlocked Design 1-1/2" - 2"



Trade Size	Item ID	Std. Pkg. m (ft)	Inside Diameter Min	Outside Diameter Min	Bend Radius		Weight kg/m (lbs/cft)
					Static	Dynamic	
3/8" (12)	350.012.1	30 (100)	12.6 (0.496)	17.8 (0.701)	60 (2.4)	85 (3.3)	0.30 (20.13)
1/2" (16)	350.016.1	30 (100)	16.0 (0.630)	21.1 (0.831)	75 (3.0)	110 (4.3)	0.40 (26.84)
3/4" (21)	350.020.1	30 (100)	21.0 (0.827)	26.4 (1.039)	90 (3.5)	140 (5.5)	0.55 (36.90)
1" (27)	350.026.1	30 (100)	26.5 (1.043)	33.1 (1.303)	120 (4.7)	170 (6.7)	0.75 (50.32)
1-1/4" (35)	350.035.1	15 (50)	35.1 (1.381)	41.8 (1.646)	150 (5.9)	215 (8.5)	1.00 (67.09)
1-1/2" (41)	350.040.1	15 (50)	40.3 (1.589)	47.8 (1.882)	200 (7.9)	250 (9.8)	1.55 (104.00)
2" (53)	350.050.1	15 (50)	51.6 (2.031)	59.9 (2.358)	350 (13.8)	300 (11.8)	2.15 (144.26)

All dimensions in mm (inches) unless stated

FITTINGS FINDER



PAGE 47-50



FITTINGS

SEALTITE® SERIES

ANACONDA SEALTITE® fittings are designed to the same high standards that our SEALTITE® conduit is and together provide the best possible protection for industrial applications.

Fittings are available in various materials in order to best suit requirements, including nickel plated brass and stainless steel 304 and 316.

METALLIC FITTINGS

SEALTITE® COMPACT FITTINGS NICKEL PLATED BRASS PREMIUM NPT FITTINGS



SPECIFICATIONS

- Nickel Plated Brass w/ PA6 clamping ring.
- O-ring and lock nut included
- Colour: silver
- Temp. range: -45° C to +105° C (-49° F to +221° F)
- cULus Approved # E234207

APPLICATIONS

- Metallic and Type B non-metallic flexible conduit
- Compact design ideal for tight spaces
- High-end appearance for good presentation

DESCRIPTION

- New compact design: 20% smaller and 35% lighter than standard SEALTITE® fittings. Ideal for tight spaces
- Excellent corrosion resistance, strength and durability
- IP 66/67 rated when installed with approved conduit and tightened to UL-514B/CSA C22.2 18.3 torque specifications
- Approved for both exposed and concealed locations

SEALTITE®
FITTINGS

STRAIGHT:



Trade Size	Item ID	Min. Int. Bore	Dimensions mm				KO Size NPT	Weight kg(lb)/100	Std. Pkg.
			A	B	C	E			
3/8"	714.012.2	11.0	35	14	26	24	1/2"	4.9 (10.8)	10
1/2"	714.016.2	14.5	36	14	29	27	1/2"	5.5 (12.1)	10
3/4"	714.020.2	19.4	37	14	35	33	3/4"	7.8 (17.2)	5
1"	714.026.2	24.7	40	16	45	42	1"	13.9 (30.6)	5
1-1/4"	714.035.2	33.3	43	16	53	52	1-1/4"	18.6 (41.0)	2
1-1/2"	714.040.2	38.0	50	18	62	60	1-1/2"	28.0 (61.7)	2
2"	714.050.2	49.0	56	20	76	72	2"	44.0 (97.0)	2

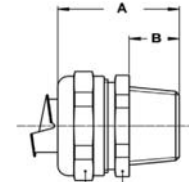

90 DEGREE:



Trade Size	Item ID	Min. Int. Bore	Dimensions mm					KO Size NPT	Weight kg(lb)/100	Std. Pkg.
			A	B	C	D	E			
3/8"	714.912.2	11.0	30	14	26	32	24	1/2"	8.7 (19.2)	10
1/2"	714.916.2	14.5	32	14	29	34	27	1/2"	10.1 (22.3)	10
3/4"	714.920.2	19.4	36	14	35	40	33	3/4"	16.7 (36.8)	5
1"	714.926.2	24.7	44	16	45	49	42	1"	29.6 (65.3)	5
1-1/4"	714.935.2	33.3	49	16	53	53	52	1-1/4"	43.2 (95.2)	2
1-1/2"	714.940.2	38.0	56	18	62	57	60	1-1/2"	59.5 (131.2)	2
2"	714.950.2	49.0	66	20	76	68	72	2"	93.6 (206.4)	2

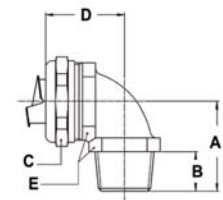

METALLIC FITTINGS

SEALTITE® COMPACT FITTINGS NICKEL PLATED BRASS PREMIUM METRIC FITTINGS



SPECIFICATIONS

- Nickel Plated Brass w/ PA6 clamping ring
- O-ring included
- Colour: silver
- Temp. range: -45° C to + 105° C (-49° F to +221° F)
- cULus Approved # E234207

APPLICATIONS

- Metallic and Type B non-metallic flexible conduit
- Compact design ideal for tight spaces
- High-end appearance for good presentation

DESCRIPTION

- New compact design: 20% smaller and 35% lighter than standard SEALTITE® fittings. Ideal for tight spaces
- Excellent corrosion resistance, strength and durability
- IP 66/67 rated when installed with approved conduit and tightened to UL-514B/CSA C22.2 18.3 torque specifications
- Approved for both exposed and concealed locations

SEALTITE®
FITTINGS

STRAIGHT:



Trade Size	Thread ISO	Item ID	Min. Int. Bore	Dimensions mm				Weight kg(lb)/100	Std. Pkg.
				A	B	C	E		
3/8"	M16 x 1.5	712.016.1	11.0	31	10	26	24	3.9 (10.8)	10
3/8"	M20 x 1.5	712.017.1	11.0	31	10	26	24	4.0 (10.8)	10
1/2"	M20 x 1.5	712.020.1	14.5	32	10	29	27	4.4 (12.1)	10
3/4"	M25 x 1.5	712.025.1	19.4	33	10	35	33	6.6 (17.2)	5
1"	M32 x 1.5	712.032.1	24.7	36	12	45	42	11.7 (30.6)	5
1-1/4"	M40 x 1.5	712.040.1	33.3	40	13	53	52	16.0 (41.0)	2
1-1/2"	M50 x 1.5	712.050.1	38.0	46	14	62	60	25.3 (61.7)	2
2"	M63 x 1.5	712.063.1	49.0	52	16	76	72	38.6 (97.0)	2

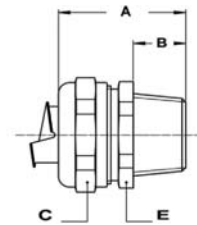

90 DEGREE:



Trade Size	Thread ISO	Item ID	Min. Int. Bore	Dimensions mm					Weight kg(lb)/100	Std. Pkg.
				A	B	C	D	E		
3/8"	M16 x 1.5	712.916.1	11.0	26	10	26	31	24	8.7 (19.2)	10
3/8"	M20 x 1.5	712.917.1	11.0	26	10	26	32	24	8.7 (19.2)	10
1/2"	M20 x 1.5	712.920.1	14.5	28	10	29	34	27	10.1 (22.3)	10
3/4"	M25 x 1.5	712.925.1	19.4	32	10	35	40	33	16.7 (36.8)	5
1"	M32 x 1.5	712.932.1	24.7	40	12	45	49	42	29.6 (65.3)	5
1-1/4"	M40 x 1.5	712.940.1	33.3	46	13	53	53	52	43.2 (95.2)	2
1-1/2"	M50 x 1.5	712.950.1	38.0	52	14	62	57	60	59.5 (131.2)	2
2"	M63 x 1.5	714.963.1	49.0	62	16	76	68	72	93.6 (206.4)	2

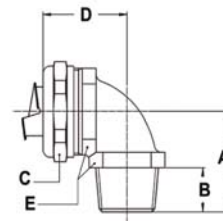

METALLIC FITTINGS

SEALTITE® COMPACT FITTINGS STAINLESS STEEL AISI-304 PREMIUM NPT/METRIC FITTINGS



SPECIFICATIONS

- AISI-304 Ferrule and lock nut and PA6 clamping ring
- O-ring and lock nut included
- Colour: silver
- Temp. range: -45° C to +105° C (-49° F to +221° F)
- cULus Approved # E234207

APPLICATIONS

- Metallic and Type B non-metallic flexible conduit
- Premium Stainless 304 for corrosion resistance.
- Compact design for tight spaces

DESCRIPTION

- New compact design: 20% smaller and 35% lighter than standard SEALTITE® fittings which means ideal for tight spaces
- Superior Stainless 304 corrosion resistance, strength and durability
- IP 66/67 rated when installed with approved conduit and tightened to UL-514B/CSA C22.2 18.3 torque specifications
- Approved for both exposed and concealed locations

Note: For 90 degree versions, use AISI-316

SEALTITE®
FITTINGS

STRAIGHT NPT:



Trade Size	Item ID	Min. Int. Bore	Dimensions mm				KO Size NPT	Weight kg(lb)/100	Std. Pkg.
			A	B	C	E			
3/8"	714.012.92	11.0	35	14	26	24	1/2"	4.9 (10.8)	10
1/2"	714.016.92	14.5	36	14	29	27	1/2"	5.5 (12.1)	10
3/4"	714.020.92	19.4	37	14	35	33	3/4"	7.8 (17.2)	5
1"	714.026.92	24.7	40	16	45	42	1"	13.9 (30.6)	5
1-1/4"	714.035.92	33.3	43	16	53	52	1-1/4"	18.6 (41.0)	2
1-1/2"	714.040.92	38.0	50	18	62	60	1-1/2"	28.0 (61.7)	2
2"	714.050.92	49.0	56	20	76	72	2"	44.0 (97.0)	2

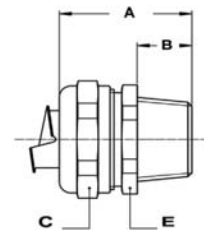

STRAIGHT METRIC:



Trade Size	Thread ISO	Item ID	Min. Int. Bore	Dimensions mm				Weight kg(lb)/100	Std. Pkg.
				A	B	C	E		
3/8"	M16 x 1.5	712.016.9	11.0	31	10	26	24	3.9 (10.8)	10
3/8"	M20 x 1.5	712.017.9	11.0	31	10	26	24	4.0 (10.8)	10
1/2"	M20 x 1.5	712.020.9	14.5	32	10	29	27	4.4 (12.1)	10
3/4"	M25 x 1.5	712.025.9	19.4	33	10	35	33	6.6 (17.2)	5
1"	M32 x 1.5	712.032.9	24.7	36	12	45	42	11.7 (30.6)	5
1-1/4"	M40 x 1.5	712.040.9	33.3	40	13	53	52	16.0 (41.0)	2
1-1/2"	M50 x 1.5	712.050.9	38.0	46	14	62	60	25.3 (61.7)	2
2"	M63 x 1.5	712.063.9	49.0	52	16	76	72	38.6 (97.0)	2

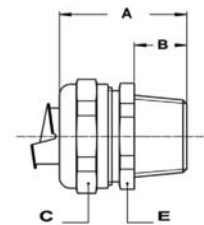

METALLIC FITTINGS

SEALTITE® FITTINGS

STAINLESS STEEL AISI-304 PREMIUM NPT FITTINGS



DESCRIPTION

- Stainless 304 corrosion resistance, strength and durability
- IP 66/67 rated when installed with approved conduit and tightened to UL-514B/CSA C22.2 18.3 torque specifications
- Approved for both exposed and concealed locations

SPECIFICATIONS

- AISI-304 with Nickel Plated Brass Ferrule and PA6 clamping ring
- O-ring included
- Colour: silver
- Temp. range: -45° C to +105° C (-49° F to +221° F)
- cULus Approved # E234207

APPLICATIONS

- Metallic and Type B non-metallic flexible conduit
- Premium Stainless 304 for corrosion resistance
- Chemical and food industries

SEALTITE®
FITTINGS

STRAIGHT:



Trade Size	Item ID	Old Item ID	Min. Int. Bore	Dimensions mm				KO Size NPT	Weight kg(lb)/100	Std. Pkg.
				A	B	C	E			
3/8"	814.012.9	SSLT38	10.2	37	13	27	24	1/2"	5.6 (12.3)	10
1/2"	814.016.9	SSLT50	13.9	37	13	30	27	1/2"	6.2 (13.7)	10
3/4"	814.020.9	SSLT75	18.5	40	15	36	36	3/4"	8.9 (19.6)	5
1"	814.026.9	SSLT100	23.8	46	15	46	46	1"	25 (55.1)	5

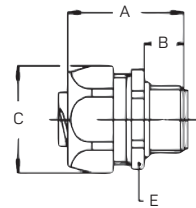

90 DEGREE:



Trade Size	Item ID	Old Item ID	Min. Int. Bore	Dimensions mm					KO Size NPT	Weight kg(lb)/100	Std. Pkg.
				A	B	C	D	E			
3/8"	814.912.9	SSLT9038	10.2	36	13	27	43	22	1/2"	13.3 (29.3)	10
1/2"	814.916.9	SSLT9050	13.9	36	13	30	43	27	1/2"	14.6 (32.2)	10
3/4"	814.920.9	SSLT9075	18.5	43	15	36	48	33	3/4"	22.0 (48.5)	5
1"	814.926.9	SSLT90100	23.8	48	15	46	59	42	1"	31.7 (69.9)	5

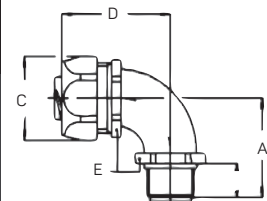

METALLIC FITTINGS

SEALTITE® COMPACT FITTINGS STAINLESS STEEL AISI-316 PREMIUM NPT FITTINGS



DESCRIPTION

- New compact design: 20% smaller and 35% lighter than standard SEALTITE® fittings which makes it ideal for tight spaces
- Superior Stainless 316 corrosion resistance, strength and durability
- IP 66/67 rated when installed with approved conduit and tightened to UL-514B/CSA C22.2 18.3 torque specifications
- Approved for both exposed and concealed locations

SPECIFICATIONS

- AISI-316 body with AISI-304 Ferrule and lock nut and PA6 clamping ring
- O-ring and lock nut included
- Colour: silver
- Temp. range: -45° C to + 105° C (-49° F to +221° F)
- cULus Approved # E234207

APPLICATIONS

- Metallic and Type B non-metallic flexible conduit
- Premium Stainless 316 for the best corrosion resistance.
- Compact design for tight spaces

SEALTITE®
FITTINGS

STRAIGHT:



Trade Size	Item ID	Min. Int. Bore	Dimensions mm				KO Size NPT	Weight kg(lb)/100	Std. Pkg.
			A	B	C	E			
3/8"	714.112.92	11.0	35	14	26	24	1/2"	4.9 (10.8)	10
1/2"	714.116.92	14.5	36	14	29	27	1/2"	5.5 (12.1)	10
3/4"	714.120.92	19.4	37	14	35	33	3/4"	7.8 (17.2)	5
1"	714.126.92	24.7	40	16	45	42	1"	13.9 (30.6)	5
1-1/4"	714.135.92	33.3	43	16	53	52	1-1/4"	18.6 (41.0)	2
1-1/2"	714.140.92	38.0	50	18	62	60	1-1/2"	28.0 (61.7)	2
2"	714.150.92	49.0	56	20	76	72	2"	44.0 (97.0)	2

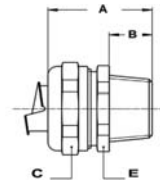

90 DEGREE:



Trade Size	Item ID	Min. Int. Bore	Dimensions mm					KO Size NPT	Weight kg(lb)/100	Std. Pkg.
			A	B	C	D	E			
3/8"	714.512.92	11.0	30	14	26	32	24	1/2"	8.7 (19.2)	10
1/2"	714.516.92	14.5	32	14	29	34	27	1/2"	10.1 (22.3)	10
3/4"	714.520.92	19.4	36	14	35	40	33	3/4"	16.7 (36.8)	5
1"	714.526.92	24.7	44	16	45	49	42	1"	29.6 (65.3)	5
1-1/4"	714.535.92	33.3	49	16	53	53	52	1-1/4"	43.2 (95.2)	2
1-1/2"	714.540.92	38.0	56	18	62	57	60	1-1/2"	59.5 (131.2)	2
2"	714.550.92	49.0	66	20	76	68	72	2"	93.6 (206.4)	2

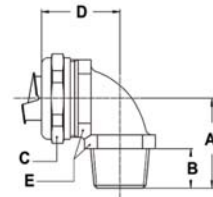

METALLIC FITTINGS

SEALTITE® COMPACT FITTINGS STAINLESS STEEL AISI-316 PREMIUM METRIC FITTINGS



DESCRIPTION

- New compact design: 20% smaller and 35% lighter than standard SEALTITE® fittings which makes it ideal for tight spaces
- Superior Stainless 316 corrosion resistance, strength and durability
- IP 66/67 rated when installed with approved conduit and tightened to UL-514B/CSA C22.2 18.3 torque specifications
- Approved for both exposed and concealed locations

SPECIFICATIONS

- AISI-316 body with AISI-304 Ferrule and PA6 clamping ring
- O-ring included
- Colour: silver
- Temp. range: -55° C to + 260° C [-67° F to +500° F]
- cULus Approved # E234207

APPLICATIONS

- Metallic and Type B non-metallic flexible conduit
- Premium Stainless 316 for the best corrosion resistance
- Compact design for tight spaces

SEALTITE®
FITTINGS

STRAIGHT:



Trade Size	Thread ISO	Item ID	Min. Int. Bore	Dimensions mm				Weight kg(lb)/100	Std. Pkg.
				A	B	C	E		
3/8"	M16 x 1.5	712.116.9	11.0	31	10	26	24	3.9 (10.8)	10
3/8"	M20 x 1.5	712.117.9	11.0	31	10	26	24	4.0 (10.8)	10
1/2"	M20 x 1.5	712.120.9	14.5	32	10	29	27	4.4 (12.1)	10
3/4"	M25 x 1.5	712.125.9	19.4	33	10	35	33	6.6 (17.2)	5
1"	M32 x 1.5	712.132.9	24.7	36	12	45	42	11.7 (30.6)	5
1-1/4"	M40 x 1.5	712.140.9	33.3	40	13	53	52	16.0 (41.0)	2
1-1/2"	M50 x 1.5	712.150.9	38.0	46	14	62	60	25.3 (61.7)	2
2"	M63 x 1.5	712.163.9	49.0	52	16	76	72	38.6 (97.0)	2

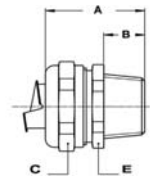

90 DEGREE:



Trade Size	Thread ISO	Item ID	Min. Int. Bore	Dimensions mm					Weight kg(lb)/100	Std. Pkg.
				A	B	C	D	E		
3/8"	M16 x 1.5	712.516.9	11.0	26	10	26	31	24	8.7 (19.2)	10
3/8"	M20 x 1.5	712.517.9	11.0	26	10	26	32	24	8.7 (19.2)	10
1/2"	M20 x 1.5	712.520.9	14.5	28	10	29	34	27	10.1 (22.3)	10
3/4"	M25 x 1.5	712.525.9	19.4	32	10	35	40	33	16.7 (36.8)	5
1"	M32 x 1.5	712.532.9	24.7	40	12	45	49	42	29.6 (65.3)	5
1-1/4"	M40 x 1.5	712.540.9	33.3	46	13	53	53	52	43.2 (95.2)	2
1-1/2"	M50 x 1.5	712.550.9	38.0	52	14	62	57	60	59.5 (131.2)	2
2"	M63 x 1.5	714.563.9	49.0	62	16	76	68	72	93.6 (206.4)	2

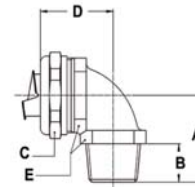

METALLIC FITTINGS

SEALTITE® COMPACT FITTINGS ZINC-PLATED STEEL FITTINGS



DESCRIPTION

- Fitting is ideal for use with standard liquid-tight conduit to allow easy installation. IP 66/67 Rated when installed with approved conduit
- Included sealing washer and galvanized steel lock nut provides a means for connecting the fitting to boxes
- Approved for both exposed and concealed locations

SPECIFICATIONS

- Zinc plated steel fitting, has a five piece construction consisting of a gland nut, sealing ring, high tensile grounding ferrule, insulated throat, and body
- Colour: silver
- Temp. range: -45°C to +105°C (-49°F to + 221°F)
- Complies with UL Standard 514B File No. E472179 category code TEOZ

APPLICATIONS

- Corrosion resistant, protects from moisture and oils
- Suitable for hazardous locations per NEC Articles 501
 - Class I Div. 2, Article 502 Class II
 - Div. 1 & 2, Article 503 Class III Div. 1 & 2

SEALTITE®
FITTINGS

STRAIGHT:



Trade Size	Item ID	Min. Int. Bore	Dimensions mm			KO Size NPT	Weight kg(lb)/100	Std. Pkg.
			A	B	C			
1/2"	7STR38B	10.7	31	15	28	3/8"	4.5 (10)	10
1/2"	7STR50B	13.5	32	15	30	1/2"	5.9 (13)	10
3/4"	7STR75B	18.8	34	15	36	3/4"	8.2 (18)	10
1"	7STR100B	23.9	45	17	45	1"	14.5 (32)	5
1-1/4"	7STR125B	32.3	41	18	55	1-1/4"	20 (44)	2
1-1/2"	7STR150B	37.6	45	18	61	1-1/2"	29.9 (66)	2
2"	7STR200B	48.8	48	18	73	2"	38.6 (85)	2
2-1/2" *	7STR250B	63.5	83	38	102	2-1/2"	117.9 (260)	1
3" *	7STR300B	76.2	99	38	118	3"	163.3 (360)	1
4" *	7STR400B	101.6	102	41	148	4"	235.9 (520)	1
5" * **	7STR500	127.3	127	41	178	5"	521.6 (1150)	1
6" * **	7STR600	152.7	152	-	-	6"	-	1

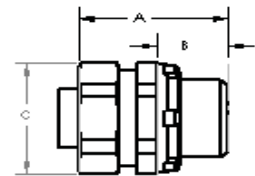

* Malleable iron body

** 5" & 6" fitting are made in China - non-UL

METALLIC FITTINGS

SEALTITE® COMPACT FITTINGS ZINC-PLATED STEEL FITTINGS



DESCRIPTION

- Fitting is ideal for use with standard liquid-tight conduit to allow easy installation. IP 66/67 Rated when installed with approved conduit
- Included sealing washer and galvanized steel lock nut provides a means for connecting the fitting to boxes
- Approved for both exposed and concealed locations

45 DEGREE:

Trade Size	Item ID	Min. Int. Bore	Dimensions mm				KO Size NPT	Weight kg(lb)/100	Std. Pkg.
			A	B	C	D			
1/2" *	7STR3845B	10.7	25	15	28	27	3/8"	4.5 (21)	10
1/2" *	7STR5045B	13.5	25	15	30	32	1/2"	5.9 (23)	10
3/4" *	7STR7545B	18.8	29	15	32	33	3/4"	8.2 (32)	10
1" *	7STR10045B	23.9	34	17	44	35	1"	14.5 (53)	5
1-1/4" *	7STR12545B	32.3	34	18	55	38	1-1/4"	20.0 (69)	2
1-1/2" *	7STR15045B	37.6	36	18	60	41	1-1/2"	29.9 (99)	2
2" *	7STR20045B	48.8	41	18	73	44	2"	38.6 (152)	2
2-1/2" *	7STR25045B	63.5	121	38	102	57	2-1/2"	117.9 (478)	1
3" *	7STR30045B	76.2	140	38	118	64	3"	163.3 (775)	1
4" *	7STR40045B	101.6	197	41	148	64	4"	235.9 (1000)	1

* Malleable iron body

SPECIFICATIONS

- Zinc plated steel fitting, has a five piece construction consisting of a gland nut, sealing ring, high tensile grounding ferrule, insulated throat, and body
- Colour: silver
- Temp. range: -45°C to +105°C (-49°F to + 221°F)
- Complies with UL Standard 514B File No. E472179 category code TEOZ

APPLICATIONS

- Corrosion resistant, protects from moisture and oils
- Suitable for hazardous locations per NEC Articles 501
 - Class I Div. 2, Article 502 Class II
 - Div. 1 & 2, Article 503 Class III Div. 1 & 2

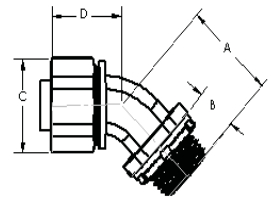

90 DEGREE:

Trade Size	Item ID	Min. Int. Bore	Dimensions mm				KO Size NPT	Weight kg(lb)/100	Std. Pkg.
			A	B	C	D			
1/2" *	7STR3890B	10.7	29	15	28	32	3/8"	4.5 (24)	10
1/2" *	7STR5090B	13.5	29	15	30	37	1/2"	5.9 (24)	10
3/4" *	7STR7590B	18.8	38	15	36	40	3/4"	8.2 (38)	10
1" *	7STR10090B	23.9	44	17	44	48	1"	14.5 (70)	5
1-1/4" *	7STR12590B	32.3	48	18	55	51	1-1/4"	20.0 (88)	2
1-1/2" *	7STR15090B	37.6	51	18	60	60	1-1/2"	29.9 (125)	2
2" *	7STR20090B	48.8	57	18	73	70	2"	38.6 (180)	2
2-1/2" *	7STR25090B	63.5	203	38	-	235	2-1/2"	117.9 (625)	1
3" *	7STR30090B	76.2	222	38	-	267	3"	163.3 (900)	1
4" *	7STR40090B	101.6	321	38	-	330	4"	235.9 (1500)	1

* Malleable iron body

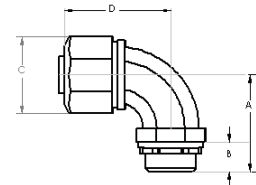

METALLIC FITTINGS

SEALTITE® LT FITTINGS ZINC DIECAST NPT FITTINGS



SPECIFICATIONS

- Zinc Die-cast
- Lock nut included
- Colour: silver
- Temp. range: -18° C to +90° C (0° F to +194° F)
- CSA Approved # LR49636
- UL Approved # E60812

APPLICATIONS

- Metallic and Type B non-metallic flexible conduit

DESCRIPTION

- Standard grade fitting
- Approved for used with metallic and non-metallic conduit
- Disassembly not required for connection to liquid-tight conduit

STRAIGHT:



Trade Size	Item ID	Dimensions mm			KO Size NPT	Weight kg(lb)/100	Std. Pkg.
		A	B	C			
3/8"	LT38	37	13	32	1/2"	6.4 (14.1)	25
1/2"	LT50	37	13	35	1/2"	8.0 (17.6)	25
3/4"	LT75	40	13	44	3/4"	11.0 (24.3)	10
1"	LT100	47	15	48	1"	14.0 (30.9)	5
1-1/4"	LT125	53	16	55	1-1/4"	22.0 (48.5)	5
1-1/2"	LT150	51	16	64	1-1/2"	30.0 (66.1)	2
2"	LT200	53	15	81	2"	40.0 (88.2)	2
2-1/2"	LT250	83	25	107	2-1/2"	-	1
3"	LT300	103	27	125	3"	-	1
4"	LT400	110	29	151	4"	-	1

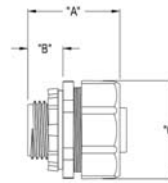

90 DEGREE:



Trade Size	Item ID	Dimensions mm			KO Size NPT	Weight kg(lb)/100	Std. Pkg.
		A	B	C			
3/8"	LT9038	52	13	59	1/2"	10.0 (22.0)	10
1/2"	LT9050	54	13	59	1/2"	13.0 (28.7)	10
3/4"	LT9075	64	13	68	3/4"	16.0 (35.3)	10
1"	LT90100	70	17	92	1"	24.0 (52.9)	5
1-1/4"	LT90125	85	18	99	1-1/4"	40.0 (88.2)	2
1-1/2"	LT90150	89	15	111	1-1/2"	55.0 (121.3)	2
2"	LT90200	104	17	124	2"	75.0 (165.3)	2
2-1/2"	LT90250	140	22	158	2-1/2"	-	1
3"	LT90300	152	24	171	3"	-	1
4"	LT90400	178	24	203	4"	-	1

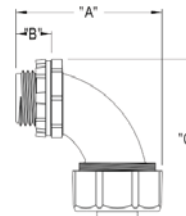

SS ULTRA-FLEX SERIES

STAINLESS STEEL FLEX CONNECTORS FOR USE WITH SL/UL-CAP



SPECIFICATIONS

- Type 303 stainless steel (internal ferrule: nickel-plated brass)
- Colour: silver
- Temperature range: -45°C to +105°C (-49°F to +221°F)

DESCRIPTION

- Special ferrule allows connection to either SL conduit
- Excellent for harsh installation
- Excellent protection for small diameter cables or fibre-optics
- Corrosion resistant

SEALTITE® FITTINGS

STRAIGHT:



SL/UI Size	Item ID	Dimensions mm			KO Size NPT	Weight kg(lb)/Pkg	Standard Package
		A	B	C			
3/8"	SSUI38	37	13	26	1/2"	1.6 (3.5)	25
1/2"	SSUI50	37	13	29	1/2"	2.0 (4.4)	25

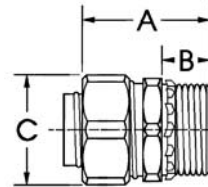

90 DEGREE:



SL/UI Size	Item ID	Dimensions mm				KO Size NPT	Weight kg(lb)/Pkg	Standard Package
		A	B	C	D			
3/8"	SSUI9038	36	13	26	43	1/2"	1.0 (2.2)	10
1/2"	SSUI9050	36	13	29	43	1/2"	1.3 (2.9)	10

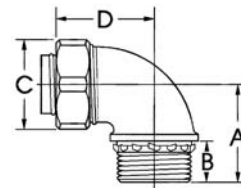

Special ferrule allows fitting to accept Ultra Flexible SL sizes 3/8" and 1/2". Positive ferrule connection for interconnect to standard NPT applications.



CABLE GLANDS

SEALTITE® NICKEL PLATED BRASS



DESCRIPTION

- Contain two clamping seals, one with a larger diameter seal into which a smaller diameter seal fits
- Seals are made of V0 rated EPDM rubber, tested and certified in compliance with EN45545-2, Hazard Level (HL1 / HL2 / HL3) for rail applications
- With larger diameter cable, larger diameter seal can be used on its own
- With smaller diameter cable, both clamping seals required with smaller inserted inside larger
- Both seals supplied as standard
- Double seal cable glands can also be used with braided cables for EMC applications by simply folding the end of the braid over the top of the clamping seal(s) before mounting
- cULus approved and have extra robust counter nut and an increased clamping strength

SPECIFICATIONS

- Nickel plated brass gland, male, consisting of 3 parts (body, counter nut and double clamping seal)
- Body and counter nut are nickel plated brass, clamping seals are EPDM rubber
- Colour: silver
- Temp. range: -45 °C to +105 °C (-49° F to +221° F)
- Protection class: IP68, NEMA 4x rated
- cULus Approved # E500099

APPLICATIONS

- Suitable for rail applications HL 1, HL 2 and HL 3 according EN 45545-2, R22 and R23, E15 and E30 according EN 45545-3 for wall and ceiling

SEALTITE®
FITTINGS



Thread NPT	Item ID	Clamping Range mm		Dimensions mm				Weight kg(lb)/100	Std. Pkg.
		S1+S2	S1	A	B	C	E		
1/2" NPT	738.712.2	4.0 - 6.5	6.5 - 8.5	36	14	17	24	4.6 (10.1)	10
1/2" NPT	738.716.2	6.0 - 9.0	9.0 - 12	39	14	22	24	5.1 (11.2)	10
3/4" NPT	738.718.2	6.0 - 9.0	9.0 - 12	40	14	22	30	6.8 (15.0)	5
3/4" NPT	738.720.2	10.5 - 14	14 - 17	42	14	27	30	7.3 (16.1)	5
1" NPT	738.723.2	10.5 - 14	14 - 17	44	16	27	38	10.9 (24.0)	5
1" NPT	738.726.2	15.5 - 20	20 - 24	46	16	35	38	11.8 (26.0)	5
1-1/4" NPT	738.730.2	15.5 - 20	20 - 24	46	16	35	48	17.5 (38.6)	2
1-1/4" NPT	738.735.2	22 - 27	27 - 31	48	16	43	48	18.5 (40.8)	2
1-1/2" NPT	738.738.2	22 - 27	27 - 31	50	18	43	55	23.5 (51.8)	2
1-1/2" NPT	738.740.2	29.5 - 35	35 - 40	64	18	53	55	30.0 (66.1)	2

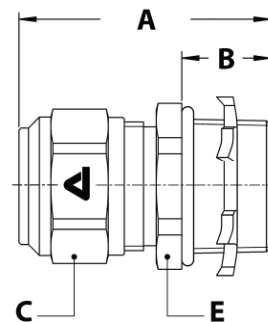

CABLE GLANDS

SEALTITE® STAINLESS STEEL AISI-316



DESCRIPTION

- Contain two clamping seals, one with a larger diameter seal into which a smaller diameter seal fits
- Seals are made of V0 rated EPDM rubber, tested and certified in compliance with EN45545-2, Hazard Level (HL1 / HL2 / HL3) for rail applications
- With larger diameter cable, larger diameter seal can be used on its own
- With smaller diameter cable, both clamping seals required with smaller inserted inside larger
- Both seals supplied as standard
- Double seal cable glands can also be used with braided cables for EMC applications by simply folding the end of the braid over the top of the clamping seal(s) before mounting
- cULus approved and have extra robust counter nut and an increased clamping strength

SPECIFICATIONS

- Stainless steel gland, male, consisting of 3 parts (body, counter nut and double clamping seal)
- Body and counter nut are stainless steel AISI-316, clamping seals are EPDM rubber
- Colour: silver
- Temp. range: -45 °C to +105 °C (-49° F to +221° F)
- Protection class: IP68, NEMA 4x rated
- cULus Approved # E500099

APPLICATIONS

- Suitable for rail applications HL 1, HL 2 and HL 3 according EN 45545-2, R22 and R23, E15 and E30 according EN 45545-3 for wall and ceiling

SEALTITE®
FITTINGS



Thread NPT	Item ID	Clamping Range mm		Dimensions mm				Weight kg(lb)/100	Std. Pkg.
		S1+S2	S1	A	B	C	E		
1/2" NPT	738.712.92	4.0 - 6.5	6.5 - 8.5	36	14	17	24	4.6 (10.1)	10
1/2" NPT	738.716.92	6.0 - 9.0	9.0 - 12	39	14	22	24	5.1 (11.2)	10
3/4" NPT	738.718.92	6.0 - 9.0	9.0 - 12	40	14	22	30	6.8 (15.0)	5
3/4" NPT	738.720.92	10.5 - 14	14 - 17	42	14	27	30	7.3 (16.1)	5
1" NPT	738.723.92	10.5 - 14	14 - 17	44	16	27	38	10.9 (24.0)	5
1" NPT	738.726.92	15.5 - 20	20 - 24	46	16	35	38	11.8 (26.0)	5
1-1/4" NPT	738.730.92	15.5 - 20	20 - 24	46	16	35	48	17.5 (38.6)	2
1-1/4" NPT	738.735.92	22 - 27	27 - 31	48	16	43	48	18.5 (40.8)	2
1-1/2" NPT	738.738.92	22 - 27	27 - 31	50	18	43	55	23.5 (51.8)	2
1-1/2" NPT	738.740.92	29.5 - 35	35 - 40	64	18	53	55	30.0 (66.1)	2

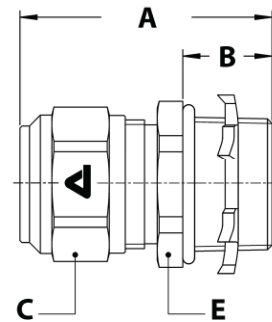

SPECIALTY FITTINGS

ANAMET SPECIALTY ATEX FITTINGS FOR IEC EX EXPLOSION-PROOF AREAS EXPLANATION OF IEC EX-ZONES

ANAMET's ATEX Fittings are based on the European IEC Ex directives.

Care must be taken when applying these to North American installations. Final responsibility of the suitability of the application is up to the customer and the local regulatory standards.

This is a brief explanation and comparison to North American standards.

LOCALIZATION OF GAS & DUST EX-ZONES

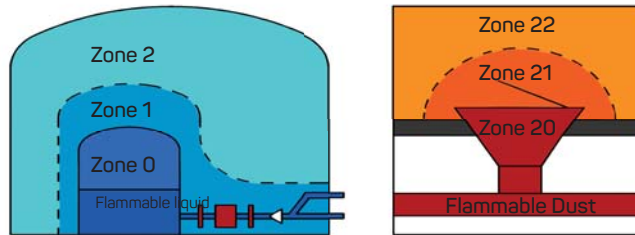

GROUP I - EQUIPMENT FOR USE IN MINING:

Hazardous Atmosphere	Risk	Zone	Category Equipment	ANAMET ATEX System allowed	Security level
Mine Gas, Combustible Dusts	Continuously or for long periods	0	I M1	No	Very high (also safe in case of 2 independent failures)
Mine Gas, Combustible Dusts	Occasionally	1	I M2	Yes	High (also safe in case of 1 failure)

GROUP II - EQUIPMENT FOR USE IN ALL OTHER EXPLOSIVE ATMOSPHERES:

Hazardous Atmosphere	Risk	Zone	Category Equipment	ANAMET ATEX System allowed	Security level
Gases, Vapours and Mists	Continuously or for long periods	0	II 1 G	No	Very high (also safe in case of 2 independent failures)
Gases, Vapours and Mists	Occasionally	1	II 2 G	Yes	High (also safe in case of 1 failure)
Gases, Vapours and Mists	Infrequently or for short periods	2	II 3 G	Yes	Normal (safe during normal functioning)
Dusts	Continuously or for long periods	20	II 1 D	No	Very high (also safe in case of 2 independent failures)
Dusts	Occasionally	21	II 2 D	Yes	High (also safe in case of 1 failure)
Dusts	Infrequently or for short periods	22	II 2 D II 3 G	Yes Yes	High (conducting Dusts) Normal (non-conducting Dusts)

DIFFERENCES BETWEEN EUROPEAN AND NORTH AMERICAN STANDARDS:

Region	Constant presence risk	Occasional presence risk	Presence risk only in case of failure
IEC/Europe	Zone 0	Zone 1	Zone 2
U.S./Canada	Division I		Division II

SPECIALTY FITTINGS

ANAMET SPECIALTY ATEX FITTINGS FOR IEC EX EXPLOSION-PROOF AREAS OVERVIEW OF ANAMET ATEX SYSTEM

Once you have determined that you can use the ANAMET ATEX fitting system, you need to confirm required part numbers.

This catalogue shows only the Barrier type fittings/adaptors for loose wires. This system includes a 2-part epoxy to create the barrier. There are also options for single cables, armoured or non-armoured available by special order from our European plant.

The 2-part epoxy is used to fill the internal space in the specially designed chamber. Instructions are included with each fitting which must be followed in order to ensure a proper barrier to the explosive substance. Once the epoxy is fully set, the fitting can then be assembled per the instructions.

SEALTITE®
FITTINGS



STEPS TO DETERMINING PART NUMBERS:

1. Straight or 90°
 - Straight - BXA fitting
 - 90° - BXC adaptor + Standard Fitting
2. Material
 - Nickel Plated Brass - xxx.xxx.0
 - Stainless steel AISI-316 - xxx.xxx.9



FOR LOOSE WIRES, EACH FITTING/
ADAPTOR IS CERTIFIED AND MARKED:

△RCN {type} {threadsize} CE 0080
I M2 / II GD / Ex d II C / Ex e II / Ex d I / 
Ex tD A 21 IP66 INERIS 06ATEX0014X

SPECIALTY FITTINGS

SEALTITE® ATEX FITTINGS NICKEL PLATED BRASS NPT/METRIC FITTINGS



DESCRIPTION

- Explosion Proof fittings for any SEALTITE® conduit (except CNP).
- IECEx-ATEX approved barrier fittings to provide seal around loose wires inside a SEALTITE® conduit.
- Barrier around loose wires created through a bi-compound epoxy sealing supplied with the fitting.
- IP67 on the conduit and IP66 between fitting and switch box.

SPECIFICATIONS

- Nickel Plated Brass with PTFE clamping ring.
- Separate 2 compound epoxy provided for creating barrier.
- Colour: silver
- Temp. range: -45°C to 105°C (-49°F to 221°F)
- IECEx-ATEX certified:
CE0080 I M2 / II 2 GD / Ex d II C / Ex e II / Ex d I / Ex tD A 21 IP66

APPLICATIONS

- Metallic and Type B non-metallic flexible conduit
- Explosion-proof areas where Zone system used
- Machinery for export to other countries where Zone system used

Note: For 90 degree versions, use
BXC adaptor + Standard Fitting

SEALTITE®
FITTINGS

BARRIER BXN NPT:



Trade Size	Item ID	Min. Int. Bore	Dimensions mm				KO Size NPT	Weight kg(lb)/100	Std. Pkg.
			A	B	C	E			
3/8"	827.012.0	10.4	45	18	26	25	1/2"	10.6 (23.4)	10
1/2"	827.016.0	13.8	47	18	30	28	1/2"	11.2 (24.7)	10
3/4"	827.020.0	18.5	48	18	35	34	3/4"	15.3 (33.7)	5
1"	827.026.0	23.8	54	22	45	43	1"	26.9 (59.3)	5
1-1/4"	827.035.0	31.9	59	22	55	52	1-1/4"	40.8 (89.9)	2

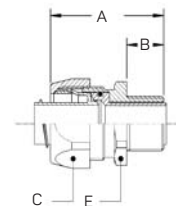

BARRIER BXN METRIC:



Trade Size	Thread ISO	Item ID	Min. Int. Bore	Dimensions mm				Weight kg(lb)/100	Std. Pkg.
				A	B	C	E		
3/8"	M16 x 1.5	826.016.0	10.4	45	18	26	25	8.2 (18.1)	10
1/2"	M20 x 1.5	826.020.0	13.8	47	18	30	28	11.0 (24.3)	10
3/4"	M25 x 1.5	826.025.0	18.5	48	18	35	34	14.9 (32.8)	5
1"	M32 x 1.5	826.032.0	23.8	54	22	45	43	25.8 (56.9)	5
1-1/4"	M40 x 1.5	826.040.0	31.9	59	22	55	52	39.1 (86.2)	2

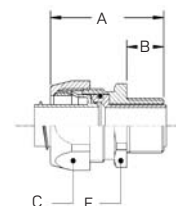

SPECIALTY FITTINGS

SEALTITE® ATEX FITTINGS STAINLESS STEEL AISI-316 NPT/METRIC FITTINGS



DESCRIPTION

- Explosion Proof fittings for any SEALTITE® conduit (except CNP)
- IECEx-ATEX approved barrier fittings to provide seal around loose wires inside a SEALTITE® conduit
- Barrier around loose wires created through a bi-compound epoxy sealing supplied with the fitting
- IP67 on the conduit and IP66 between fitting and switchbox
- Excellent corrosion resistance with AISI-316 Stainless Steel

SPECIFICATIONS

- AISI-316 Stainless Steel with PTFE clamping ring.
- Separate 2 compound epoxy provided for creating barrier.
- Colour: silver
- Temp. range: -45°C to 105°C (-49°F to 221°F)
- IECEx-ATEX certified:
CE0080 I M2 / II 2 GD / Ex d II C / Ex e II / Ex d I / Ex tD A 21 IP66

APPLICATIONS

- Metallic and Type B non-metallic flexible conduit
- Explosion-proof areas where Zone system used
- Machinery for export to other countries where Zone system used
- Superior corrosion resistance with 316 Stainless

Note: For 90 degree versions, use
BXC adaptor + Standard Fitting

SEALTITE®
FITTINGS

BARRIER BXA NPT:



Trade Size	Item ID	Min. Int. Bore	Dimensions mm				KO Size NPT	Weight kg(lb)/100	Std. Pkg.
			A	B	C	E			
3/8"	827.012.9	10.4	45	18	26	25	1/2"	10.6 (23.4)	10
1/2"	827.016.9	13.8	47	18	30	28	1/2"	11.2 (24.7)	10
3/4"	827.020.9	18.5	48	18	35	34	3/4"	15.3 (33.7)	5
1"	827.026.9	23.8	54	22	45	43	1"	26.9 (59.3)	5
1-1/4"	827.035.9	31.9	59	22	55	52	1-1/4"	40.8 (89.9)	2

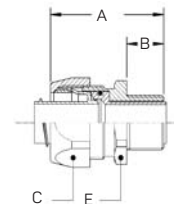

BARRIER BXA METRIC:



Trade Size	Thread ISO	Item ID	Min. Int. Bore	Dimensions mm				Weight kg(lb)/100	Std. Pkg.
				A	B	C	E		
3/8"	M16 x 1.5	826.016.0	10.4	45	18	26	25	8.2 (18.1)	10
1/2"	M20 x 1.5	827.020.0	13.8	47	18	30	28	11.0 (24.3)	10
3/4"	M25 x 1.5	827.025.0	18.5	48	18	35	34	14.9 (32.8)	5
1"	M32 x 1.5	827.032.0	23.8	54	22	45	43	25.8 (56.9)	5
1-1/4"	M40 x 1.5	827.040.0	31.9	59	22	55	52	39.1 (86.2)	2

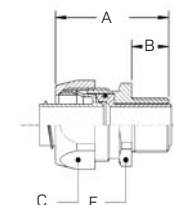

SPECIALTY FITTINGS

SEALTITE® ATEX FITTINGS NICKEL PLATED BRASS NPT/METRIC SWIVEL ADAPTORS



DESCRIPTION

- Explosion Proof adaptor to be used with standard SEALTITE® Fittings for 90 degree (SEALTITE® Fitting not included)
- IECEx-ATEX approved barrier fittings to provide seal around loose wires inside the adaptor
- Barrier around loose wires created through a bi-compound epoxy sealing supplied with the adaptor
- IP66 between fitting and switch box

SPECIFICATIONS

- Nickel Plated Brass Female Adaptor
- Separate 2 compound epoxy provided for creating barrier
- Colour: silver
- Temp. range: -45°C to 105°C (-49°F to 221°F)
- IECEx-ATEX certified:
CE0080 I M2 / II 2 GD / Ex d II C / Ex e II / Ex d I / Ex tD A 21 IP66

APPLICATIONS

- Female adaptor to standard SEALTITE® fitting.
- Explosion-proof areas where Zone system used
- Machinery for export to other countries where Zone system used

Note: For 90 degree versions, use BXC adaptor + Standard Fitting

SEALTITE®
FITTINGS

BARRIER BXC NPT:



Trade Size	Threads In/Out	Item ID	Min. Int. Bore	Dimensions mm					KO Size NPT	Weight kg(lb)/100	Std. Pkg.
				A	B	C	E	F			
1/2"	NPT 1/2"	827.116.0	13.9	66	18	26	30	28	1/2"	11.6 (24.7)	10
3/4"	NPT 3/4"	827.120.0	18.6	69	18	32	35	34	3/4"	23.1 (33.7)	5
1"	NPT 1"	827.126.0	24.5	76	22	38	45	43	1"	37.6 (59.3)	5
1-1/4"	NPT 1-1/4"	827.135.0	32.0	78	22	48	55	52	1-1/4"	54.5 (89.9)	2

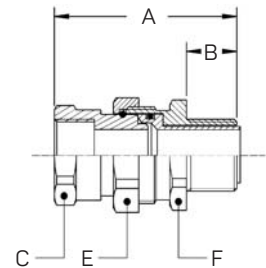

BARRIER BXC METRIC:



Trade Size	Thread In/Out	Item ID	Min. Int. Bore	Dimensions mm					Weight kg(lb)/100	Std. Pkg.
				A	B	C	E	F		
3/8"	M16 x 1.5	826.116.0	10.4	62	15	22	26	25	12.8 (18.1)	10
1/2"	M20 x 1.5	826.120.0	13.8	63	15	26	30	28	16.5 (24.3)	10
3/4"	M25 x 1.5	826.125.0	18.5	66	15	32	35	34	22.7 (32.8)	5
1"	M32 x 1.5	826.132.0	24.5	69	15	38	45	43	36.5 (56.9)	5
1-1/4"	M40 x 1.5	826.140.0	32.0	71	15	48	55	52	53.0 (86.2)	2

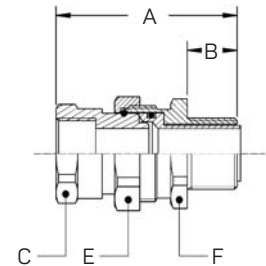

SPECIALTY FITTINGS

SEALTITE® ATEX FITTINGS STAINLESS STEEL AISI-316 NPT/METRIC SWIVEL ADAPTORS



DESCRIPTION

- Explosion Proof adaptor to be used with standard SEALTITE® Fittings for 90 degree (SEALTITE® Fitting not included)
- IECEx-ATEX approved barrier fittings to provide seal around loose wires inside the adaptor
- Barrier around loose wires created through a bi-compound epoxy sealing supplied with the adaptor
- IP66 between fitting and switch box
- Excellent corrosion resistance with AISI-316 Stainless Steel

SPECIFICATIONS

- AISI-316 Stainless Steel with PTFE clamping ring.
- Separate 2 compound epoxy provided for creating barrier.
- Colour: silver
- Temp. range: -45°C to 105°C (-49°F to 221°F)
- IECEx-ATEX certified:
CE0080 I M2 / II 2 GD / Ex d II C / Ex e II / Ex d I / Ex tD A 21 IP66

APPLICATIONS

- Female adaptor to standard SEALTITE® fitting.
- Explosion-proof areas where Zone system used
- Machinery for export to other countries where Zone system used
- Superior corrosion resistance with 316 Stainless

Note: For 90 degree versions, use
BXC adaptor + Standard Fitting

SEALTITE®
FITTINGS

BARRIER BXC NPT:



Trade Size	Threads In/Out	Item ID	Min. Int. Bore	Dimensions mm					KO Size NPT	Weight kg(lb)/100	Std. Pkg.
				A	B	C	E	F			
1/2"	NPT 1/2"	827.116.9	13.9	66	18	26	30	28	1/2"	11.6 (24.7)	10
3/4"	NPT 3/4"	827.120.9	18.6	69	18	32	35	34	3/4"	23.1 (33.7)	5
1"	NPT 1"	827.126.9	24.5	76	22	38	45	43	1"	37.6 (59.3)	5
1-1/4"	NPT 1-1/4"	827.135.9	32.0	78	22	48	55	52	1-1/4"	54.5 (89.9)	2

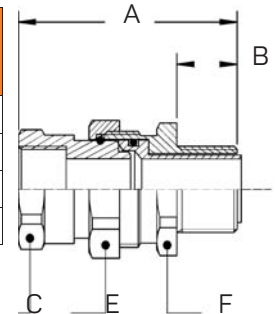

BARRIER BXC METRIC:



Trade Size	Thread In/Out	Item ID	Min. Int. Bore	Dimensions mm					Weight kg(lb)/100	Std. Pkg.
				A	B	C	E	F		
3/8"	M16 x 1.5	826.116.9	10.4	62	15	22	26	25	12.8 (18.1)	10
1/2"	M20 x 1.5	826.120.9	13.8	63	15	26	30	28	16.5 (24.3)	10
3/4"	M25 x 1.5	826.125.9	18.5	66	15	32	35	34	22.7 (32.8)	5
1"	M32 x 1.5	826.132.9	24.5	69	15	38	45	43	36.5 (56.9)	5
1-1/4"	M40 x 1.5	826.140.9	32.0	71	15	48	55	52	53.0 (86.2)	2

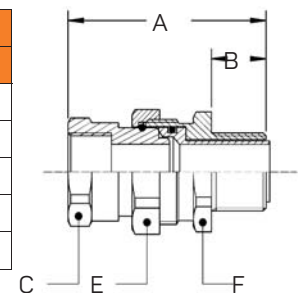



NON-METALLIC SEALTITE® SERIES

ANACONDA SEALTITE® is available in non-metallic, manufactured to the same high standard to meet industries requirements.

SEALTITE® fittings appropriate for these conduits are included with the catalogue pages as the fittings are unique to the conduits.



NON-METALLIC SEALTITE® SERIES

SEALTITE® CNP (TYPE A) NON-METALLIC ROBOTIC FLEXIBLE CONDUIT



DESCRIPTION

- Non-metallic Type A liquid-tight conduit
- Great for constantly flexing applications
- Good for abrasion and where physical abuse may exist
- Standard in orange
- Also available in grey by special order
- Uses Type A Connector only

SPECIFICATIONS

- Smooth inner PVC core with outer oil resistant PVC cover bonded together with nylon reinforcing braid
- Colour: orange
- Temperature range: -20°C to 60°C (-4°F to +140°F)
- UV (sunlight) resistant, Flame retardant
- Oil resistant
- CSA Approved #LL15275-10
- UL Approved #E75863

APPLICATIONS

- Automotive applications requiring continuous flexing
- Food machine applications where non-metallic and flexing required



Trade Size	Item ID	Std. Pkg. m (ft)	Inside Diameter Min	Outside Diameter		Bend Radius	Weight kg/m (lbs/cft)
				Min	Max		
3/8" (12)	38602	30 (100)	12.32 (0.485)	19.20 (0.755)	19.68 (0.775)	64 (2.5)	0.22 (15)
	38601	76 (250)					
1/2" (16)	38612	30 (100)	15.75 (0.620)	23.11 (0.910)	23.62 (0.930)	76 (3.0)	0.31 (21)
	38611	61 (200)					
	38613	243 (800)					
3/4" (21)	38622	30 (100)	20.70 (0.815)	29.21 (1.150)	29.72 (1.170)	102 (4.0)	0.45 (30)
	38621	53 (150)					
	38623	243 (800)					
1" (27)	38631	30 (100)	26.16 (1.030)	35.94 (1.415)	36.57 (1.440)	153 (6.0)	0.64 (43)
	38633	152 (500)					
1-1/4" (35)	38641	15 (50)	34.79 (1.370)	45.72 (1.800)	46.35 (1.825)	178 (7.0)	0.86 (58)
	38643	61 (100)					
1-1/2" (41)	38651	15 (50)	40.26 (1.585)	51.94 (2.045)	52.83 (2.080)	178 (7.0)	1.21 (81)
	38653	30 (100)					
2" (53)	38661	15 (50)	51.94 (2.045)	66.17 (2.605)	67.06 (2.640)	229 (9.0)	1.82 (122)
	38663	30 (100)					

All dimensions in mm (inches) unless stated

FITTINGS FINDER



PAGE 53

NON-METALLIC SEALTITE® SERIES

STNM FITTINGS

FITTINGS FOR CNP TYPE A CONDUIT (ONLY)



SPECIFICATIONS

- Zinc plated steel, 3-piece
- Colour: silver
- CSA Approved #065178
- UL approved #E11853
- Includes sealing ring, galvanized nut required to connect fitting to box
- Corrosion resistance, strength, durability
- -45°C to 105°C (49°F to 221°F)

DESCRIPTION

- STNM Series liquid tight connectors only approved for use with SEALTITE® CNP flexible conduit

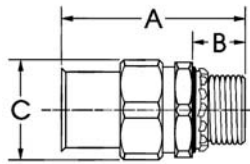

STRAIGHT



Trade Size	Item ID	Dimensions			KO Size NPT	Weight kg(lb)/Pkg	Std. Pkg.
		A	B	C			
3/8"	STNM38	54.76 (2.156)	15.09 (0.594)	29.36 (1.156)	1/2"	2.5 (5.6)	25
1/2"	STNM50	65.89 (2.594)	15.09 (0.594)	33.35 (1.313)	1/2"	3.7 (8.1)	25
3/4"	STNM75	65.89 (2.594)	15.09 (0.594)	41.27 (1.625)	3/4"	5.0 (11.0)	25
1"	STNM100	73.02 (2.875)	18.26 (0.719)	49.23 (1.938)	1"	1.5 (3.2)	5
1-1/4"	STNM125	86.51 (3.406)	19.05 (0.750)	61.11 (2.406)	1-1/4"	2.7 (6.0)	5
1-1/2"	STNM150	87.33 (3.438)	19.05 (0.750)	70.64 (2.781)	1-1/2"	1.4 (3.0)	2
2"	STNM200	100.81 (3.969)	19.05 (0.750)	85.73 (3.375)	2"	1.1 (2.4)	1

All dimensions in mm (inches) unless stated

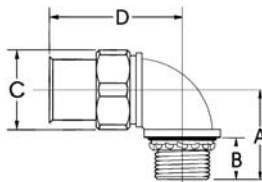

90 DEGREE



Trade Size	Item ID	Dimensions				KO Size NPT	Weight kg(lb)/Pkg	Std. Pkg.
		A	B	C	D			
3/8"	STNM9038	31.8 (1.25)	15.09 (0.594)	29.36 (1.156)	51.6 (2.03)	1/2"	3.4 (7.5)	25
1/2"	STNM9050	32.5 (1.28)	15.09 (0.594)	33.35 (1.313)	60.5 (2.38)	1/2"	4.3 (9.5)	25
3/4"	STNM9075	36.6 (1.44)	15.09 (0.594)	41.27 (1.625)	63.5 (2.5)	3/4"	2.5 (5.5)	10
1"	STNM90100	44.5 (1.75)	18.26 (0.719)	49.23 (1.938)	69.9 (2.75)	1"	1.9 (4.1)	5
1-1/4"	STNM90125	50.0 (1.97)	19.05 (0.750)	61.11 (2.406)	88.1 (3.47)	1-1/4"	3.5 (7.7)	5
1-1/2"	STNM90150	57.2 (2.25)	19.05 (0.750)	70.64 (2.781)	91.2 (3.59)	1-1/2"	1.8 (4.0)	2
2"	STNM90200	64.3 (2.53)	19.05 (0.750)	85.73 (3.375)	112.0 (4.41)	2"	1.4 (3.1)	1

All dimensions in mm (inches) unless stated

NON-METALLIC
SEALTITE®

NON-METALLIC SEALTITE® SERIES

SEALTITE® NMUA (TYPE B) NON-METALLIC FLEXIBLE CONDUIT



DESCRIPTION

- Non-metallic Type B liquid-tight conduit
- Designed for standard commercial and industrial applications
- Approved in US (per NEC) for direct burial applications
- Also available by special order in other colours (consult factory)
- Uses special non-metallic connectors for easy installation. Can also be used with standard liquid-tight connector
- Available in custom cut lengths

SPECIFICATIONS

- Co-extruded PVC conduit
- Colour: grey
- Temp. range: Dry: -18°C to +80°C (0°F to +176°F)
Wet: 60°C (+140°F) Oil 70°C (158°F)
- UV (sunlight) resistant
- Oil resistant
- CSA Approved #20817
- UL Approved #E211327

APPLICATIONS

- HVAC industry
- Commercial and industrial applications requiring UL & CSA approvals

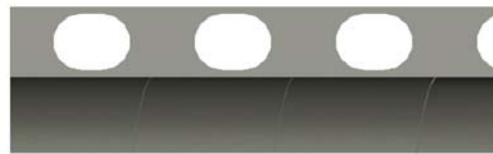

Rigid PVC Reinforced 3/8" through 2"



Trade Size	Item ID	Std. Pkg. m (ft)	Inside Diameter Min	Outside Diameter		Bend Radius	Weight kg/m (lbs/cft)
				Min	Max		
3/8" (12)	39302	30 (100)	12.29 (0.484)	17.53 (0.690)	18.03 (0.710)	51 (2.0)	0.17 (11)
1/2" (16)	39312	30 (100)	15.80 (0.622)	20.83 (0.820)	21.34 (0.840)	83 (3.3)	0.23 (15)
	39313	150 (500)					
	39314	300 (1000)					
3/4" (21)	39322	30 (100)	20.83 (0.820)	26.16 (1.030)	26.67 (1.050)	216 (4.5)	0.30 (20)
	39323	150 (500)					
1" (27)	39331	30 (100)	26.44 (1.041)	32.77 (1.290)	33.40 (1.315)	108 (6.5)	0.40 (27)
1-1/4" (35)	39341	15 (50)	35.05 (1.380)	41.40 (1.630)	42.16 (1.660)	203 (8.0)	0.53 (36)
1-1/2" (41)	39353	15 (50)	40.01 (1.575)	47.37 (1.865)	48.26 (1.900)	229 (9.0)	0.67 (45)
2" (53)	39361	15 (50)	51.31 (2.020)	59.44 (2.340)	60.33 (2.375)	282 (11.1)	1.00 (67)

All dimensions in mm (inches) unless stated

FITTINGS FINDER



PAGE 56

NON-METALLIC SEALTITE® SERIES

SEALTITE® NMEF (TYPE B) NON-METALLIC FLEXIBLE TUBING



DESCRIPTION

- Non-metallic Type B liquid-tight tubing
- Designed for OEM and industrial applications
- Uses special non-metallic connectors for easy installation. Can also be used with standard liquid-tight connector
- Available in custom cut lengths

SPECIFICATIONS

- Co-extruded PVC conduit
- Extra flexible
- Colour: black
- Temperature range: -18°C to 80°C (0°F to +176°F)
- UV (sunlight) resistant
- Oil resistant
- CSA Approved

APPLICATIONS

- OEM machine building
- Industrial applications where tight bend radius is required



Co-extruded special with smooth inner wall



Trade Size	Part Numbers	Item ID	Std. Pkg. m (ft)	Inside Diameter Min	Outside Diameter		Bend Radius	Weight kg/m (lbs/cft)
					Min	Max		
1/4" (10)	362.010.0*	N/A	30 (100)	9.78 (0.385)	14.22 (0.560)	14.61 (0.575)	20 (0.8)	0.12 (8)
3/8" (12)	362.012.0	39802	30 (100)	12.29 (0.484)	17.53 (0.690)	18.03 (0.710)	20 (0.8)	0.13 (9)
1/2" (16)	362.016.0	39812	30 (100)	15.80 (0.622)	20.83 (0.820)	21.34 (0.840)	23 (0.9)	0.17 (11)
3/4" (21)	362.020.0	39822	30 (100)	20.83 (0.820)	26.16 (1.030)	26.67 (1.050)	25 (1.0)	0.20 (13)
1" (27)	362.026.0	39831	30 (100)	26.44 (1.041)	32.77 (1.290)	33.40 (1.315)	36 (1.4)	0.30 (20)
1-1/4" (35)	362.035.0	39841	30 (100)	35.05 (1.380)	41.40 (1.630)	42.16 (1.660)	43 (1.7)	0.33 (22)
1-1/2" (41)	362.040.0	39853	15 (50)	40.01 (1.575)	47.37 (1.865)	48.26 (1.900)	51 (2.0)	0.40 (27)
2" (53)	362.050.0	39861	15 (50)	51.31 (2.020)	59.44 (2.340)	60.33 (2.375)	203 (8.0)	0.67 (45)

All dimensions in mm (inches) unless stated
*1/4" CSA pending approval

FITTINGS FINDER



PAGE 56

NON-METALLIC SEALTITE® SERIES

NON-METALLIC FITTINGS FITTINGS FOR NMUA/NMEF TYPE B ONLY



SPECIFICATIONS

- Colour: grey
- Temp. range: Dry: -18°C to +90°C (0°F to +194°F)
- UV (sunlight) resistant
- CSA Approved #620817
- UL Approved #E211327

ONE PIECE:

Trade Size	Item ID	A	B	C	KO Size NPT	Weight kg(lb)/Pkg	Std Pkg
Dimensions - STRAIGHT							
3/8"	NMSC38	34.29 (1.350)	13.59 (0.535)	31.52 (1.241)	1/2"	0.3 (0.7)	25
1/2"	NMSC50	36.58 (1.440)	13.59 (0.535)	31.34 (1.234)	1/2"	0.3 (0.7)	25
3/4"	NMSC75	38.48 (1.515)	13.59 (0.535)	38.61 (1.520)	3/4"	0.5 (1.1)	25
Dimensions - 90°							
3/8"	NMSC9038	53.34 (2.100)	13.59 (0.535)	62.03 (2.442)	1/2"	0.5 (1.1)	25
1/2"	NMSC9050	53.34 (2.100)	13.59 (0.535)	63.60 (2.504)	1/2"	0.5 (1.1)	25
3/4"	NMSC9075	62.36 (2.455)	13.59 (0.535)	71.91 (2.831)	3/4"	0.9 (2.0)	25

All dimensions in mm (inches) unless stated

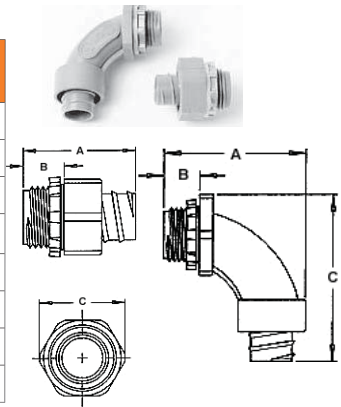

3 PIECE:

Trade Size	Item ID	A	B	C	KO Size NPT	Weight kg(lb)/Pkg	Std Pkg
Dimensions - STRAIGHT							
3/8"	NMLT38	36.20 (1.425)	13.59 (0.535)	36.09 (1.421)	1/2"	0.5 (1.1)	25
1/2"	NMLT50	36.20 (1.425)	13.59 (0.535)	36.09 (1.421)	1/2"	0.5 (1.1)	25
3/4"	NMLT75	37.46 (1.475)	13.97 (0.550)	40.21 (1.583)	3/4"	0.3 (0.7)	10
1"	NMLT100	49.53 (1.950)	17.02 (0.670)	48.89 (1.925)	1"	0.3 (0.7)	5
1-1/4"	NMLT125	56.31 (2.217)	16.38 (0.645)	61.42 (2.418)	1-1/4"	0.4 (0.9)	5
1-1/2"	NMLT150	54.74 (2.155)	16.76 (0.660)	68.58 (2.700)	1-1/2"	0.3 (0.7)	2
2"	NMLT200	60.96 (2.400)	17.02 (0.670)	85.34 (3.360)	2"	0.4 (0.9)	2
Dimensions - 90°							
3/8"	NMLT9038	59.06 (2.325)	13.20 (0.562)	61.98 (2.440)	1/2"	0.3 (0.7)	10
1/2"	NMLT9050	59.06 (2.325)	13.34 (0.562)	61.98 (2.440)	1/2"	0.3 (0.7)	10
3/4"	NMLT9075	64.77 (2.550)	12.95 (0.545)	72.14 (2.840)	3/4"	0.4 (0.9)	10
1"	NMLT90100	80.01 (3.150)	17.15 (0.630)	99.62 (3.922)	1"	0.4 (0.9)	5
1-1/4"	NMLT90125	112.77 (4.440)	17.78 (0.645)	118.11 (4.650)	1-1/4"	0.7 (1.5)	5
1-1/2"	NMLT90150	114.55 (4.510)	15.34 (0.660)	122.17 (4.810)	1-1/2"	0.4 (0.9)	2
2"	NMLT90200	128.57 (5.062)	17.27 (0.670)	135.13 (5.320)	2"	0.6 (1.3)	2

All dimensions in mm (inches) unless stated

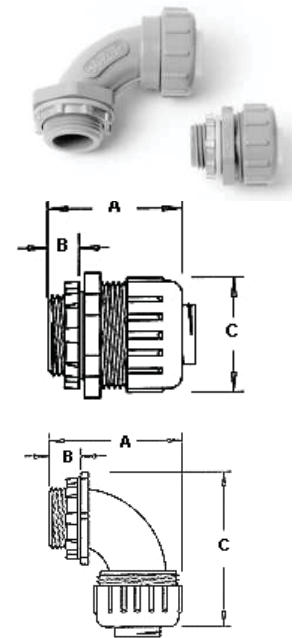

SWIVEL (0-90 DEGREE)

Trade Size	Item ID	A	B	C	D	KO Size NPT	Weight kg/Pkg	Std Pkg
Dimensions - Swivel 0-90°								
1/2"	NMLT5090	70.23 (2.765)	49.40 (1.945)	59.03 (2.324)	60.63 (2.387)	1/2"	0.4 (0.9)	10
3/4"	NMLT7590	89.92 (3.540)	65.79 (2.590)	82.55 (3.250)	71.63 (2.820)	3/4"	0.6 (1.3)	10

All dimensions in mm (inches) unless stated





FIRETECH FIRE PROTECTIVE PRODUCTS

FIRETECH solutions offer protection for cables and wires as well as hydraulic or air lines against various sources of intense heat. Depending on your industry and the application you require, these will withstand high temperatures, flames, molten splash, sparks, thermal attacks or aggressive chemicals.

The product range includes FIRETECH Sleeve, Wrap and Sheet products, able to withstand continuous temperatures up to +260C continuous and +1090C intermittently. Select the fitting type you require and the size of sleeve it must be compatible with to narrow down the selection and find the solution you are looking for.

FIRE PROTECTIVE PRODUCTS



FIRETECH SLEEVE/WRAP/TAPE/BLANKET:

- Flexible sleeving for protection of cables from high heat or flame
- Silicone based cover over a knitted glass fibre sleeve
- Superior temperature range for extreme environments
- Abrasion resistant—Ready for the worst environment
- The ultimate protection for harsh industrial applications
- Sleeve is UL Recognized in Canada and US



FIRETECH VCO:

- Any of the standard FIRETECH Sleeves can be slit and sewn with a high temperature hook-and-loop closure. This allows easy assembly and removal without disconnecting cables
- Ordered by required length. Consult factory for details



FIRETECH FITTINGS:

- ANAMET Stainless Steel fittings for FIRETECH come with a special internal collar to allow the FIRETECH Sleeve to be held firmly, creating a method of sealing the ends of the sleeve that is stronger than tape
- Allows interconnect into standard NPT applications and provides a cleaner finished installation



FIRETECH

FIRETECH SLEEVE



DESCRIPTION

- Solid braided glass fibre sleeving, with thick silicone cover
- Superior short-term flame protection and excellent temperature reduction
- Resistant to hydraulic fluids, lubricating oils and fuels
- Protects against molten splash, occasional flames, heat radiation, energy loss in piping and hoses
- Protects workers from burns

FIRETECH SLEEVE:

Item ID	Inside Diameter	Std. Pkg. ft	Weight kg/m (lbs/cft)
FTS-4-1	1/4"	100	3.20 (7.1)
FTS-4-5	1/4"	50	1.60 (3.5)
FTS-5-1	5/16"	100	3.60 (7.9)
FTS-5-5	5/16"	50	1.80 (4.0)
FTS-6-1	3/8"	100	4.50 (9.9)
FTS-6-5	3/8"	50	2.25 (5.0)
FTS-7-1	7/16"	100	5.00 (11.0)
FTS-7-5	7/16"	50	2.50 (5.5)
FTS-8-1	1/2"	100	5.90 (13.0)
FTS-8-5	1/2"	50	2.95 (6.5)
FTS-10-1	5/8"	100	6.40 (14.1)
FTS-10-5	5/8"	50	3.20 (7.1)
FTS-12-1	3/4"	100	7.70 (17.0)
FTS-12-5	3/4"	50	3.85 (8.5)
FTS-12-9	3/4"	1	0.07 (0.2)
FTS-14-1	7/8"	100	8.19 (18.1)
FTS-14-5	7/8"	50	4.09 (9.0)
FTS-16-1	1"	100	9.50 (20.9)
FTS-16-5	1"	50	4.75 (10.5)
FTS-18-1	1-1/8"	100	10.00 (22.1)
FTS-18-5	1-1/8"	50	5.00 (11.0)

SPECIFICATIONS

- Silicone over braided glass fibre sleeve
- cURus Recognized
- Colour: orange
- Temp. range:
 - +260°C (500°F) continuous,
 - +1090°C (2000°F) for 15-20 min.
 - +1650°C (3000°F) for 15-30 sec.
- UL Recognized for Canada and US #E321462 (Sleeve only)

APPLICATIONS

- Extreme duty applications
- Extreme heat or flame

Item ID	Inside Diameter	Std. Pkg. ft	Weight kg/m (lbs/cft)
FTS-20-1	1-1/4"	100	11.80 (26.0)
FTS-20-5	1-1/4"	50	5.90 (13.0)
FTS-22-1	1-3/8"	100	13.60 (30.0)
FTS-22-5	1-3/8"	50	6.80 (15.0)
FTS-24-1	1-1/2"	100	15.50 (34.2)
FTS-24-5	1-1/2"	50	7.75 (17.1)
FTS-26-1	1-5/8"	100	15.90 (35.1)
FTS-26-5	1-5/8"	50	7.95 (17.5)
FTS-28-1	1-3/4"	100	16.39 (36.2)
FTS-28-5	1-3/4"	50	8.19 (18.1)
FTS-32-1	2"	100	18.20 (40.1)
FTS-32-5	2"	50	9.10 (20.1)
FTS-36-1	2-1/4"	100	19.50 (43.0)
FTS-36-5	2-1/4"	50	9.75 (21.5)
FTS-40-1	2-1/2"	100	20.90 (46.1)
FTS-40-5	2-1/2"	50	10.45 (23.0)
FTS-44-1	2-3/4"	100	23.20 (51.2)
FTS-44-5	2-3/4"	50	11.60 (25.6)
FTS-48-1	3"	100	26.40 (58.2)
FTS-48-5	3"	50	13.20 (29.1)
FTS-52-1	3-1/4"	100	31.40 (69.2)
FTS-52-5	3-1/4"	50	15.70 (34.6)
FTS-56-1	3-1/2"	100	32.70 (72.1)
FTS-56-5	3-1/2"	50	16.35 (36.1)
FTS-60-1	3-3/4"	100	33.60 (74.1)
FTS-60-5	3-3/4"	50	16.80 (37.0)
FTS-64-1	4"	100	35.00 (77.2)
FTS-64-5	4"	50	17.50 (38.6)

All dimensions in mm (inches) unless stated

FITTINGS FINDER



PAGE 61



FIRETECH

FIRETECH BLANKET



DESCRIPTION

- FireTech is the ultimate heat protection for cables
- Solid braided glass fibre sleeving, with thick silicone cover
- Superior short-term flame protection and excellent temperature reduction
- Resistant to hydraulic fluids, lubricating oils and fuels
- Protects against molten splash, occasional flames, heat radiation, energy loss in piping and hoses
- Protects workers from burns

SPECIFICATIONS

- Silicone over fibreglass sheet
- Colour: orange
- Temp. range:
 - +260°C (500°F) continuous,
 - +1090°C (2000°F) for 15-20 min.
 - +1650°C (3000°F) for 15-30 sec.

APPLICATIONS

- Extreme duty applications
- Extreme heat or flame

FIRETECH BLANKET:



Item ID	Size	Std. Pkg. ft	Weight kg (lb) per pkg
FSH-36-2	36" 2 sides	1	0.36 (0.8)
FSH-40-1	40" 1 side	1	0.60 (1.3)
FSH-60-2	60" 2 sides	1	0.91 (2.0)
FTS-5-5	5/16"	50	1.80 (4.0)



FIRETECH

FIRETECH WRAP



DESCRIPTION

- FireTech is the ultimate heat protection for cables
- Solid braided glass fibre sleeving, with thick silicone cover
- Superior short-term flame protection and excellent temperature reduction
- Resistant to hydraulic fluids, lubricating oils and fuels
- Protects against molten splash, occasional flames, heat radiation, energy loss in piping and hoses
- Protects workers from burns

SPECIFICATIONS

- Silicone over fibreglass sheet
- Colour: orange
- Temp. range:
 - +260°C (500°F) continuous,
 - +1090°C (2000°F) for 15-20 min.
 - +1650°C (3000°F) for 15-30 sec.

APPLICATIONS

- Extreme duty applications
- Extreme heat or flame

FIRETECH WRAP:



Item ID	Size	Std. Pkg. ft	Weight kg (lb) per pkg
FTW-1-1	1"	100	2.70 (6.0)
FTW-1-5	1"	50	1.35 (3.0)
FTW-2-1	2"	100	4.50 (9.9)
FTW-2-5	2"	50	2.25 (5.0)
FTW-3-1	3"	100	7.30 (16.1)
FTW-3-5	3"	50	3.65 (8.0)
FTW-4-1	4"	100	9.50 (20.9)
FTW-4-5	4"	50	4.75 (10.5)
FTW-5-1	5"	100	11.80 (26.0)
FTW-5-5	5"	50	5.90 (13.0)



FIRETECH

FIRETECH TAPE



SPECIFICATIONS

- Silicone over fibreglass sheet
- Colour: orange
- Temperature: +246°C (475°F) max.

APPLICATIONS

- Extreme duty applications
- Extreme heat or flame

DESCRIPTION

- FireTech is the ultimate heat protection for cables
- Solid braided glass fibre sleeving, with thick silicone cover
- Superior short-term flame protection and excellent temperature reduction
- Resistant to hydraulic fluids, lubricating oils and fuels
- Protects against molten splash, occasional flames, heat radiation, energy loss in piping and hoses
- Protects workers from burns

FIRETECH TAPE:



Item ID	W x L x Thickness	Weight kg (lb)	Std. Pkg.
FTT-16	25.4 x 10.9m x 0.51mm (1" x 432" x .020")	0.14 (0.31)	Per roll
FTT-24	38.1mm x 10.9m x 1.52mm (1-1/2" x 432" x .060")	0.45 (0.99)	Per roll



FIRETECH

FIRETECH FITTINGS



SPECIFICATIONS

- Stainless steel AISI-304 fitting with brass adaptor for FireTech sleeve.
- Colour: Metal
- Temp. range: -45°C to 105°C (-49°F to 221°F)

APPLICATIONS

- For use with FireTech Sleeve
- Excellent corrosion resistance, mostly used in the off-shore, chemical and food industry

DESCRIPTION

- Stainless steel AISI-304 SEALTITE® fittings have a special adaptor for use with FireTech Sleeve
- FireTech is the ultimate heat protection for cables

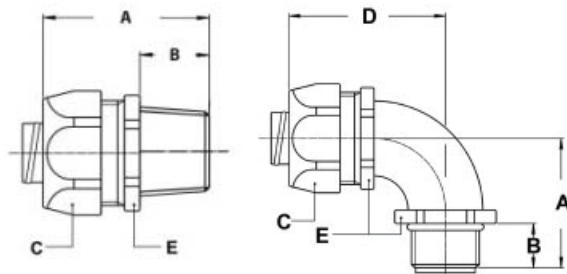

FIRETECH FITTINGS:



Item ID	Conduit Size	Std. Pkg. (pieces)	Dimensions					KO Size
			A	B	C	D	E	
Dimensions - STRAIGHT								
SSFT38	3/8"	1	37 (1.45)	13 (0.51)	27 (1.06)	-	24 (0.94)	1/2"
SSFT50	1/2"	1	37 (1.45)	13 (0.51)	30 (1.18)	-	27 (1.06)	1/2"
SSFT75	3/4"	1	40 (1.57)	15 (0.59)	36 (1.41)	-	36 (1.41)	3/4"
SSFT100	1"	1	46 (1.81)	15 (0.59)	46 (1.81)	-	46 (1.81)	1"
Dimensions - 90°								
SSFT9038	3/8"	1	36 (1.41)	13 (0.51)	27 (1.06)	43 (1.69)	22 (0.86)	1/2"
SSFT9050	1/2"	1	36 (1.41)	13 (0.51)	30 (1.18)	43 (1.69)	27 (1.06)	1/2"
SSFT9075	3/4"	1	43 (1.69)	15 (0.59)	36 (1.41)	48 (1.88)	33 (1.29)	3/4"
SSFT90100	1"	1	48 (1.88)	15 (0.59)	46 (1.81)	59 (2.32)	42 (1.65)	1"

All dimensions in mm (inches) unless stated



BASALTJACKET

FIRETECH



DESCRIPTION

- Knitted sleeving from of 100% basalt yarn
- Provides excellent thermal protection
- Durable, knitted design is flexible for easy assembly over tubes and pipes with bends and flanges
- Heavy duty construction, more than 15% denser than market average, minimizes snagging and tearing of sleeve during assembly
- Available in precut lengths or continuous lengths of up to 150 metres (492 feet), depending on size
- User can cut the sleeves to exact lengths
- When installed on vehicle exhaust tubes and pipes, sleeve facilitates retention of high temperatures as gases flow through exhaust system

SPECIFICATIONS

- Construction: knitted basalt yarn.
- Chemical resistance: resists most acids and alkalis and unaffected by most bleaches and solvents
- Temperature: -260°C to +750°C (-436°F to 1382°F) continuous, +980°C (1796°F) short term
- Colour: gold

APPLICATIONS

- Automotive, heavy-duty truck, and bus exhaust tubes and pipes
- High temperature industrial applications to protect hoses and cables off-shore
- Chemical and food industry



BASALTJACKET:



Trade Size	Size mm	Type	Diameter		Standard Carton		Small Carton		Reel	
			Inside mm (in)	Outside mm (in)	Length m (ft)	Item Number	Length m (ft)	Item Number	Length m (ft)	Item Number
1"	25	BJ-16	25 (1)	30 (1.2)	152 (499)	347.625.6	30 (98)	347.625.3	-	-
1-1/2"	38	BJ-24	38 (1.5)	43 (1.7)	91 (299)	347.638.6	30 (98)	347.638.3	-	-
2"	51	BJ-32	51 (2)	56 (2.2)	76 (249)	347.651.6	30 (98)	347.651.3	-	-
2-1/2"	64	BJ-40	64 (2.5)	69 (2.7)	68 (223)	347.664.6	30 (98)	347.664.3	305 (1001)	347.664.8
3"	76	BJ-48	76 (3)	81 (3.2)	61 (200)	347.676.6	30 (98)	347.676.3	259 (850)	347.676.8
3-1/2"	89	BJ-56	89 (3.5)	94 (3.7)	53 (174)	347.689.6	30 (98)	347.689.3	228 (748)	347.689.8
4"	102	BJ-64	102 (4)	107 (4.2)	50 (164)	347.695.6	30 (98)	347.695.3	198 (650)	347.695.8
5"	127	BJ-80	127 (5)	132 (5.2)	38 (125)	347.698.6	30 (98)	347.698.3	152 (499)	347.698.8





ANA-QUICK® NYLON NYLON FLEXIBLE CONDUIT AND ACCESSORIES

ANA-QUICK® nylon conduit solutions provide a complete system to protect wires and cables in OEM applications like rail and robotics. ANAMET's integrated solution protects up to IP68 and can be used in continuous flexing applications. The rail version of this conduit meets the NFPA 130 and EN 45545 requirements of the rail industry to protect passengers. When fittings include optional sealing o-rings and washers, protection to IP68 can be attained.

ANA-QUICK® QUICK SELECTION GUIDE

1. WHAT CONDUIT MATERIAL IS NEEDED?

PA6

PA12

AC6L
LIGHT WALL

PAGE 71

AC6S
STANDARD WALL

PAGE 72

AC6R
MEDIUM WALL

PAGE 73

AC12S
STANDARD WALL

PAGE 74

2. WHAT TYPE OF FITTING IS REQUIRED?

NPT THREADS

STRAIGHT 90°

PAGE 75

METRIC THREADS

STRAIGHT 90°

PAGE 76

METRIC METALLIC
THREADS

STRAIGHT 90°

PAGE 77

FLANGE FITTING

90°

PAGE 80

3. ARE ANY ACCESSORIES REQUIRED?

SUPPORT WITH LID

PAGE 81

DISTRIBUTORS

T Y

PAGE 82

LOCK NUTS

NYLON NICKEL-
PLATED

PAGE 83

4. NEED A HIGHER IP RATING?

IP68/IP69

O-RINGS SEALING
WASHERS

PAGE 84

IP68: Total dust protection,
Protection against long periods
of immersion under water

IP69: Highest protection
available against dust and
water

ANA-QUICK®: THE ANAMET SOLUTION FOR HIGH FLEXING OEM APPLICATIONS



PA6 AND PA12 CONDUIT

TRANSPORTATION APPLICATIONS:

Light weight, plus easy installation and tight bend radius

OEM MACHINE/EQUIPMENT BUILDERS:

Tight bend radius, and high flexing applications for cat-track and robotics

FEATURES:

- Quick installation, easy connection without tools
- Labour savings
- Lightweight and highly flexible
- Ideal for tight tend radius wiring and sensor installations
- Halogen free polyamide construction for added safety
- Temperature range: -40°C to +120°C
- IP68 and IP69(K) ingress protection when matched with correct fitting
- Resistant to alcohol, grease, fuels, mineral spirits, and moisture

APPLICATIONS:

- In-line and end-of-line packaging systems
- OEM equipment sub-assemblies
- Passenger rail vehicles
- Mining vehicles
- Injection molding machines
- Machine tools
- Ice surface cleaners
- Solar panel arrays
- Fibre optics
- Medical equipment
- Robotics
- Harnesses

ANA-QUICK® CONDUIT SYSTEM FEATURES

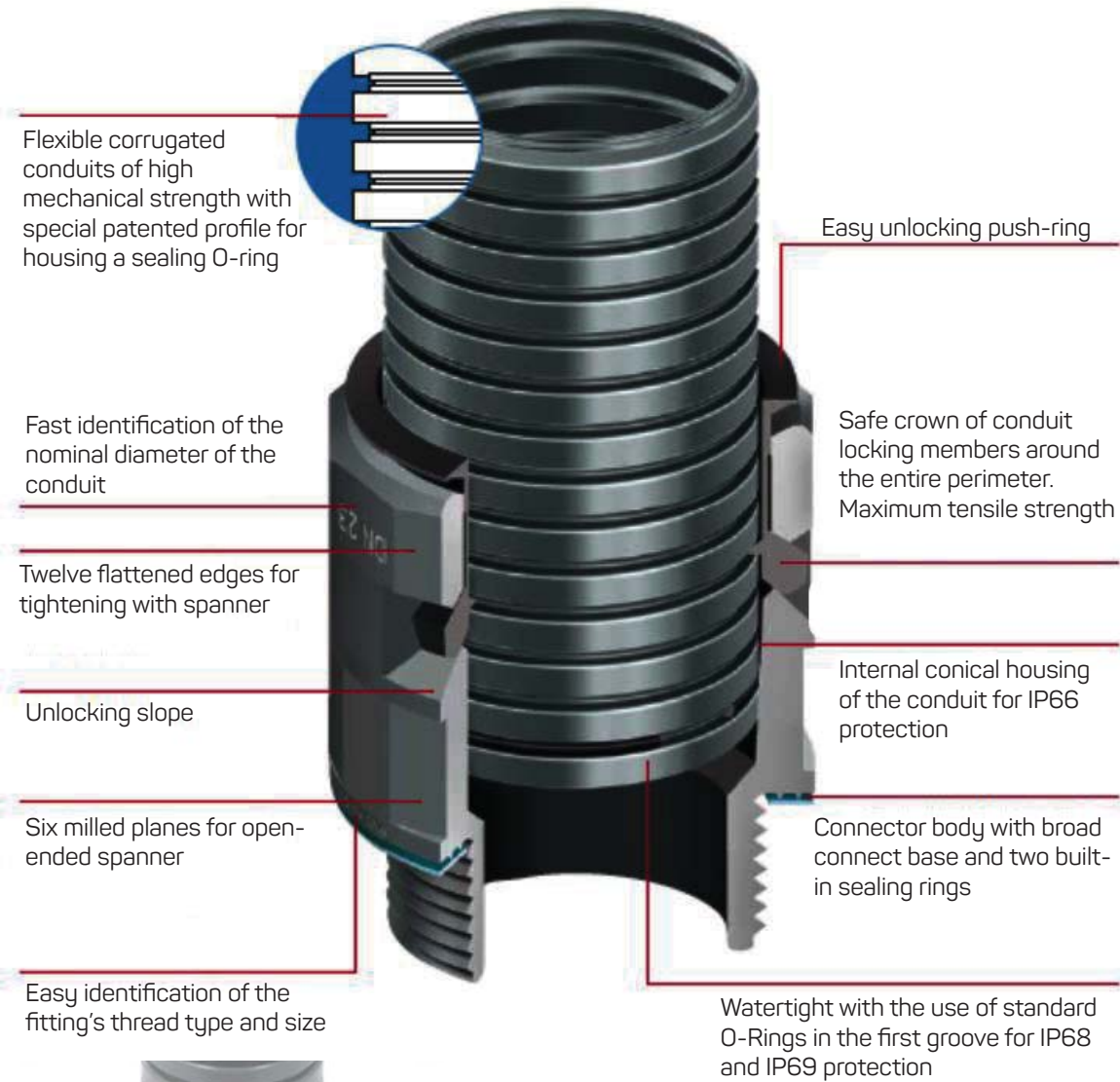





360° Protection

Watertight:
Protection up to IP68/IP69

Easy:
Quick assembly and removal

Secure:
Conduit locking around its entire perimeter

ANA-QUICK CONDUIT SPECIFICATIONS

Type	Material	Wall	Size Range	Flexibility	Temperature	IP Rating	Crush	Approvals
AC6L	PA6 Nylon	Light	7 - 48	High	-40°C +105°C	IP68	Medium	
AC6S	PA6 Nylon	Standard	7 - 48	Medium	-40°C +105°C	IP68	High	
AC6R	PA6 Nylon	Medium	7 - 48	High	-10°C +105°C	IP68	Medium	
AC12S	PA12 Nylon	Standard	7 - 95	Very High	-50°C +90°C	IP68	Medium	

ANA-QUICK Conduit System is CE approved and based on the EN 50086 Classifications. The table below summarizes the classification of the two types of ANA-QUICK Conduit.

ANA-QUICK	AC6L	AC6S	AC6R	AC12S
Compression Resistance	**	***	**	**
Impact Resistance	**	***	**	**
Min. Temperature	-40° C	-40° C	-40° C	-50° C
Max. Temperature	+105° C	+105° C	+105° C	+90° C
Bending Resistance	Very Flexible	Very Flexible	Very Flexible	Extremely Flexible
IP Rating	IP68	IP68	IP68	IP68
Corrosion Resistance	Very High	Very High	Very High	Very High
Flame Resistance	Self-Extinguishing	Self-Extinguishing	Self-Extinguishing	Self-Extinguishing
UL94	HB	V2	V0	V2

The ANA-QUICK SYSTEM is based on the European standard of conduit sizes, which are referred to as NW sizes. The reference chart below converts those into the matching trade sizes used in North America.

Trade Size	Inside Diameter Range	Equivalent	
		ANA-QUICK	Int. Diameter
1/4"	.345-.260"	NM 7.5	.264"
5/16"	.390-.405"	NM 10	.390"
3/8"	.484-.504"	NW 12	.480"
1/2"	.622-.642"	NW 17	.654"
3/4"	.820-.840"	NW 23	.913"
1"	1.0411-1.056"	NW 29	1.142"
1-1/4"	1.380-1.410"	NW 36	1.417"
1-1/2"	1.575-1.610"	NW 48	1.878"

CONDUIT SYSTEM AND ACCESSORIES PART NUMBER SCHEME

AC6L - 17B

CONDUITS:
AC__-____ (page 71-74)

Colour:
B Black

Profile (AC Series):
 6L Nylon 6 Thin Wall
 6S Nylon 6 Standard Wall
 6R Nylon 6 Medium Wall
 12S Nylon 12 Standard Wall

NW Trade Size (ID):

07	7.5mm	1/4"
10	10mm	5/16"
12	12mm	3/8"
17	17mm	1/2"
23	23mm	3/4"
29	29mm	1"
36	36mm	1-1/4"
48	48mm	1-1/2"

ARNS - 07B

ACCESSORIES:
AR__-____ (page 81-84)

Colour:
B Black
M Metallic

Accessories (AR Series):
 NY Nylon "Y" Connector
 NT Nylon "T" Connector
 NS Nylon Support with Lid
 NL Nylon Lock Nut
 SL Nickel Plated Lock Nut
 OR O-Rings
 SW Sealing Washers

NW Trade Size (ID):

07	7.5mm	1/4"
10	10mm	5/16"
12	12mm	3/8"
17	17mm	1/2"
23	23mm	3/4"
29	29mm	1"
36	36mm	1-1/4"
48	48mm	1-1/2"

ANA-QUICK® NYLON SERIES

PA6 CONDUIT - EXTRA FLEXIBLE



DESCRIPTION:

For insulation, mechanical protection and environmental preservation of cables in the electrical installation of machinery, industrial equipment and telecommunications.



AC6L conduits are corrugated polyamide conduits specially designed for machine tool applications that require protection for cables. AC6L is a standard wall conduit, which is UL Recognized.

SPECIFICATIONS:

- Made of specially modified polyamide (PA6)
- Special patented profile for housing the O-Ring sealing to provide a higher IP protection
- Free of halogen, phosphorous and cadmium
- Self-extinguishing (HB according to UL94)
- Temp. range: -40°C to +105°C (150°C short term)
- UV resistant
- Colour: black

APPLICATIONS:

- Machine building, switch cabinets, movable machinery, rail vehicles, commercial vehicles, construction machinery.

CONDUIT: AC6L - LIGHT WALL



Size NW	Item ID	Diameter mm (inches)		Bend Radius mm (inches)	Package m
		Inside	Outside		
7 (1/4")	AC6L-07B	6.3 (0.248)	10.0 (0.394)	15 (1.2)	50
10 (5/16")	AC6L-10B	9.7 (0.382)	13.0 (0.512)	20 (11.8)	50
12 (3/8")	AC6L-12B	12.2 (0.480)	15.8 (0.622)	30 (1.2)	50
17 (1/2")	AC6L-17B	16.8 (0.661)	21.2 (0.835)	40 (5.9)	50
23 (3/4")	AC6L-23B	22.6 (0.890)	28.5 (1.122)	55 (11.8)	50
29 (1")	AC6L-29B	28.3 (1.114)	34.5 (1.358)	65 (1.2)	50
36 (1-1/4")	AC6L-36B	36.3 (1.429)	42.5 (1.673)	80 (5.9)	30
48 (1-1/2")	AC6L-48B	47.4 (1.866)	54.5 (2.146)	95 (0.6)	30

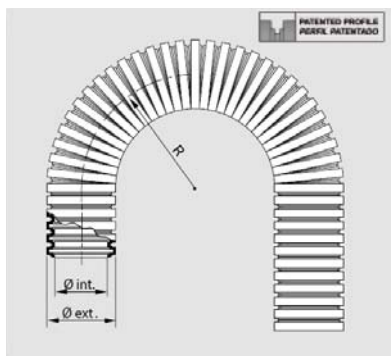

FITTINGS FINDER



PAGE 75-80

ANA-QUICK® NYLON SERIES

PA6 CONDUIT - EXTRA FLEXIBLE



DESCRIPTION:

For insulation, mechanical protection and environmental preservation of cables in the electrical installation of machinery, industrial equipment, railway and telecommunications.



AC6S conduits are corrugated polyamide conduits specially designed for machine tool applications that require protection for cables. AC6S is a standard wall conduit, which is UL Recognized.

SPECIFICATIONS:

- Construction: Corrugated conduit from Modified Polyamide (PA6), halogen free
- Flame Properties: Class V2, UL-94, self-extinguishing
- Resistant: Alcohol, greases, fuels, mineral spirits, weak bases, weak acids, and UV
- Temp. range: -40°C to +105C (intermittent to 150°C)
- Colour: black
- Approvals: UL Recognized, RoHS Compliant

APPLICATIONS:

- Machine building, switch cabinets, movable machinery
- Rail vehicles, commercial vehicles, construction machinery
- For high mechanical strength

CONDUIT: AC6S - STANDARD WALL



Size NW	Item ID	Diameter mm (inches)		Bend Radius mm (inches)	Package m
		Inside	Outside		
7 (1/4")	AC6S-07B	6.2 (0.244)	10.0 (0.394)	20 (1.2)	50
10 (5/16")	AC6S-10B	9.6 (0.378)	13.0 (0.512)	25 (1.18)	50
12 (3/8")	AC6S-12B	12.0 (0.472)	15.7 (0.618)	30 (1.2)	50
17 (1/2")	AC6S-17B	16.5 (0.650)	21.2 (0.835)	50 (5.9)	50
23 (3/4")	AC6S-23B	22.3 (0.878)	28.5 (1.122)	60 (1.18)	50
29 (1")	AC6S-29B	28.2 (1.110)	34.5 (1.358)	60 (1.2)	50
36 (1-1/4")	AC6S-36B	36.0 (1.417)	42.5 (1.673)	70 (5.9)	30
48 (1-1/2")	AC6S-48B	47.1 (1.854)	54.5 (2.146)	100 (0.6)	30

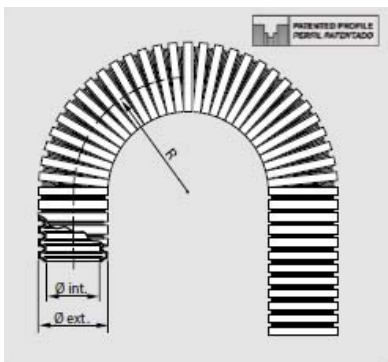

ANA-QUICK® NYLON SERIES

PA6 CONDUIT - EXTRA FLEXIBLE



DESCRIPTION:

For insulation, mechanical protection and environmental preservation of cables in the electrical installation specially in passenger areas of railway coaches, railway tunnels, or underground stations and general installations with special fire and smoke requirements.



AC6R conduits are corrugated polyamide conduits specially designed for machine tool applications that require protection for cables. AC6R is a standard wall conduit, which is UL Recognized.

SPECIFICATIONS:

- Construction: Corrugated conduit from Modified Polyamide (PA6), halogen free
- Flame Properties: Class VO, UL-94, self-extinguishing
- Resistant: Alcohol, greases, fuels, mineral spirits, weak bases, weak acids, and UV
- Temp. range: -40°C to +105°C (intermittent to 150°C)
- Colour: black
- Approvals: UL Recognized, RoHS Compliant, ASTM-162, ASTM-662, SMP-800C

APPLICATIONS:

- Machine building, switch cabinets, movable machinery
- Rail vehicles, commercial vehicles, construction machinery
- For high mechanical strength

CONDUIT: AC6R - MEDIUM WALL



Size NW	Item ID	Diameter mm (inches)		Bend Radius mm (inches)	Package m
		Inside	Outside		
7 (1/4")	AC6R-07B	6.4 (0.252)	10.0 (0.394)	15 (1.2)	50
10 (5/16")	AC6R-10B	9.8 (0.386)	13.0 (0.512)	20 (11.8)	50
12 (3/8")	AC6R-12B	12.3 (0.484)	15.8 (0.622)	30 (1.2)	50
17 (1/2")	AC6R-17B	16.9 (0.665)	21.2 (0.835)	40 (5.9)	50
23 (3/4")	AC6R-23B	22.7 (0.894)	28.5 (1.122)	55 (11.8)	50
29 (1")	AC6R-29B	28.4 (1.118)	34.5 (1.358)	65 (1.2)	50
36 (1-1/4")	AC6R-36B	36.4 (1.433)	42.5 (1.673)	80 (5.9)	30
48 (1-1/2")	AC6R-48B	47.5 (1.870)	54.5 (2.146)	95 (0.6)	30

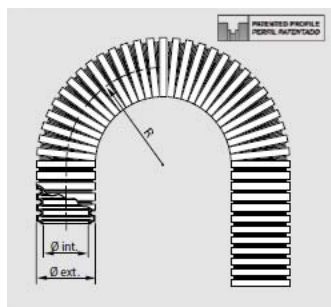

FITTINGS FINDER



PAGE 75-80

ANA-QUICK® NYLON SERIES

PA 12 CONDUITS - EXTRA FLEXIBLE



DESCRIPTION:

For insulation, mechanical protection and environmental preservation of cables in dynamic applications. They offer high flexibility and an outstanding resistance to abrasion.



AC12S conduits are corrugated polyamide conduits specially designed for machine tool applications that require protection for cables. AC12S is a standard wall conduit.

SPECIFICATIONS:

- Construction: Corrugated conduit from Modified Polyamide (PA12), halogen free
- Flame Properties: Class V2, UL-94, self-extinguishing
- Resistant: Alcohol, greases, fuels, mineral spirits, weak bases, and weak acids
- Temp. range: -50°C to +90°C (intermittent to 140°C)
- Colour: black
- Approvals: RoHS Compliant

APPLICATIONS:

- Machine building, switch cabinets, movable machinery
- Rail vehicles, commercial vehicles, construction machinery
- For high mechanical strength
- Robotic dress packages

CONDUIT: AC12S - STANDARD



Size NW	Item ID	Diameter mm (inches)		Bend Radius mm (inches)		Package m
		Inside Diameter	Outside Diameter	Static	Dynamic	
7 (1/4")	AC12S-07B	6.5 (.256)	10.0 (0.394)	20 (1.2)	45 (1.2)	50
10 (5/16")	AC12S-10B	9.5 (.374)	13.0 (0.512)	30 (11.8)	60 (11.8)	50
12 (3/8")	AC12S-12B	12.0 (0.472)	15.8 (0.622)	35 (1.2)	75 (1.2)	50
17 (1/2")	AC12S-17B	16.4 (0.646)	21.2 (0.835)	40 (5.9)	90 (5.9)	50
23 (3/4")	AC12S-23B	22.6 (0.890)	28.5 (1.122)	55 (11.8)	115 (11.8)	50
29 (1")	AC12S-29B	28.1 (1.106)	34.5 (1.358)	70 (1.2)	140 (1.2)	50
36 (1-1/4")	AC12S-36B	36.0 (1.417)	42.5 (1.673)	80 (5.9)	200 (5.9)	30
48 (1-1/2")	AC12S-48B	47.5 (1.870)	54.5 (2.146)	100 (0.6)	230 (0.6)	30

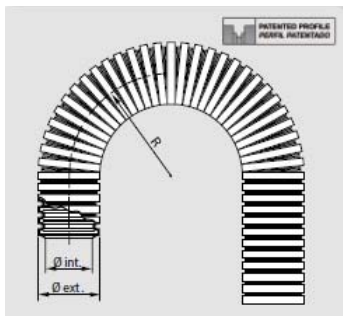

ANA-QUICK® Nylon

FITTINGS FINDER



PAGE 75-80

ANA-QUICK® FITTINGS SPECIFICATIONS



METRIC



NPT THREADS



METRIC METALLIC

SPECIFICATIONS:

- Construction: Specially modified polyamide (PA6), halogen, phosphorus, and cadmium free
- Flame Properties: Self-extinguishing
- Resistance: Shock, alcohol, greases, fuels, mineral spirits, weak bases, and weak acids
- IP Rating: IP66 (IP68 & IP69 options)
- Temp. range: -40°C to +105°C
- Colour: black
- Approval: cURus Recognized

APPLICATIONS:

- All ANA-QUICK conduit types
- Vibration areas
- Wash down areas (when assembled with O-rings)

DESCRIPTION:

Standard ANA-QUICK Fittings are made from PA6 Nylon and are rated IP66. These fittings are designed to fit all ANA-QUICK conduit types and can be disassembled from the conduit after they have been assembled without the use of tools. They are notable for their high tensile strength and tightness.



HOW TO REMOVE CONDUIT FROM THE FITTING

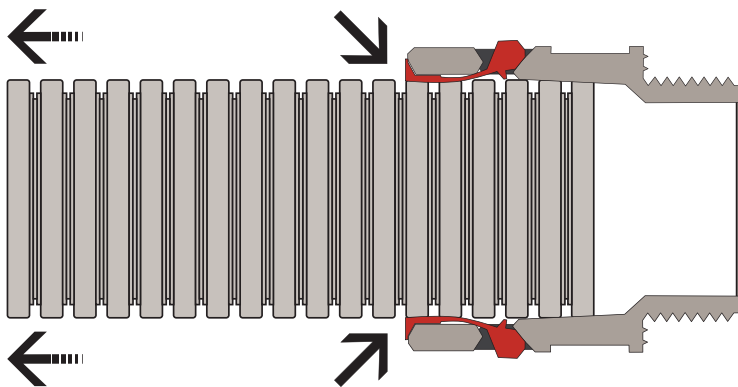

Press the conduit and the release ring against the body of the connector, and then, keeping the release ring pressed, pull the conduit outwards, twisting a little.

ANA-QUICK® FITTINGS PART NUMBER SCHEME

AFNO-17N050B

FITTINGS:
AF__-____ (page 77-80)

Material:

N Nylon threads
M Metal threads

Colour:

B Black

Profile (AC Series):

0 Straight Fitting
9 90° Fitting
F 90° Flange

Thread Size

NPT:
050 1/2"
075 3/4"
100 1"
125 1-1/4"
150 1-1/2"
200 2"

NW Trade Size (ID):

07	7.5mm	1/4"
10	10mm	5/16"
12	12mm	3/8"
17	17mm	1/2"
23	23mm	3/4"
29	29mm	1"
36	36mm	1-1/4"
48	48mm	1-1/2"

Fitting Thread:

N NPT
M Metric

Metric:

M12
M16
M20
M25
M32
M40

Please Note: Refer to specific product page for details and specifications. Not all part numbers that can be created by this part number scheme are currently available from ANAMET. Part numbers specifically shown in this catalogue are currently available.

Lock nuts are NOT included with fittings.

ANA-QUICK® NYLON SERIES FITTINGS

FITTINGS WITH NPT THREADS



SPECIFICATIONS:

- Made of specially modified polyamide (PA6)
- Free of halogen, phosphorus and cadmium
- Self-extinguishing
- Shock-resistant
- Temp. range: -40°C to +105°C (150°C short term)
- IP66 protection (IP68/IP69 with O-Ring and Sealing Washer)
- "Easy-click" quick assembly and removal of the conduit without tools
- Colour: black

DESCRIPTION:

Straight and 90° fittings with male metric thread according to EN 60423 connector for fixing the ends of flexible corrugated conduits to the cable entries on control panels, terminal boxes on electric motors, etc., in accordance with standard EN 60204 (Safety of Machinery). They are notable for their high tensile strength and tightness.

NPT THREAD STRAIGHT FITTINGS



Size NW	Item ID	Thread Size	Dimensions mm (inches)				Std. Pkg.
			Ø INT	A	C	D	
17	AFN0-17N050B	NPT ½	14.5 (0.571)	46 (1.811)	31 (1.220)	30 (1.181)	100
23	AFN0-23N075B	NPT ¾	19.5 (0.768)	50 (1.969)	37 (1.457)	37 (1.457)	50
29	AFN0-29N100B	NPT 1	25.0 (0.984)	53 (2.087)	46 (1.811)	46 (1.811)	30
36	AFN0-36N125B	NPT 1¼	34.5 (1.358)	59 (2.323)	54 (2.126)	54 (2.126)	20
48	AFN0-48N150B	NPT 1½	40.5 (1.595)	60 (2.362)	69 (2.717)	69 (2.717)	10

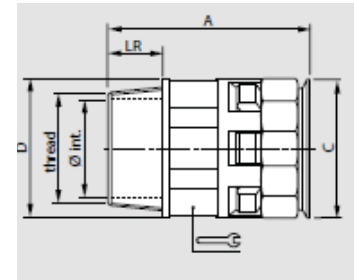

NPT THREAD 90° FITTINGS



Size NW	Item ID	Thread Size	Dimensions mm (inches)				Std. Pkg.
			Ø INT	A	B	C	
17	AFN9-17N050B	NPT ½	14.5 (0.571)	47 (1.850)	58 (2.284)	30 (1.181)	50
23	AFN9-23N075B	NPT ¾	19.5 (0.768)	55 (2.165)	66 (2.599)	36 (1.417)	30
29	AFN9-29N100B	NPT 1	25.0 (0.984)	67 (2.638)	76 (2.992)	45 (1.772)	10
36	AFN9-36N125B	NPT 1¼	34.5 (1.358)	78 (3.071)	89 (3.504)	54 (2.126)	10
48	AFN9-48N150B	NPT 1½	40.5 (1.595)	91 (3.583)	103 (4.055)	68 (2.677)	5
48	AFN9-48N200B	NPT 2	50.0 (1.969)	91 (3.583)	104 (4.095)	68 (2.677)	5

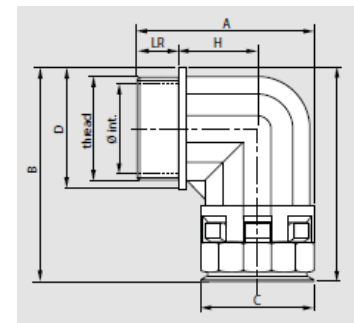

Lock nuts are NOT included with fittings.

ANA-QUICK® Nylon

ANA-QUICK® NYLON SERIES FITTINGS

FITTINGS WITH METRIC THREADS



SPECIFICATIONS:

- Made of specially modified polyamide (PA6)
- Free of halogen, phosphorus and cadmium
- Self-extinguishing
- Shock-resistant
- Temp. range: -40°C to +105°C (150°C short term)
- IP66 protection (IP68/IP69 with O-ring and Sealing Washer)
- “Easy-click” quick assembly and removal of the conduit without tools
- Colour: black

DESCRIPTION:

Straight and 90° fittings with male metric thread according to EN 60423 connector for fixing the ends of flexible corrugated conduits to the cable entries on control panels, terminal boxes on electric motors, etc., in accordance with standard EN 60204 (Safety of Machinery). They are notable for their high tensile strength and tightness.

METRIC THREAD STRAIGHT FITTINGS



Size NW	Item ID	Thread Size	Dimensions mm (inches)				Std. Pkg.
			Ø INT	A	C	D	
7	AFN0-07M12B	M12x1.5	6.5 (0.256)	35 (1.378)	19 (0.748)	17 (0.669)	100
10	AFN0-10M16B	M16x1.5	10.0 (0.394)	37 (1.457)	21 (0.827)	21 (0.827)	100
12	AFN0-12M20B	M20x1.5	14.0 (0.551)	37 (1.457)	26 (1.024)	25 (0.984)	100
17	AFN0-17M20B	M20x1.5	14.5 (0.571)	44 (1.732)	31 (1.221)	30 (1.181)	100
23	AFN0-23N25B	M25x1.5	18.5 (0.729)	48 (1.890)	37 (1.457)	37 (1.457)	50
29	AFN0-29N32B	M32x1.5	25.5 (1.004)	52 (2.048)	46 (1.811)	46 (1.811)	30
36	AFN0-36M40B	M40x1.5	32.0 (1.260)	60 (2.362)	54 (2.126)	54 (2.126)	20
48	AFN0-48M50B	M48x1.5	42.0 (1.654)	61 (2.402)	69 (2.717)	69 (2.717)	10

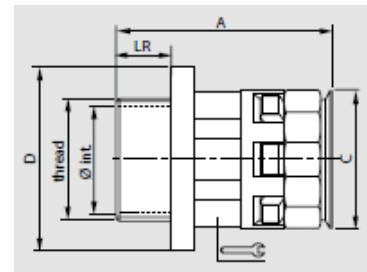

METRIC THREAD 90° FITTINGS



Size NW	Item ID	Thread Size	Dimensions mm (inches)				Std. Pkg.
			Ø int	A	B	C	
12	AFN9-12M20B	M20x1.5	12.3 (0.484)	39 (1.535)	45 (1.772)	25 (0.984)	50
17	AFN9-17M20B	M20x1.5	14.5 (0.571)	45 (1.772)	58 (2.284)	30 (1.181)	50
23	AFN9-23M25B	M25x1.5	18.5 (0.728)	53 (2.087)	66 (2.599)	36 (1.417)	30
29	AFN9-29M32B	M32x1.5	25.5 (1.004)	66 (2.599)	76 (2.992)	45 (1.772)	20
36	AFN9-36M40B	M40x1.5	32.0 (1.260)	79 (3.110)	89 (3.504)	54 (2.126)	10
48	AFN9-48M50B	M50x1.5	42.0 (1.654)	92 (3.622)	103 (4.055)	68 (2.677)	10

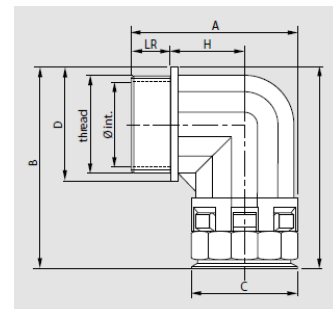

Lock nuts are NOT included with fittings.

ANA-QUICK® NYLON SERIES FITTINGS

FITTINGS WITH METRIC METALLIC THREADS



DESCRIPTION:

With similar characteristics to the standard polyamide connectors, the male metal metric thread connectors are notable for their higher mechanical resistance, being recommended in the most severe conditions. An internal plastic wall on the metal insert avoids a direct contact with the cables. Specially used in railway industry.

SPECIFICATIONS:

- Made of specially modified polyamide (PA6)
- Nickel-plated brass thread
- Free of halogen, phosphorus and cadmium
- Self-extinguishing
- Shock-resistant
- Temp. range: -40°C to +105°C (150°C short term)
- IP66 protection (IP68/IP69 with O-Ring and Sealing Washer)
- "Easy-click" quick assembly and removal of the conduit without tools
- Colour: black

METRIC METALLIC THREAD STRAIGHT FITTINGS



Size NW	Item ID	Thread Size	Dimensions mm (inches)				Std. Pkg.
			Ø INT	A	C	D	
12	AFM0-12M20B	M20x1.5	14.5 (0.571)	43 (1.693)	25 (0.984)	29 (1.142)	50
17	AFM0-17M20B	M20x1.5	14.5 (0.571)	47 (1.850)	30 (1.181)	29 (1.142)	30
23	AFM0-23M25B	M25x1.5	18.8 (0.740)	55 (2.165)	36 (1.417)	35 (1.378)	30
29	AFM0-29M32B	M32x1.5	25.8 (1.016)	56 (2.205)	44 (1.732)	43 (1.693)	20
36	AFM0-36M40B	M40x1.5	32.2 (1.268)	61 (2.402)	52 (2.048)	55 (2.165)	10
48	AFM0-48M50B	M50x1.5	42.0 (1.654)	62 (2.441)	69 (2.717)	67 (2.638)	10

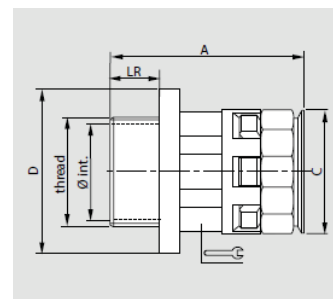

METRIC METALLIC THREAD 90° FITTINGS



Size NW	Item ID	Thread Size	Dimensions mm (inches)				Std. Pkg.
			Ø int	A	C	D	
12	AFM9-12M20B	M20x1.5	14.1 (0.555)	44 (1.732)	47 (1.850)	25 (0.984)	50
17	AFM9-17M20B	M20x1.5	14.1 (0.555)	50 (1.969)	58 (2.284)	30 (1.181)	50
23	AFM9-23M25B	M25x1.5	18.5 (0.728)	57 (2.244)	65 (2.560)	36 (1.417)	30
29	AFM9-29M32B	M32x1.5	25.5 (1.004)	69 (2.717)	75 (2.958)	45 (1.772)	10
36	AFM9-36M40B	M40x1.5	32.0 (1.260)	79 (3.110)	92 (3.622)	54 (2.126)	10
48	AFM9-48M50B	M50x1.5	42.3 (1.665)	94 (3.701)	102 (4.016)	68 (2.677)	5

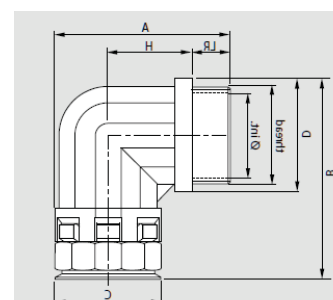

Lock nuts are NOT included with fittings.

ANA-QUICK® Nylon

ANA-QUICK® NYLON SERIES FITTINGS

FLANGE 90° FITTING



DESCRIPTION:

The flange connectors are useful for fixing the ends of flexible corrugated conduits to 90° cable entries in the interior of machines and for installations according to EN 60204 (Safety of Machinery). They are notable for their high tensile strength and tightness.

SPECIFICATIONS:

- Made of specially modified polyamide (PA6)
- Free of halogen, phosphorus and cadmium
- Self-extinguishing
- Shock-resistant
- Temp. range: -40°C to +105°C (150°C short term)
- IP66 protection (IP68/IP69 with O-Ring and Sealing Washer)
- "Easy-click" quick assembly and removal of the conduit without tools
- Colour: black

FLANGE 90° FITTINGS

Size NW	Item ID	Dimensions mm (inches)					Std. Pkg.
		A	B	C	D	E	
17	AFNF-17B	44 (1.732)	68 (2.677)	29 (1.142)	24 (0.945)	48 (1.890)	50
23	AFNF-23B	53 (2.087)	82 (3.228)	37 (1.457)	26 (1.024)	57 (2.244)	30
29	AFNF-29B	60 (2.3622)	89 (3.504)	45 (1.772)	32 (1.260)	66 (2.598)	10
36	AFNF-36B	70 (2.756)	104 (4.095)	53 (2.087)	38 (1.496)	76 (2.992)	10
48	AFNF-48B	80 (3.150)	118 (4.646)	67 (2.638)	46 (1.811)	82 (3.228)	5

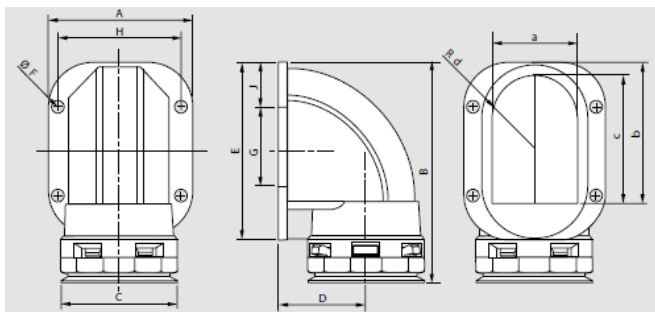

Lock nuts are NOT included with fittings.

ANA-QUICK® ACCESSORIES

SUPPORT WITH LID



SPECIFICATIONS:

- Made of specially modified polyamide (PA6)
- Free of halogen, phosphorus and cadmium
- Self-extinguishing
- Shock-resistant
- With integrated lid
- Temp. range: -40°C to +105°C (150°C short term)

DESCRIPTION:

Supports with integrated lid for securing sections of corrugated conduits between the various parts of the electrical installation. With conduit entry guide.

Specially designed for demanding securing situations, (e.g. on ceilings)

SUPPORTS WITH INTEGRATED LIDS

Size NW	Item ID	Dimensions mm (inches)				Metric m	Std. Pkg.
		A	B	C	H		
7	ARNS-07NB	22 (0.866)	17 (0.669)	20 (0.787)	13 (0.512)	M4	100
10	ARNS-10NB	25 (0.984)	22 (0.866)	20 (0.787)	13 (0.512)	M5	100
12	ARNS-12NB	27 (1.063)	25 (0.984)	20 (0.787)	13 (0.512)	M5	100
17	ARNS-17NB	33 (1.299)	31 (1.221)	20 (0.787)	19 (0.748)	M5	100
23	ARNS-23NB	42 (1.654)	40 (1.575)	20 (0.787)	23 (0.906)	M6	50
29	ARNS-29NB	47 (1.850)	46 (1.811)	20 (0.787)	26 (1.024)	M6	30
36	ARNS-36NB	56 (2.205)	56 (2.205)	20 (0.787)	31 (1.221)	M6	20
48	ARNS-48NB	70 (2.756)	70 (2.756)	20 (0.787)	39 (1.535)	M6	10

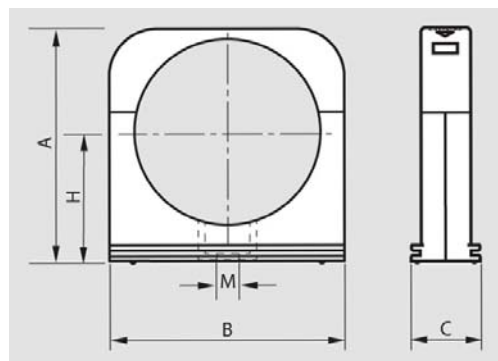

ANA-QUICK® ACCESSORIES

"T" AND "Y" DISTRIBUTORS



SPECIFICATIONS:

- Made of specially modified polyamide (PA6)
- Free of halogen, phosphorus and cadmium
- Self-extinguishing
- Shock-resistant
- Temp. range: -40°C to +105°C (150° short term)
- IP66 protection. IP68/IP69 with O-rings
- "Easy-click" quick assembly and removal of the conduit without tools

DESCRIPTION:

ANA-QUICK 'T' and 'Y' Distributors can be used to split the conduit for connection of multiple points. These connections are shipped split, for easy assembly to the conduit. They come in various combinations to join different sizes of conduits.

"Y" DISTRIBUTOR

Item ID	For Conduit Size			Std. Pkg.
	A	B	C	
ARNY-171212	NW 17	NW 12	NW 12	1
ARNY-231717	NW 23	NW 17	NW 17	1
ARNY-292323	NW 29	NW 23	NW 23	1
ARNY-362929	NW 36	NW 29	NW 29	1
ARNY-483636	NW 48	NW 36	NW 36	1

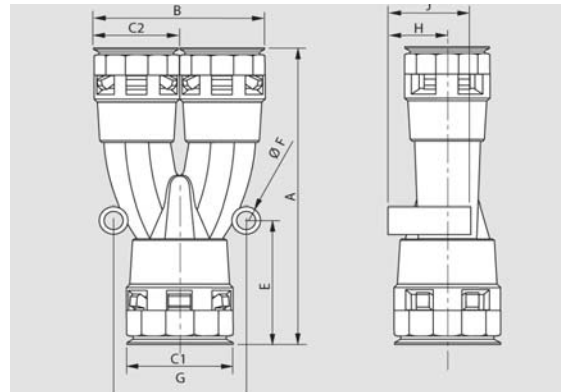

"T" DISTRIBUTOR

Item ID	For Conduit Size			Std. Pkg.
	A	B	C	
ARNT-101010	NW 10	NW 10	NW 10	1
ARNT-121212	NW 12	NW 12	NW 12	1
ARNT-171717	NW 17	NW 17	NW 17	1
ARNT-232323	NW 23	NW 23	NW 23	1
ARNT-292929	NW 29	NW 29	NW 29	1
ARNT-363636	NW 36	NW 36	NW 36	1

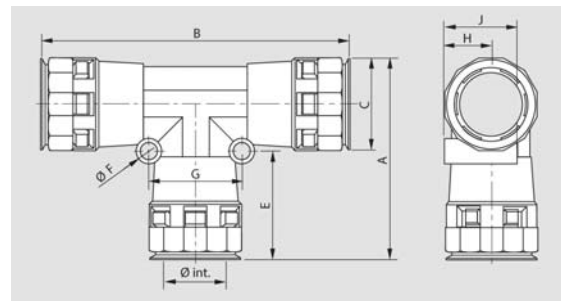

ANA-QUICK® ACCESSORIES

LOCK NUTS



DESCRIPTION:

Polyamide hexagonal metric thread lock nuts for securing connectors in thin or not threaded walls of boxes and cabinets. Made of specially modified polyamide (PA6). Free of halogen, phosphorus, and cadmium. Self-extinguishing and shock-resistant. Temperature range of -40°C to +105°C (+150°C short term).



DESCRIPTION:

Nickel plated brass hexagonal female thread lock nuts for securing connectors and elbows in thin or not threaded walls of boxes and cabinets. Maximum temperature is +800°C.

NYLON LOCK NUT

Item ID	Thread Size	Dimensions mm (inches)			Std. Pkg.
		A	B	C	
ATNL-M12B	M12x1.5	18 (0.709)	17 (0.669)	5 (0.197)	100
ATNL-M16B	M16x1.5	24 (0.945)	22 (0.866)	5 (0.197)	100
ATNL-M20B	M20x1.5	28 (1.102)	26 (1.024)	6 (0.236)	100
ATNL-M25B	M25x1.5	35 (1.378)	32 (1.260)	6 (0.236)	100
ATNL-M32B	M32x1.5	47 (1.850)	42 (1.654)	7 (0.276)	100
ATNL-M40B	M40x1.5	57 (2.244)	52 (2.047)	7 (0.276)	50
ATNL-M50B	M50x1.5	68 (2.677)	62 (2.441)	9 (0.354)	50

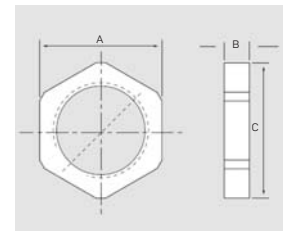

NICKEL PLATED BRASS LOCK NUT

Item ID	Thread Size	Dimensions mm (inches)			Std. Pkg.
		A	B	C	
ATSL-M12M	M12x1.5	17 (0.669)	15 (0.591)	3 (0.118)	100
ATSL-M16M	M16x1.5	22 (0.866)	20 (0.787)	3 (0.118)	100
ATSL-M20M	M20x2.5	27 (1.063)	24 (0.945)	3.5 (0.138)	100
ATSL-M25M	M25x1.5	33 (1.299)	30 (1.181)	3.5 (0.138)	100
ATSL-M32M	M32x1.5	38 (1.496)	35 (1.378)	4.5 (0.177)	100
ATSL-M40M	M40x1.5	49 (1.929)	45 (1.772)	4.5 (0.177)	50
ATSL-M50M	M50x1.5	60 (2.362)	55 (2.165)	5.5 (0.217)	20

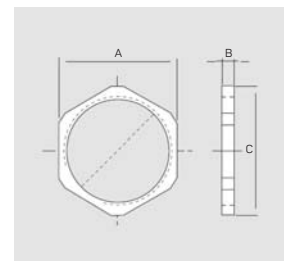

ANA-QUICK® ACCESSORIES

O-RINGS



DESCRIPTION:

O-rings are to be placed on the first groove at the end of ANA-QUICK corrugated conduits in order to obtain a degree of protection up to IP68/IP69 between the conduit and the connector. Temperature range is -30°C to +100°C.

O-RINGS

Item ID	ND	Dimensions mm (inches)		Std. Pkg.
		A	B	
AROR-07B	7	6.35 (0.250)	1.3 (0.051)	100
AROR-10B	10	10.0 (0.394)	1.3 (0.051)	100
AROR-12B	12	11.5 (0.453)	1.5 (0.059)	100
AROR-17B	17	16.0 (0.630)	1.8 (0.071)	100
AROR-23B	23	22.0 (0.866)	2.0 (0.079)	50
AROR-29B	29	29.0 (1.142)	2.0 (0.079)	30
AROR-36B	36	34.0 (1.339)	2.3 (0.091)	20
AROR-48B	48	44.6 (1.756)	2.4 (0.095)	10

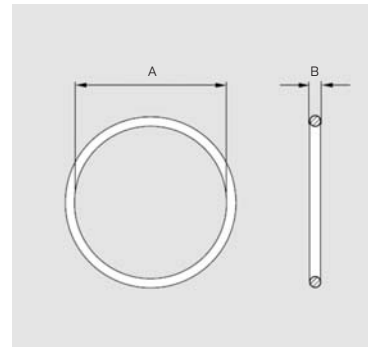

SEALING WASHERS



DESCRIPTION:

Sealing Washers allow the entry of cables into housings (boxes, cabinets, etc.) with a degree of protection up to IP68 or IP69 between the housing and the connector's base. Temperature range is -40°C to +200°.

SEALING WASHERS

Item ID	For Thread	Dimensions mm (inches)			Std. Pkg.
		A	B	C	
ARSW-M12M	M12x1.5	12 (0.472)	18 (0.709)	1.5 (0.059)	100
ARSW-M16M	M16x1.5	16 (0.630)	22 (0.866)	1.5 (0.059)	100
ARSW-M20M	M20x1.5	20 (0.787)	27 (1.063)	1.5 (0.059)	100
ARSW-M25M	M25x1.5	25 (0.984)	35 (1.378)	1.5 (0.059)	50
ARSW-M32M	M32x1.5	32 (1.260)	43 (1.693)	1.5 (0.059)	30
ARSW-M40M	M40x1.5	40 (1.579)	55 (2.165)	1.5 (0.059)	20
ARSW-M50M	M50x1.5	50 (1.969)	69 (2.717)	1.5 (0.059)	10

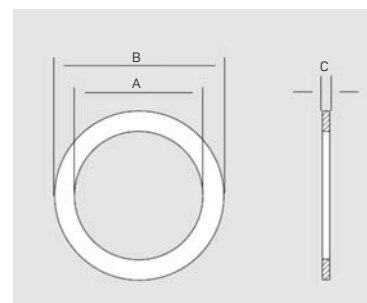

ANA-QUICK® HOW TO ACHIEVE AN IP68/IP69 RATING

FIRST, INSERT AN O-RING ON THE FIRST GROOVE OF THE CONDUIT, THEN A SEALING WASHER ON THE THREAD AT THE BASE OF THE CONNECTOR.

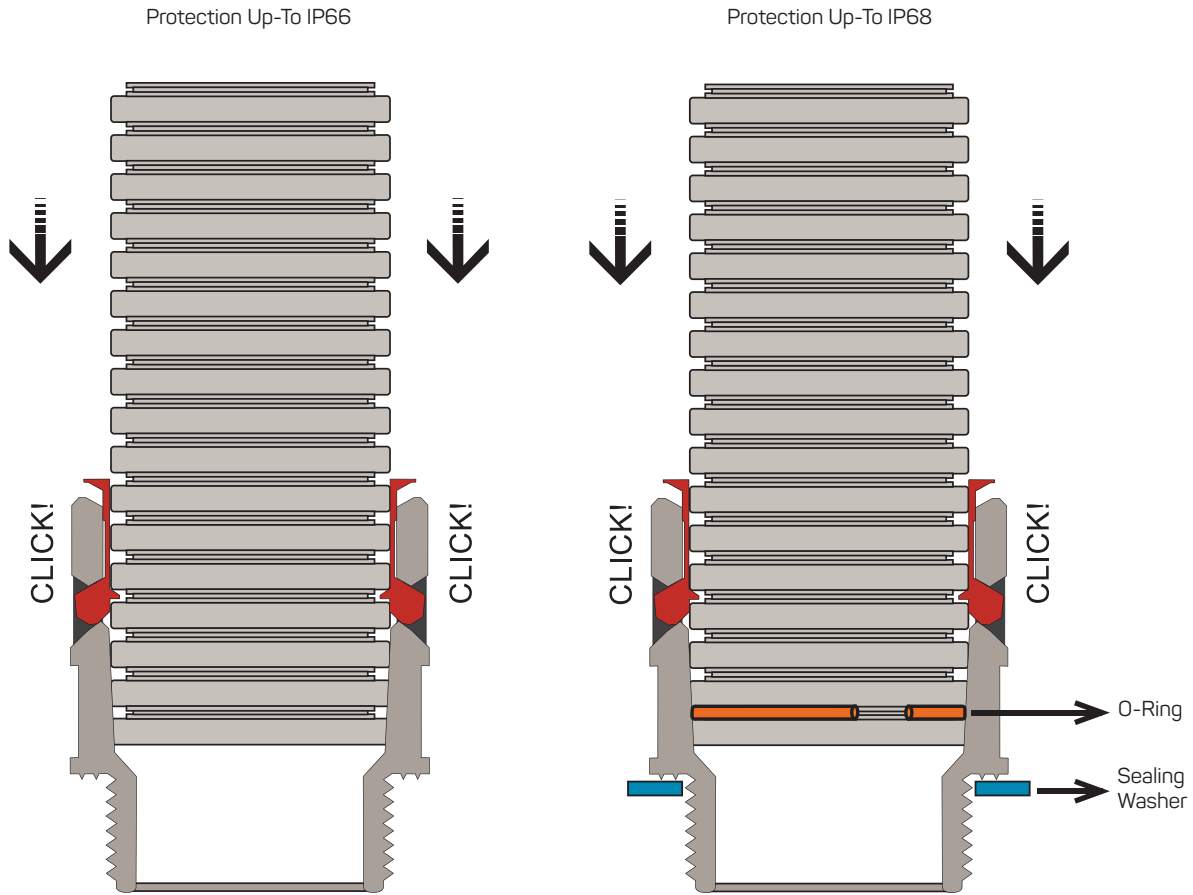

IP66



With the connector alone

IP68

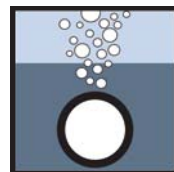

IP69



With the connector combined with an O-Ring and Sealing Washer

APPENDIX

CONDUIT CUTTING INSTRUCTIONS

CUTTING ANAMET SEALTITE® CONDUITS

IMPORTANCE OF CLEAN, SQUARE CUT:

- Easier connector attachment
- Conduit makes full contact with base of liquid-tight connector
- Gives greater holding power to connector
- Assures a liquid-tight assembly throughout

CUTTING SEALTITE® CONDUIT WITH METALLIC CORE:

Cut SEALTITE® square using a sharp saw to avoid excessive burns. SEALTITE® is sequentially marked at meter or foot intervals for easy measuring.

Hack saw: Suggest blade having 32 teeth per inch.

Band Saw: Suggest blade 1/2" wide x 0.025" thick having 24 teeth per inch, no set. Blade speed should be approximately 350 feet per minute.

Do NOT use abrasive wheel

CAUTION: GROUND CONDUCTOR REQUIRED. DO NOT HANDLE BELOW -25°C

HAND CUTTING SEALTITE® NON-METALLIC CONDUIT:

Square clean cuts are important for effective assembly with electrical connectors. Type B conduit is sequentially marked at meter intervals for easy measuring.

SEALTITE® CNP and NMUA conduit can be cut most easily with a sharpened 'parrot-shaped' electrical cable slicer.

Good clean cuts can also be made with a sharp shoe knife. A little liquid detergent used to 'wet' the knife blade will reduce frictional drag appreciably.

Cutting the conduit with a saw is not recommended.

CAUTION: GROUND CONDUCTOR REQUIRED. DO NOT HANDLE BELOW -18°C

HAND CUTTING ALUMINUM FLEX:

Putting electrical tape around the point to cut will avoid conduit from un-winding during the cutting process.

Cut in the center of the tape, using a hacksaw, 32 teeth per inch, no set. This can be done in the Benfield Saw Box for a more square cut.

BENFIELD SAW BOX: (OPTIONAL)

The Benfield Saw Box is a metal jig designed for easy clean cutting of Anaconda SEALTITE® flexible liquid-tight conduit

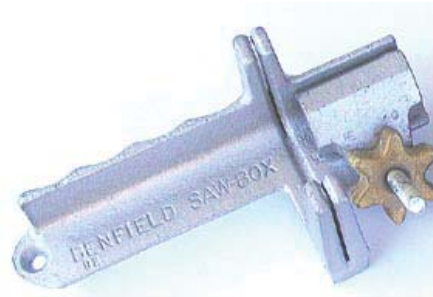

FEATURES OF JIG:

- Gives a clean-square cut (hacksaw blade having 32 teeth per inch - no set - recommended)
- Portable
- Easy to use
- Can be held in vise attached to bench



SEALTITE® CSA, CW and HTC is packaged in shrink wrap up to 1-1/2" and boxes 2" and above. Other SEALTITE® types are packaged in boxes for all trade sizes

APPENDIX

CHEMICAL RESISTANCE

The following chart gives a guideline of chemical resistance of PVC jacketed conduits.

Rating System:

1 - Excellent 2 - Good 3 - Fair 4 - Poor

Chemical	Resistance	Chemical	Resistance	Chemical	Resistance
Acetate Solvents	4	Creosote	4	Methyl Acetate	4
Acetic Acid (10%)	2	Cresol	3	Methyl Alcohol	3
Acetic Acid (Glacial)	3	Cresylic Acid	4	Methyl Bromide	4
Acetone	4	Cyclohexane	2	Methyl Ethyl Ketone	4
Acrylonitrile	1	DDT Weed Killer	1	Methylene Chloride	4
Alcohols (Aliphatic)	3	Dibutyl Phthalate	4	Mineral Oil	1
Aluminum Chloride	1	Diesel Oils	3	Monochlorobenzene	4
Aluminum Sulfate (Alums)	1	Diethylene Glycol	2	Muriatic Acid (see Hydrochloric Acid)	-
Ammonia (Anhydrous Liquids)	4	Diethyl Ether	1	Naphtha	3
Ammonia (Aqueous)	1	Di-isodecyl Phthalate	4	Naphthalene	4
Ammoniated Latex	1	Dioctyl Phthalate	4	Nitric Acid (10%)	1
Ammonium Chloride	1	Dow General Weed Killer (Phenol)	4	Nitric Acid (35%)	1
Ammonium Hydroxide	1	Dow General Weed Killer(H ₂ O)	2	Nitric Acid (70%)	4
Amyl Acetate	4	Ethyl Alcohol	3	Oleic Acid	1
Aniline Oils	4	Ethylene Dichloride	4	Oleum	4
Aromatic Hydrocarbons	4	Ethylene Glycol	2	Oxalic Acid	1
Asphalt	4	Ferric Chloride	1	Pentachlorophenol in Oil	2
ASTM Fuel A	3	Ferric Sulphate	1	Pentane	3
ASTM Fuel B	4	Ferrous Chloride	1	Perchloroethylene	4
ASTM #1 Oil	2	Ferrous Sulphate	1	Petroleum Ether	3
ASTM #3 Oil	3	Formaldehyde	4	Phenol	2
Barium Chloride	1	Fuel Oil	2	Phosphoric Acid (85%)	1
Barium Sulphide	1	Furfural	3	Pitch	2
Barium Hydroxide	1	Gallic Acid	1	Potassium Hydroxide	1
Benzene (Benzol)	4	Gasoline (Hi test)	3	Propyl Alcohol	2
Benzine (Petroleum Ether)	3	Glycerine	1	Ritchfield "A" Weed Killer	3
Black Liquor	1	Grease	1	Sea Water	1
Bordeaux Mixture	1	Green Sulphate Liquor	1	Sodium Hydroxide (10%)	1
Boric Acid	1	Heptachlor in Petroleum Solvents	1	Sodium Hydroxide (50%)	1
Butyl Acetate	4	Heptane	3	Soybean Oil	3
Butyl Alcohol	2	Hexane	3	Sodium Cyanide	1
Calcium Hydroxide	1	Hydrobromic Acid	1	Stoddard Solvent	4
Calcium Hypochloride	1	Hydrochloric Acid (10%O)	1	Styrene	4
Carbolic Acid (Phenol)	2	Hydrochloric Acid (40%)	3	Sulphur Dioxide (liquid)	4
Carbon Dioxide	1	Hydrochloric Acid (70%)	4	Sulphuric Acid (50%)	1
Carbon Disulphide	4	Hydrofluorobonic Acid	1	Sulphuric Acid (98%)	4
Carbon Tetrachloride	4	Hydrofluorosilicic Acid	1	Sulphurous Acid	2
Carbonic Acid	1	Hydrogen Peroxide (10%)	1	Tall Oil	4
Casein	1	Iso-octane	3	Tannic Acid	1
Caustic Soda	1	Isopropyl Acetate	4	Toluene	4
Chlorine Gas (wet)	4	Isopropyl Acetate	2	Trichlorethylene	4
Chlorine Gas (dry)	4	Jet Fuels (JP-3, 4 and 5)	3	Triethanol Amine	3
Chlorine (water solution)	3	Kerosene	3	Tricresyl Phosphate (Skydrol)	4
Chlorobenzene	4	Ketones	4	Turpentine	3
Chlorinated Hydrocarbons	4	Linseed Oil	1	Vinegar	1
Chromic Acid (10%)	2	Lubricating Oils	1	Vinyl Chloride	4
Citric Acid	1	Magnesium Chloride	1	Water	1
Coal Tar	4	Magnesium Hydroxide	1	White Liquor	1
Coconut Oil	3	Magnesium Sulphate	1	Xylene	4
Corn Oil	1	Malathion 50 in Aromatics	4	Zinc Chloride	1
Cottonseed Oil	3	Malic Acid	1	Zinc Sulphate	1



100 YEARS
OF FLEXIBLE
SAFETY

ANAMET CANADA INC.
36 WOLFE ST.
PO BOX 240
FRANKFORD, ON K0K 2C0

PHONE: (613) 398-1313
FAX: (613) 398-6262
ANAMETCANADA.COM
CSR@ANAMETCANADA.COM